

100  
0 10  
Millimetres

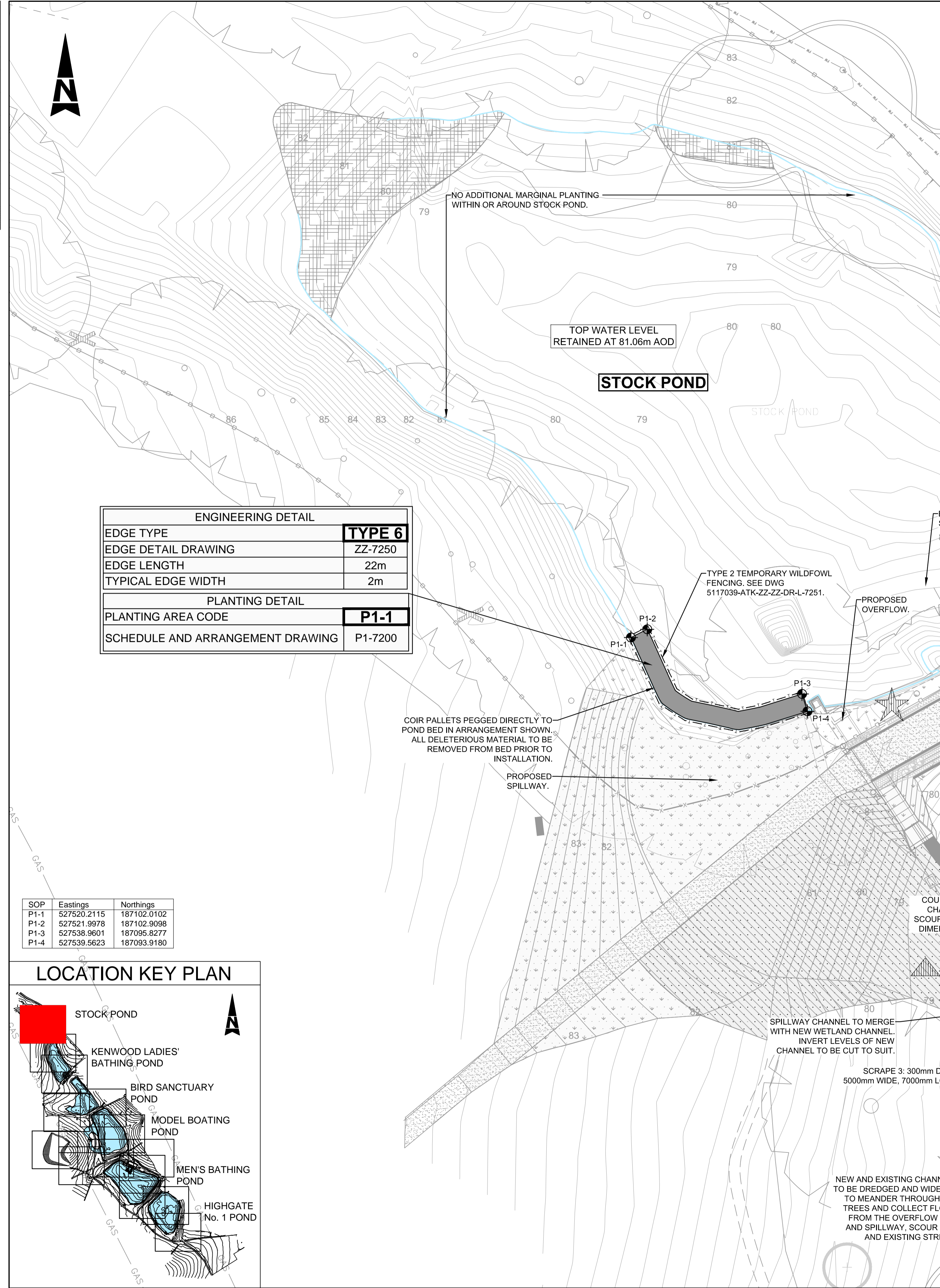

### P1-1 PLANTING SCHEDULE (COIR PALLETS)

Area Code	Installation Type	Description	Species	Number of 2x1m Pallets
P1-1	SP2	Single species pallet	Carex acutiformis	5
	SP3	Single species pallet	Iris pseudacorus	7
	SP4	Single species pallet	Lythrum salicaria	3
	MP1	Mixed species pallet	Lycopus europaeus Lythrum salicaria Mentha aquatica Iris pseudacorus Caltha palustris	4
	MP4	Mixed species pallet	Carex acutiformis Iris pseudacorus	3

### P1-1 COIR PALLET PLANTING ARRANGEMENT (TYPE 6 EDGE, BANK LENGTH = 22m)

SP3	SP3	MP1	MP4	MP4	MP1	MP1	MP4	SP4	MP1	SP3	↑ POND
SP2	SP3	SP2	SP4	SP2	SP2	SP4	SP3	SP3	SP2	SP3	↓ BANK

**KEY:**

- POND EDGE
- EXISTING POND VEGETATION
- PROPOSED POND PLANTING
- PROPOSED SHEET PILE EDGE
- CONTOURS (m AOD)
- EXISTING FENCE / RAILING
- INDICATIVE LOCATION OF EXISTING TREES
- PROPOSED WILDLOW FENCING
- PERMANENT WETLAND FENCING
- POST AND CHESTNUT RAIL FENCE WITH MESH
- JAPANESE KNOTWEED
- GIANT HOGWEED
- HIMALAYAN BALSAM

2- DETAIL NUMBER OR ELEVATION, SECTION LETTER.  
P2-7250 SHORTENED DRAWING NUMBER REFERENCE (5117039-ATK-P2-ZZ-DR-L-7250)

- NOTES:**
- ALL MEASUREMENTS IN MILLIMETRES UNLESS OTHERWISE STATED AND LEVELS IN METRES TO ABOVE ORDNANCE DATUM (AOD).
  - APPROXIMATE LOCATIONS OF JAPANESE KNOTWEED, HIMALAYAN BALSAM AND GIANT HOGWEED AS IDENTIFIED IN 2013 ARE SHOWN. FURTHER AREAS MAY BE ENCOUNTERED ON SITE.
  - TREES ON EDGE OF WORKS TO BE RETAINED AND PROTECTED IN ACCORDANCE WITH BRITISH STANDARDS (BS) 5837 WHERE SITE WORKS ALLOW.
  - THIS DRAWING IS TO BE READ IN CONJUNCTION WITH THE ARBOCULTURAL DRAWINGS, 5117039-ATK-2000 SERIES & ARBORICULTURAL METHOD STATEMENT 5117039-ATK-ZZ-SP-L-005.
  - THIS DRAWING TO BE READ IN CONJUNCTION WITH LANDSCAPE DRAWINGS 5117039-ATK 7100, 7300 & 7500 SERIES.
  - THIS DRAWING TO BE READ IN CONJUNCTION WITH M&E DRAWINGS 5117039-ATK 7000 SERIES.
  - THIS DRAWING TO BE READ IN CONJUNCTION WITH ENGINEERING DRAWINGS 5117039-ATK 0000 AND 1000 SERIES.
  - THIS DRAWING TO BE READ IN CONJUNCTION WITH BUILDING SERVICES DRAWINGS 5117039-ATK 8000 SERIES.
  - REFER TO STANDARD POND AND POND SPECIFIC DETAIL DRAWINGS 5117039-ATK 7250 SERIES.
  - POND EDGE LEVELS VARY, AS DO DEPTHS OF SEDIMENT AND DEPTHS TO SOFT AND HARD BED.
  - TYPICAL TOP WATER LEVELS ARE SHOWN ON THE DRAWINGS.
  - SEE SPECIFICATION APPENDIX ON POND RESTORATION AND PLANTING FOR FURTHER INFORMATION ON MATERIALS, DESIGN, PLANT AND PLANTING REQUIREMENT.
  - ALL PLANTING ARRANGEMENTS REFER TO 2m x 1m AREAS AS INDIVIDUAL BLOCKS. THE TOP ROW REPRESENTS THE POND WARD PLANTING, WHILST THE BOTTOM ROW REPRESENTS THE BANK EDGE PLANTING. ALL ARRANGEMENT ARE ORIENTED LOOKING FROM THE BANK INTO THE POND.
  - FENCING TO BE INSTALLED TO ENCLOSE ALL NEWLY PLANTED MARGINAL AREAS SEE DWG 5117039-ATK-ZZ-DR-L-7251. TYPE 2 FENCE VARIANT TO BE USED ON ALL TEMPORARY SPILLWAY FENCING.
  - WETLAND PLANTING SHOULD NOT BE INSTALLED DURING PERIODS WHERE LEVELS ARE RISING RAPIDLY ABOVE TOP WATER LEVEL.
  - SEE DRAWING 5117039-ATK-P2-ZZ-DR-L-7250 FOR CHANNEL AND SCRAPE DETAILS.

ENGINEERING DETAIL	
EDGE TYPE	<b>TYPE 6</b>
EDGE DETAIL DRAWING	ZZ-7250
EDGE LENGTH	22m
TYPICAL EDGE WIDTH	2m
PLANTING DETAIL	
PLANTING AREA CODE	<b>P1-1</b>
SCHEDULE AND ARRANGEMENT DRAWING	P1-7200

### SAFETY, HEALTH AND ENVIRONMENTAL INFORMATION

In addition to the hazards/risks normally associated with the types of work detailed on this drawing, note the following:

### CONSTRUCTION

- POND WATER LEVEL MAY RISE RAPIDLY DURING AND AFTER RAINFALL.
- WATER LEVELS MAY RISE RAPIDLY DURING AND AFTER RAINFALL IN THE EXISTING CHANNELS OR NEWLY CREATED WETLAND CHANNELS AND SCRAPES DOWNSTREAM OF STOCK POND.
- SOFT GROUND CONDITIONS ARE LIKELY TO BE ENCOUNTERED IN PROXIMITY TO WORKING AREA REQUIRED TO CREATE THE WETLAND CHANNEL AND SCRAPES.

### MAINTENANCE/CLEANING

- CARE SHOULD BE TAKEN NOT TO DAMAGE WETLAND PLANTING WHILST UNDERTAKING ROUTINE MAINTENANCE E.G. WEEDING OF DELETERIOUS SPECIES AND LITTER REMOVAL.
- SILT DISPOSAL FROM WETLAND CHANNELS, SCRAPES AND BEHIND CHECK DAMS SHOULD BE TO AREAS WHERE THE RISK OF INGRESS TO PONDS/STREAMS AND HARM TO THE LOCAL ENVIRONMENT IS REDUCED.

### DECOMMISSIONING/DEMOLITION

- CARE SHOULD BE TAKEN NOT TO DAMAGE ANY PLANTS WHEN REMOVING TEMPORARY FENCING.
- OPTIONS FOR THE REUSE OF TEMPORARY FENCING MATERIALS ELSEWHERE ON SITE SHOULD BE EXPLORED.

It is assumed that all works will be carried out by a competent contractor working, where appropriate, to an approved method statement



Rev.	Date	Description	By	Chk'd	App'd
C1	13/02/2014	FOR CONSTRUCTION	JK	IPM	MJV
P2	21/10/2014	FOR COSTING, ISSUED SUBJECT TO FINAL REVIEW BY PANEL ENGINEER	JA	IMM	MW
P1	01/10/2014	FOR COSTING	IF	IMM	MW

FOR CONSTRUCTION **A**

**ATKINS**

Woodcote Grove  
Ashley Road  
Epsom  
Surrey  
KT18 5BW

Tel: +44 (0)1372 726140  
Fax: +44 (0)1372 740055  
www.atkinsglobal.com

Copyright © Atkins Limited (2013)

Client  
**City of London Corporation**

Project Title  
**HAMPSTEAD HEATH PONDS PROJECT**

Drawing Title  
**STOCK POND RESTORATION  
GENERAL ARRANGEMENT  
SHEET 1 OF 1**

Scale	Designed	Drawn	Checked	Authorised
1:250	MV	IF	MV	MW
Original Size	Date	Date	Date	Date
A1	03/09/14	03/09/14	03/09/14	03/09/14
Drawing Number	Revision			
5117039-ATK-P1-ZZ-DR-L-7200	C1			

SOP	Eastings	Northings
P1-1	527520.2115	187102.0102
P1-2	527521.9978	187102.9098
P1-3	527538.9601	187095.8277
P1-4	527539.5623	187093.9180

### LOCATION KEY PLAN

