

FOR PLANNING APPLICATION PURPOSES ONLY
This drawing has been produced for Duffry Investment Corporation a project named as '6 Erskine Road' and is submitted as part of a planning application relating to the site name only and is not intended for use by any other person or organisation or for any other purpose.
© PKS Architects LLP
Dec 2011

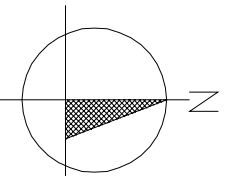
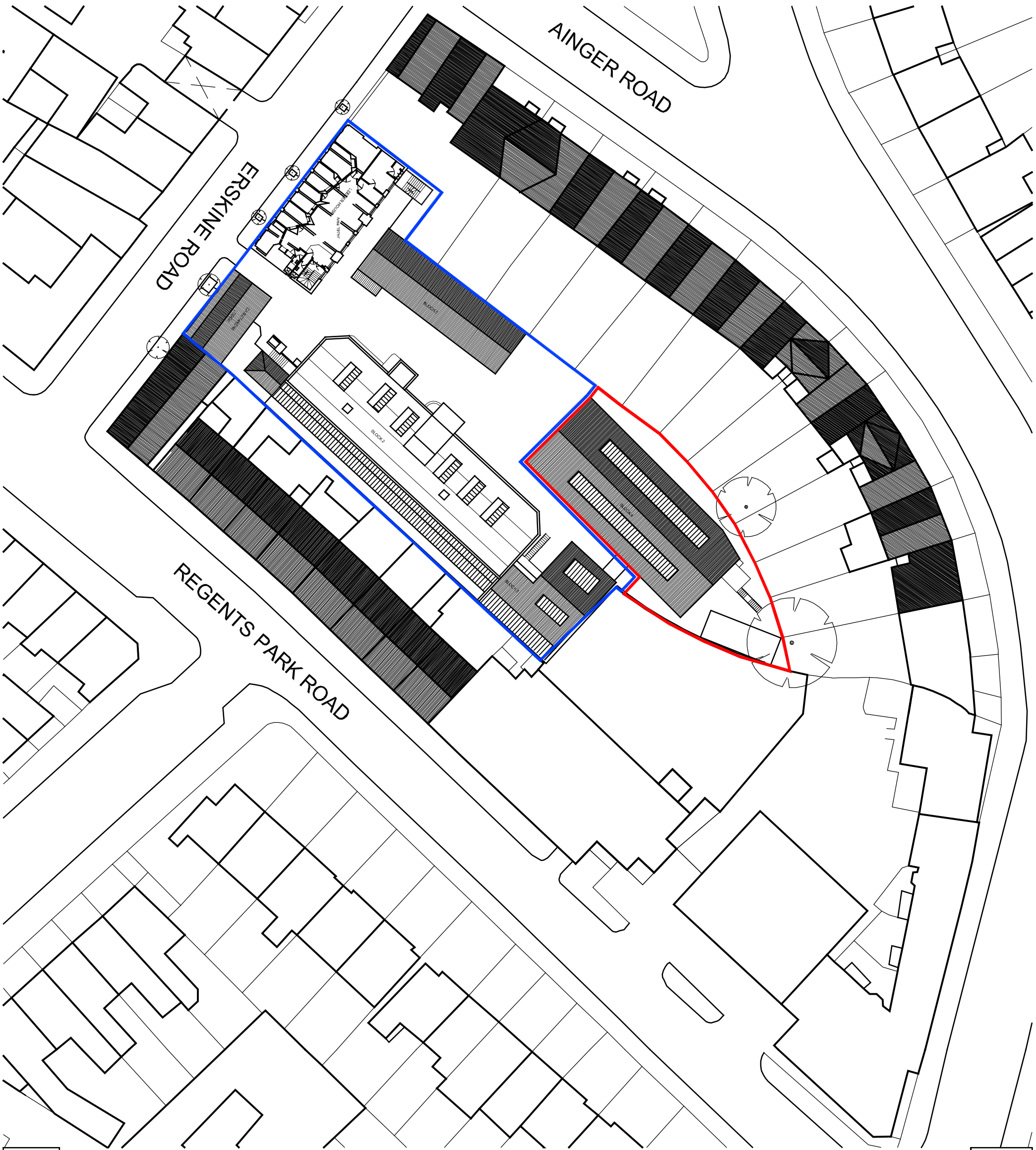

SCALE
PLANNING

© PKS Architects LLP 10 Darnley House Studios, Greenwood Place, London, NW15 1LR. T: 020 7624 4800. F: 020 7624 4801. e: pks@pkсарchitects.com

PKS architects	
Project:	6 Erskine Road
Site:	Site Location Plan
Scale:	1:500 @ A3
Date:	05/10/11
Author:	GLJ
Check:	772B
Drawn by:	000-10
Rev:	-