

Notes:
THE SIZES ARE PROVISIONAL AS SURVEY WAS NON-INTRUSIVE DUE TO LOOSE ROCKWALL FIBRES

EXISTIVE TRACE HEATING TO BE CAREFULLY REMOVED, MODIFIED & TESTED TO SUIT THE NEW CHILLER PIPEWORK CONNECTION ARRANGEMENTS

NEW CHILLER PIPE CONNECTIONS TO INCORPORATE FLUSHING BYPASS, ISOLATION VALVES, COMMISSIONING VALVES, FLEXIBLE CONNECTION BINDER TEST POINT, PRESSURE & TEMPERATURE GAUGES

EXISTING CHILLER WATER SYSTEM MICROFIL UNIT TO BE DECOMMISSIONED, MADE SAFE, REMOVED AND SERVICES DISCONNECTED/CAPPED AS APPROPRIATE

NEW INVERTER CHILLED WATER PUMP SET, WITH CONNECTING PIPEWORK, FLEXIBLE BINDER GAUGES AND NEW PRESSURE & TEMPERATURE GAUGES

NEW CHILLED WATER PACKAGED PRESSURISATION UNIT WITH CONNECTING PIPEWORK, POWER & BMS INTERCONNECTING WIRING - HOUSED IN ACCESSIBLE WEATHER PROOF ENCLOSURE

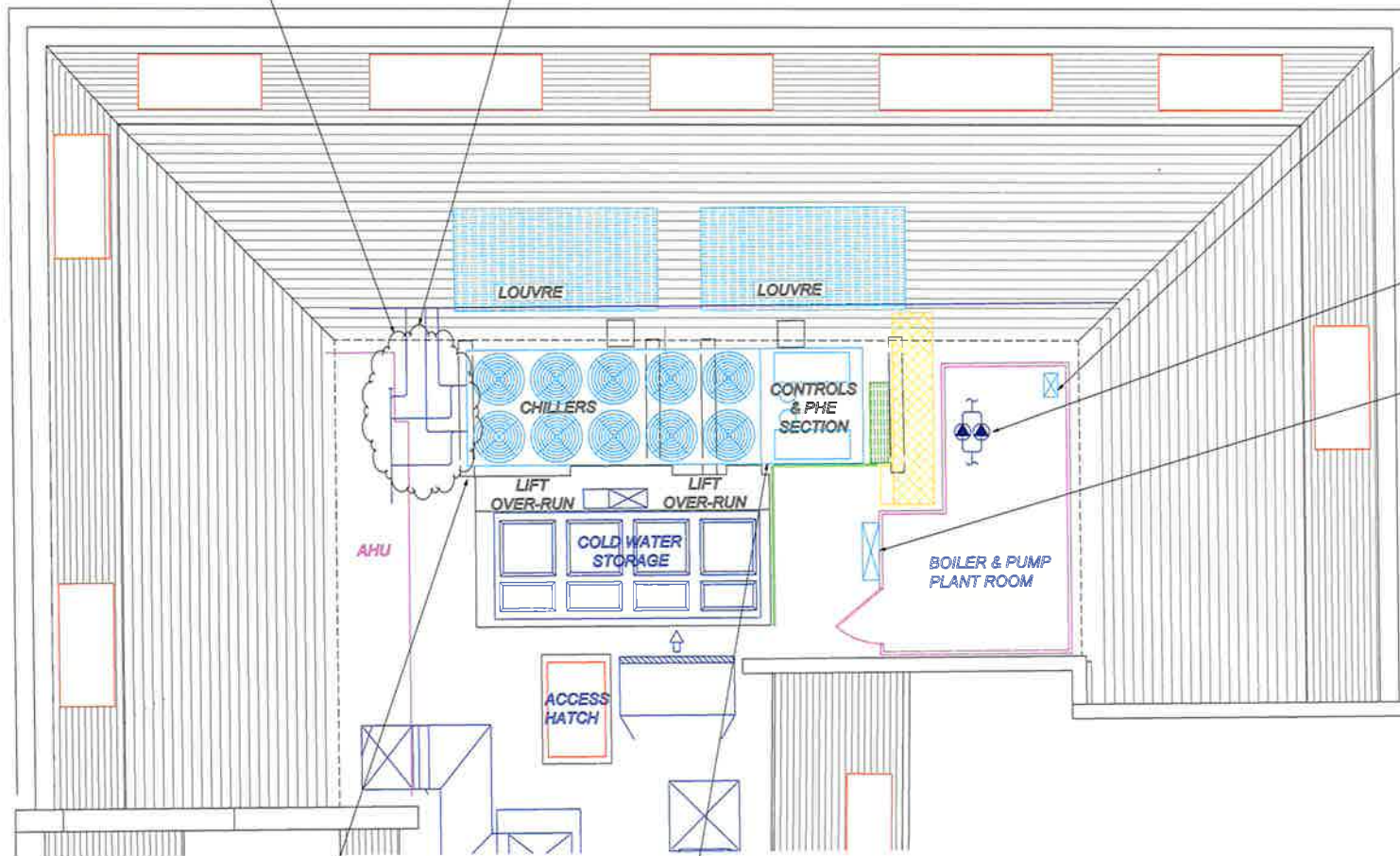

EXISTING WATER SERVICES, ELECTRONICS & TV AERIALS/MASTS TO BE RELOCATED BY CONTRACTOR TO ENABLE REMOVAL OF EXISTING OLD CHILLER & INSTALLATION OF NEW

NEW AIR COOLED PACKAGED CHILLER UNIT TO NEW SPECIFICATION

PRELIMINARY FOR CLIENT APPROVAL

Rev	Issued For	Date
 UNITED <small>HEATING, VENTILATION & AIR-CONDITIONING</small> <i>Heating, Ventilation, Air-Conditioning, Electrical, Building & Storage Services.</i>		
<small>Head Office</small> Suite 4, The Sanctuary, Single View Farm, Domes Road, London, Essex, SS15 4DB Telephone: 01208 548346 or 01708 866001/2 Fax: 01708 866003 E-mail: info@unitedhva.com - web: www.unitedhva.com		
		
<small>Client:</small> WEDLAKE BELL SOLICITORS		
<small>Job Title:</small> 52 BEDFORD ROAD, LONDON WC1R 4LR PROPOSED CHILLER REPLACEMENT PROJECT AND ASSOCIATED ENABLING WORKS		
<small>Draw Title:</small> ROOF LAYOUT MECHANICAL SERVICES DRAWING		
<small>Drawn:</small>	<small>Checked:</small>	
WDR	RP	
<small>Scale:</small>	<small>Date:</small>	
MTS @ AI	JULY 2013	
<small>Draw No:</small>	LPM/0320/PP/CRS/RPL/06/PP	

