

Basement Floor Plan
Area: 55.5m²

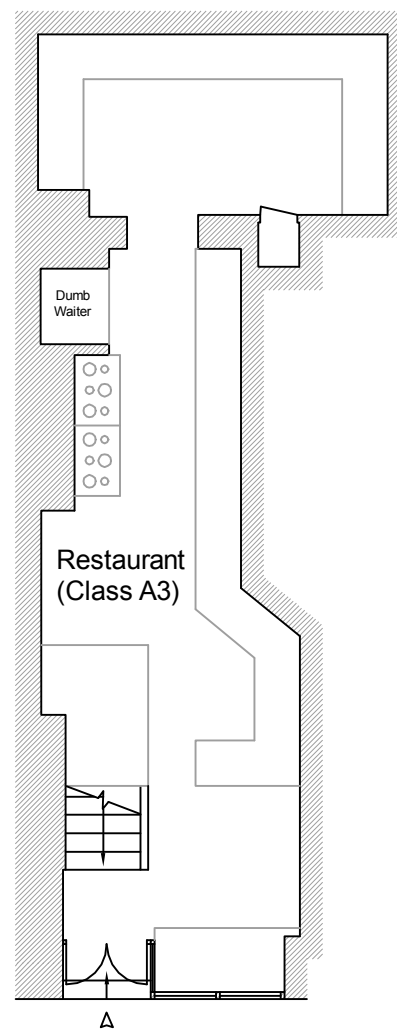

Ground Floor
Area: 39.2m²

DRAWING TITLE	
Basement & Ground Floor Plans As Existing	
ADDRESS	
31 Neal Street, London WC2H	
PROJECT NAME	DATE
Certificate of Lawfulness	Feb' 2015
	SCALE
	1:100 @ A4
CLIENT	DRAWING NO.
Shaftesbury Covent Garden Ltd	21915-CoL
1 SANDWICH STREET LONDON WC1H 9PF	
Tel: (020) 7391 7100 Fax: (020) 7391 7121	