

1. Commence temporary works
(Section A-A)

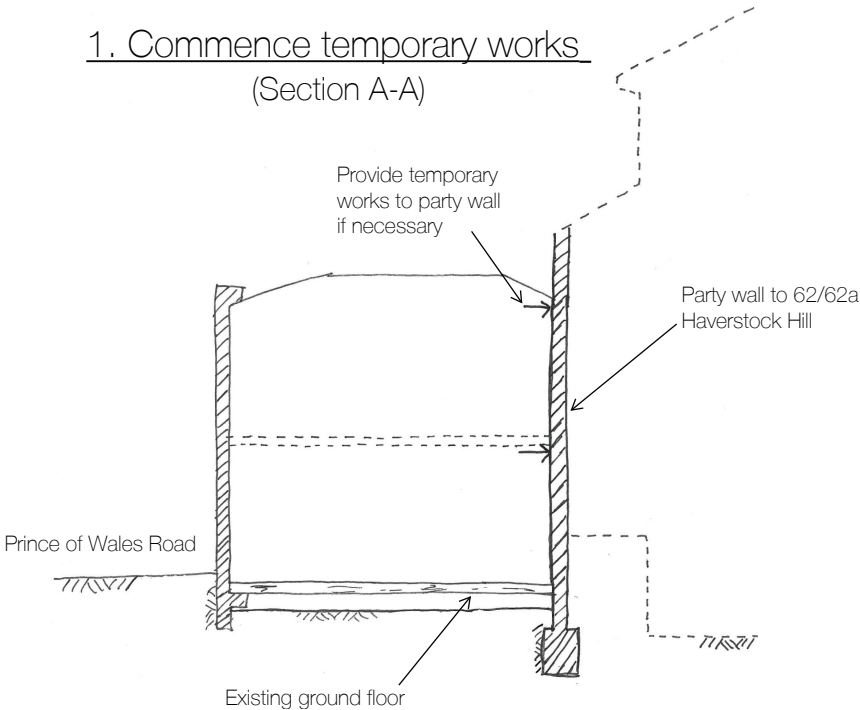

2. Demolish existing building completely
(Section A-A)

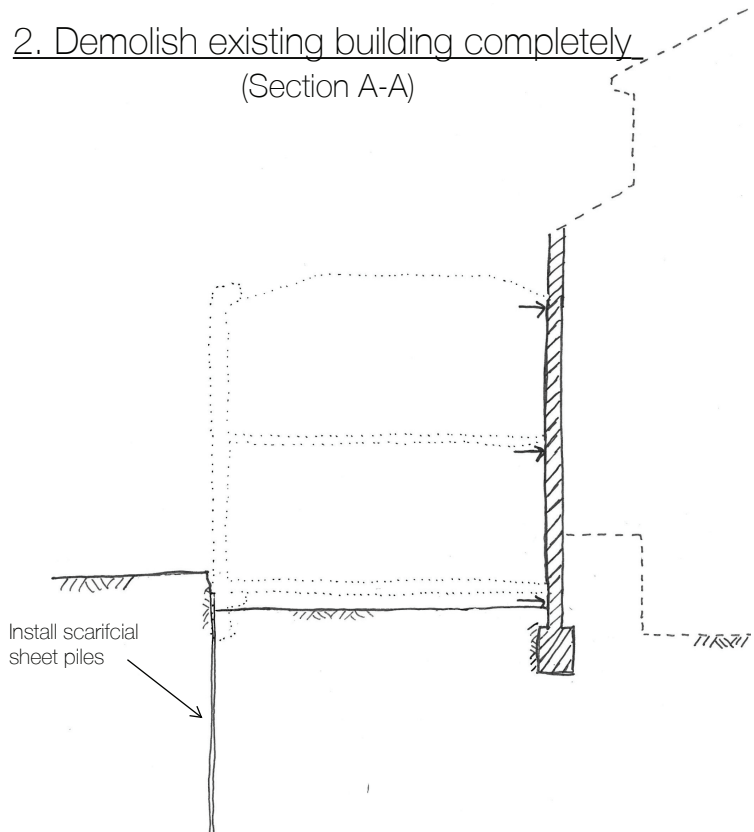

3. Commence Excavation along party wall
(Section A-A)

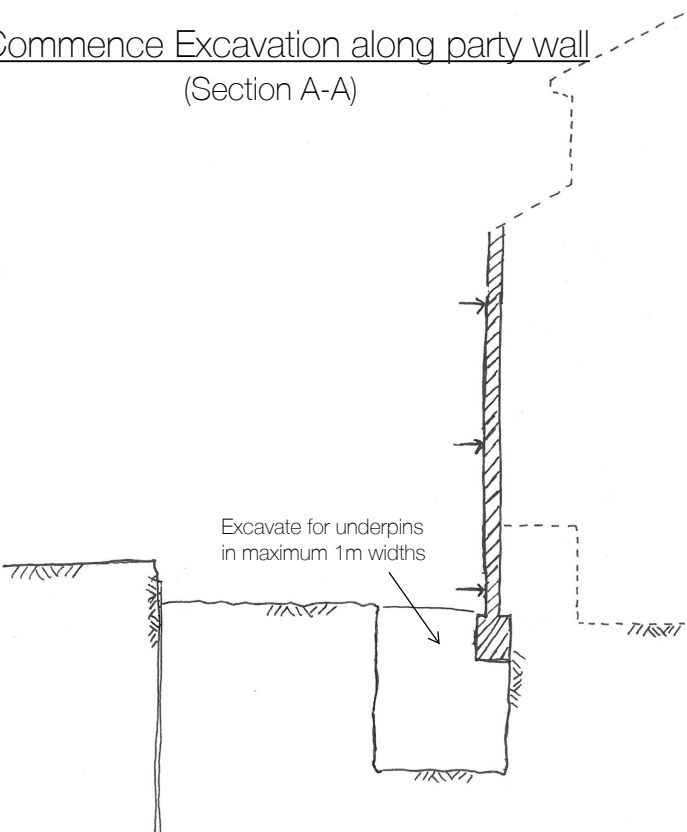

4. Construct underpins to party wall
(Section A-A)

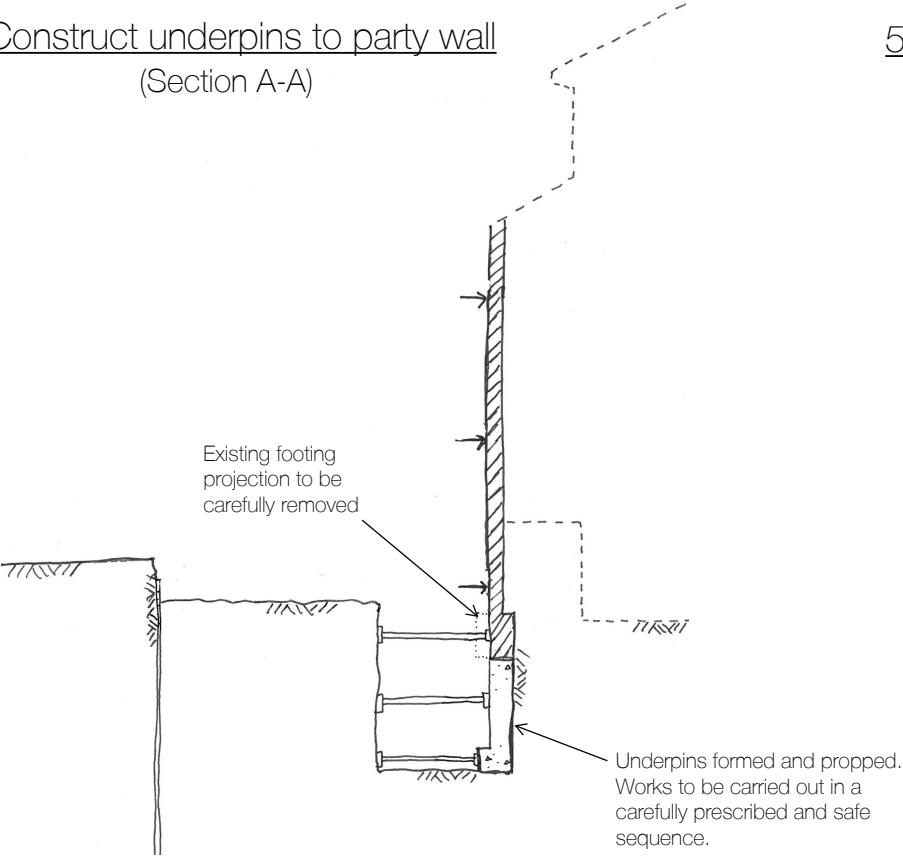

5. Continue excavation to form basement
(Section A-A)

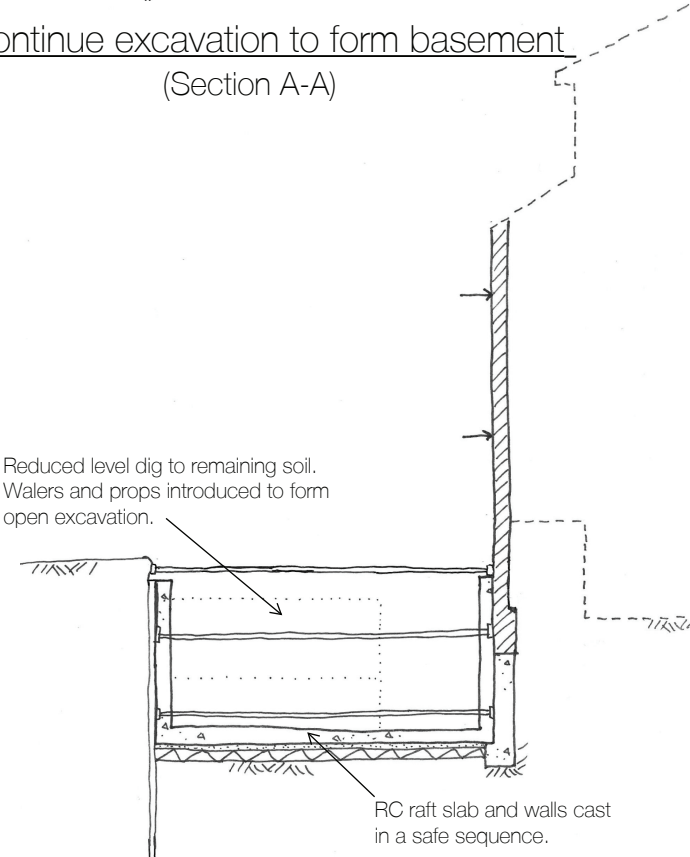

6. Complete the new RC structure
(Section A-A)

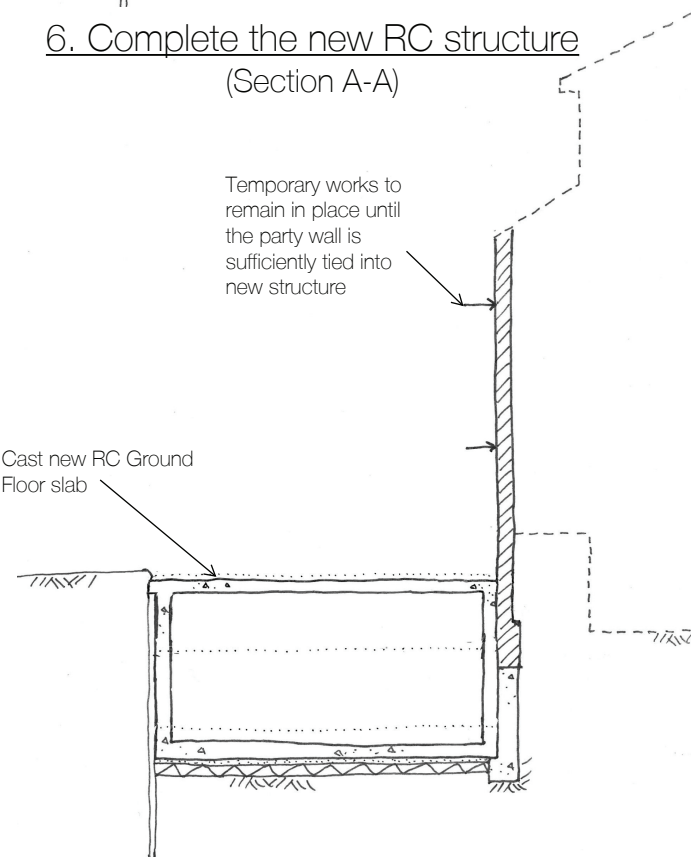

Assumed Sequence of Construction of Basement