

Copyright in the design and this drawing is the property of 51% Studios Limited. Reproduction in whole or in part is forbidden without written permission of 51% Studios Limited.

All Dimensions are to be checked on site before any work proceeds. Do not scale this drawing but use only figured dimensions. Any errors or omissions are to be reported to 51%.

The contractor shall submit full size drawings and specifications to 51% for approval, without which, manufacture shall not commence.

This drawing is to be read in conjunction with all the relevant consultants' and / or specialists' drawings/documents, and any discrepancies or variations are to be notified to 51% before work commences.

For further information please see other drawings and documents enclosed with this drawing.

For information on structure use engineer's drawings.

For further information on services use engineer's and/or contractor's drawings.

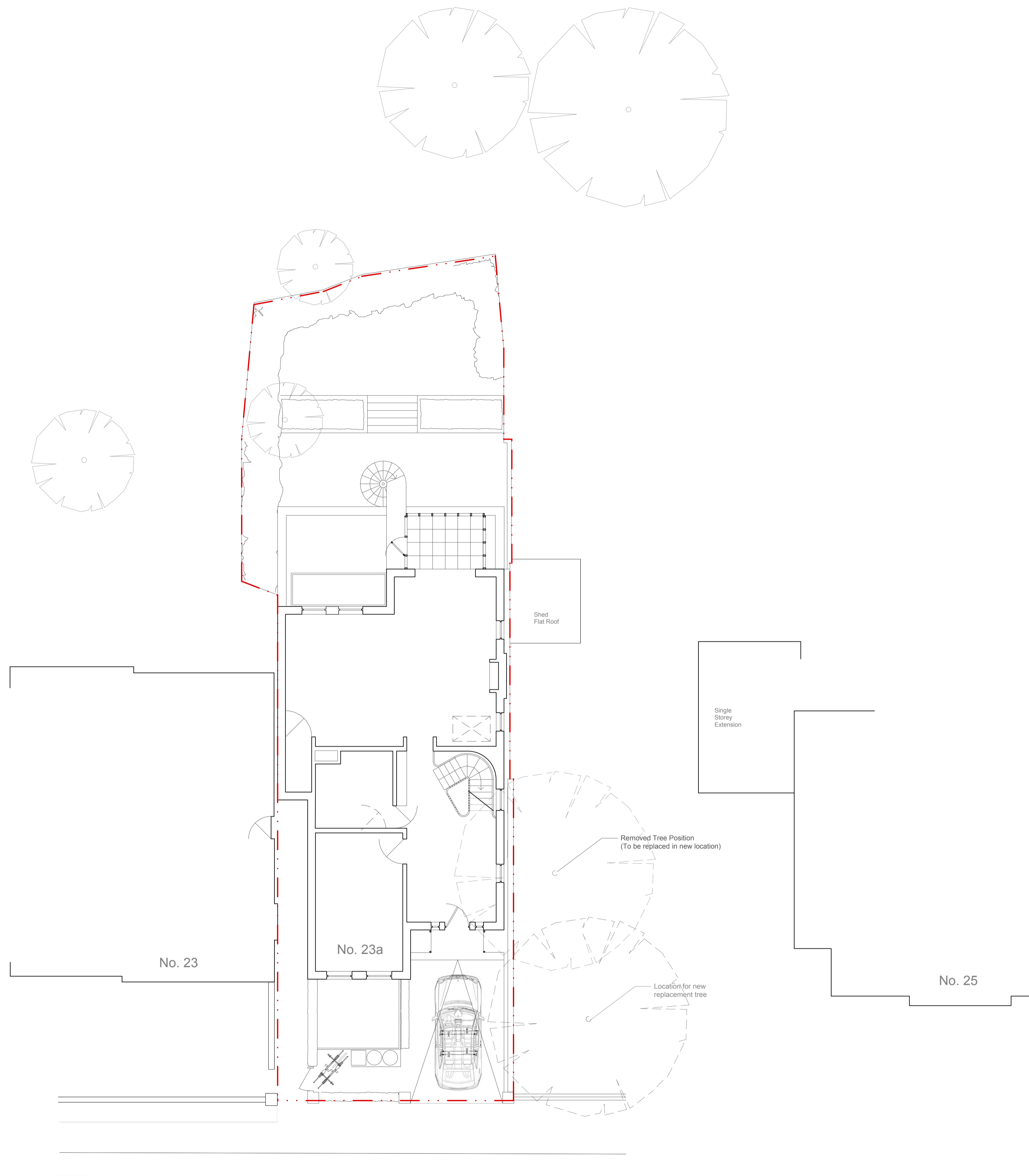

NOTES

No.	Date	Checked	Revision Notes
F	10/2/15		Issued for Planning

No.	Date	Issue Notes

51%

1a Cobham Mews . London NW1 1SB
t. 44 [0] 8456 123 911 f. 44 [0] 8456 123 998 www.51pct.com

Project
23a Hampstead Hill Gardens

Client
**Kination Capital BVI Limited
87 Wimpole Street
London
W1G 9RL**

Status
Issued for Planning

Drawing
Proposed Site Plan

Project Architect 51% studios	Project ID 1104
Drawn By AI	Scale 1:50 @ A1
Checked By 51% studios	Drawing No. 1001
Date October 2010	Revision F
File Name	

