

No 124

EXISTING ROOF

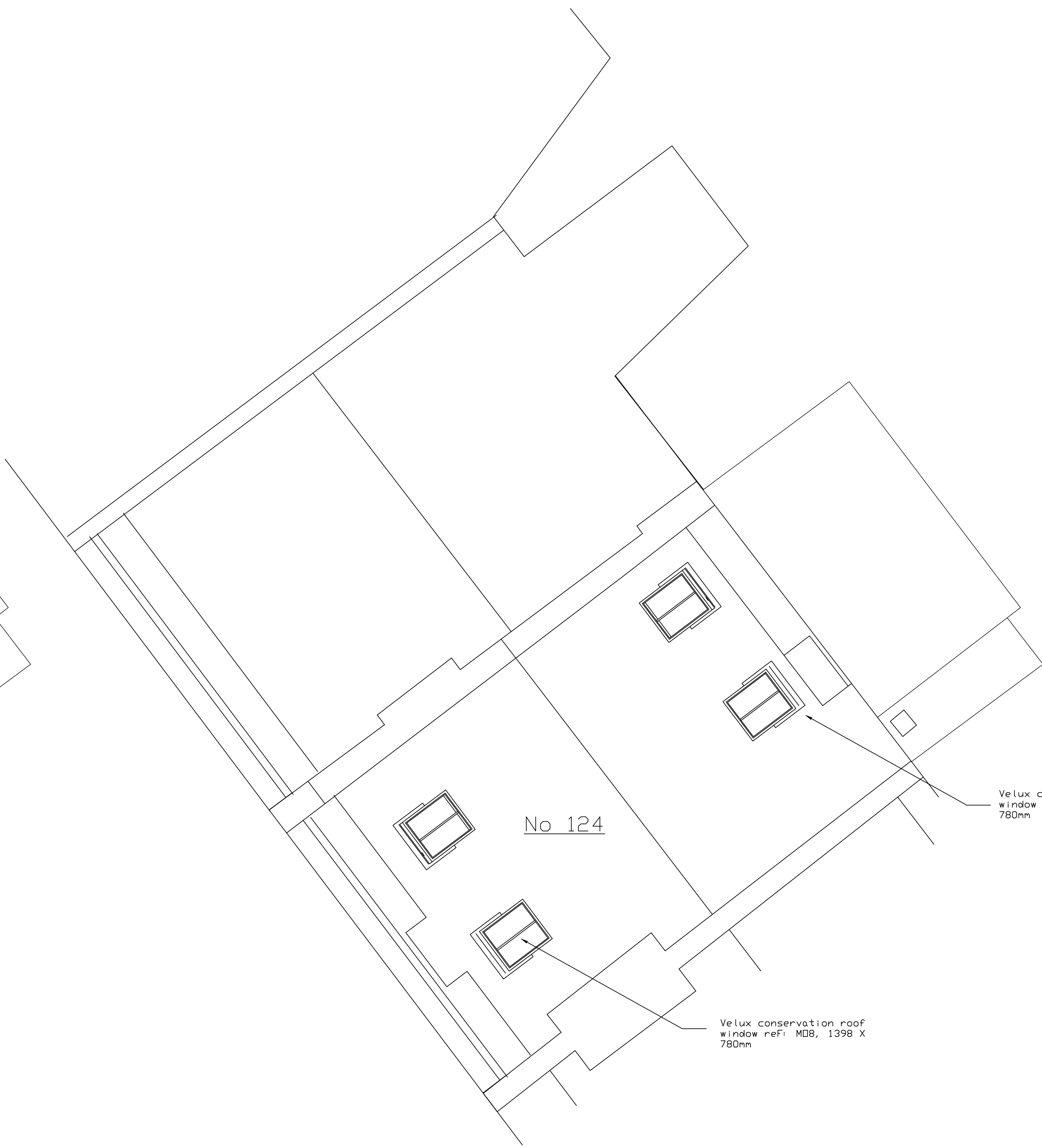

No 124

PROPOSED ROOF

Velux conservation roof
window ref: MDB, 1398 X
780mm

Velux conservation roof
window ref: MDB, 1398 X
780mm

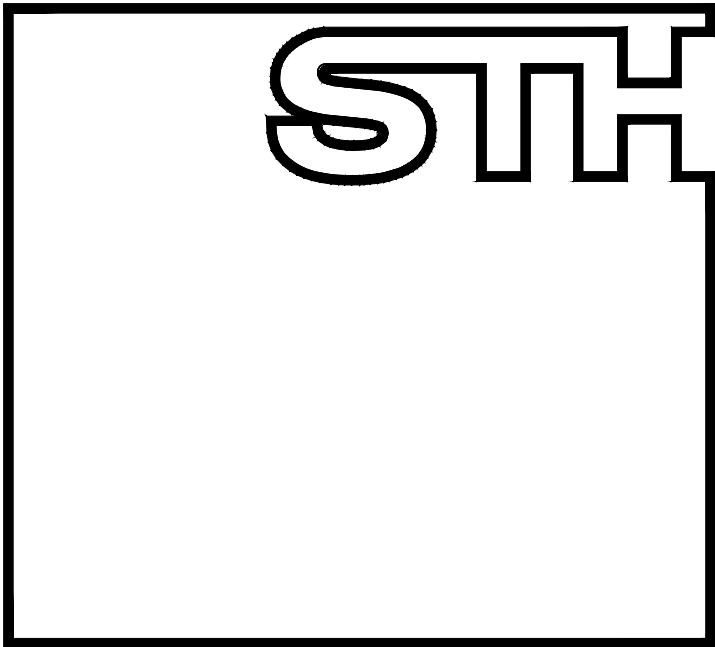

SIMMONS TAYLOR HALL

CHARTERED BUILDING SURVEYORS
ARCHITECTURAL DESIGN CONSULTANTS
48 Richmond Road
Kingston upon Thames
Surrey KT2 5EE
Telephone: 020 8541 4111
Fax: 020 8547 0847
email: team@simmonstaylorhall.co.uk

Client
MERLANDS INVESTMENTS Co Ltd

124 CLEVELAND STREET
LONDON
W1T 6PQ

PROPOSED REFURBISHMENT FLATS 1, 2 & 3.
FORMATION OF OFFICE AT FIRST FLOOR WITH NEW
WINDOWS & FLAT ROOF RAISED.
THIRD FLOOR FRONT WINDOW REPLACEMENT.
NEW VELUX TO FRONT & REAR ROOF.
REPLACEMENT OF REAR STAIR & FLAT 1 WINDOW.
REAR EXTERNAL REDECORATION.
EXISTING & PROPOSED ROOF PLAN

Scale	Client/Project No.	Rev.
1:50@A1	1223	
Date	Drawing No.	
JANUARY 2015	008	
Drawn		
PAS		

CAD REF:S:PAUL/DWGS/CLIENT