

**A** Existing Dining Room Elevation

Non-original fanlight over door

New fanlight over door (to match existing)

Area opened up as part of investigatory works for inspection by Structural Engineer - see Sinclair Johnston report dated May 2014 - and confirmed to be non-original

New double paneled doors and architrave to match existing

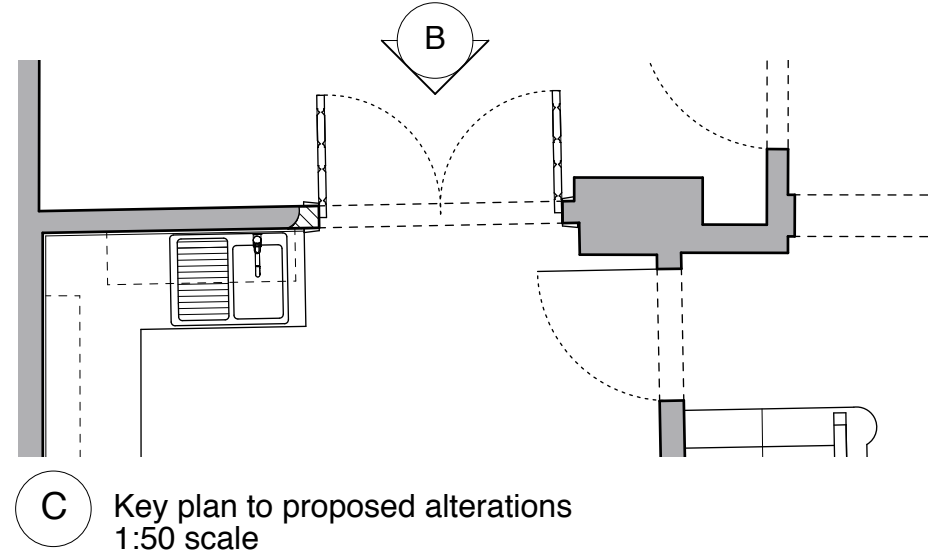

**C** Key plan to proposed alterations  
1:50 scale

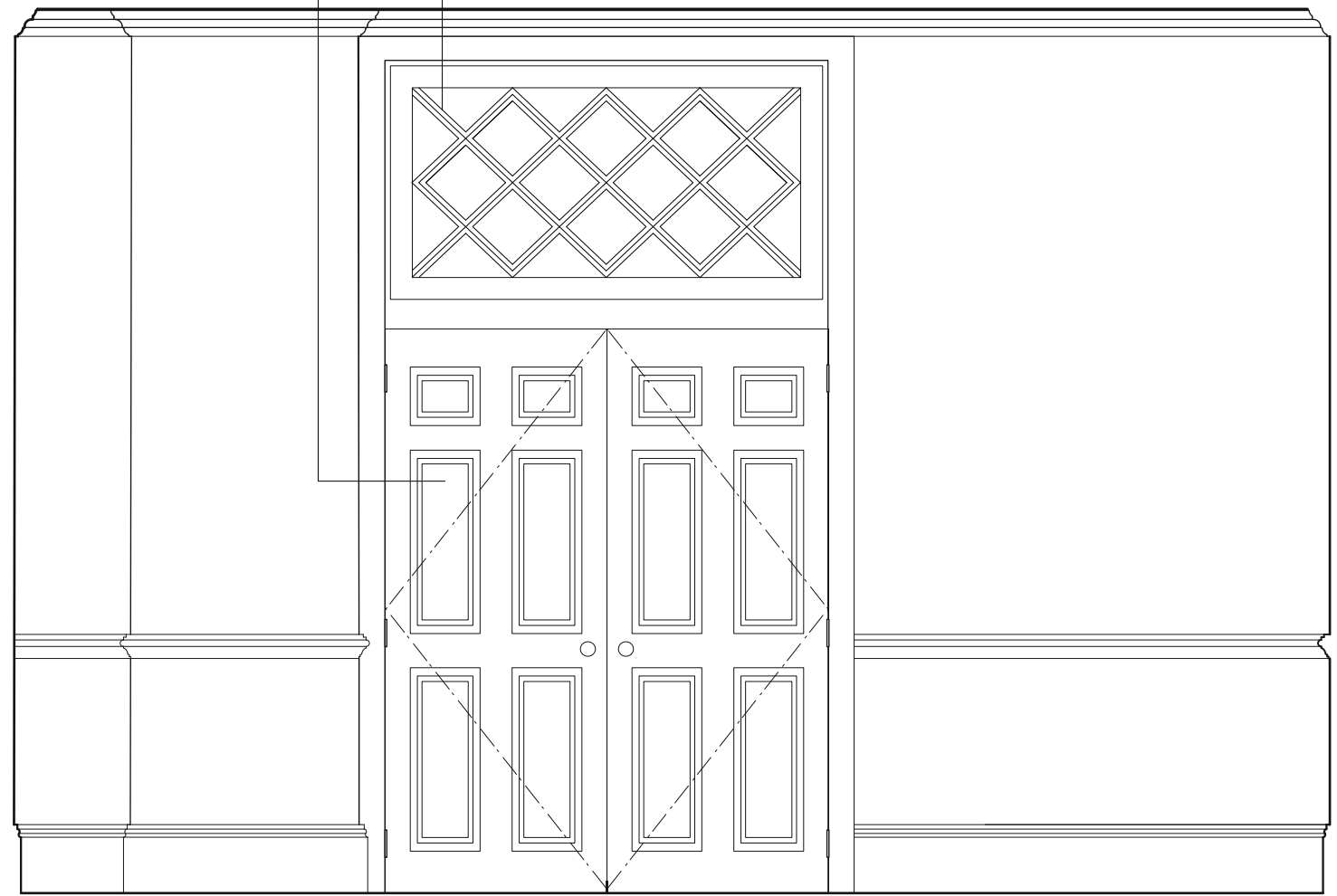

**B** Proposed Dining Room Elevation



**PITMAN TOZER  
ARCHITECTS**

117 Great Western Studios  
65 Alfred Road  
London W2 5EU

tel 020 3214 3255  
mail@pitmantozer.com  
www.pitmantozer.com

General Notes

1. This drawing remains copyright of Pitman Tozer Architects Limited and may not be reproduced or copied without consent in writing.
2. Do not scale drawing use figured dimensions only.
3. Any discrepancies between site and drawings to be reported to the architect immediately.
4. Read in conjunction with all relevant structural and mechanical & electrical engineers drawings.
5. Dimensions critical to proposed building works must be checked on site before building works commences, as certain assumptions have been made due to lack of accessibility and anomalies in the existing building.

Revisions

Other notes

Project Address  
8 Great Ormond Street  
London, WC1N 3RB

Drawing  
Existing and Proposed  
Dining Room Elevation

Drawing status  
For Statutory Consent

Date  
20.02.15

Scale  
1:25 @ A3

Drawing number  
1316/PL2-04

Revision