

Notes:

1. This drawing is for the purpose of Planning Application only. It is not to be used for construction.
2. Copyright of this drawing is the property of Francis Hur Architecture Ltd (FHA) and may not be reproduced without their permission.
3. Written dimensions to be used in preference to scaled dimensions at all times. Dimensions marked with +/- are indicatively approximate only. All dimensions and levels to be verified on site and any discrepancies to be reported to FHA.
4. Drawings are based on the assumption that adequate load bearing capacity stratum will be encountered at the depths indicated. If this is found not to be the case, the depths must be increased to the satisfaction of the building inspector and building regulation requirements.

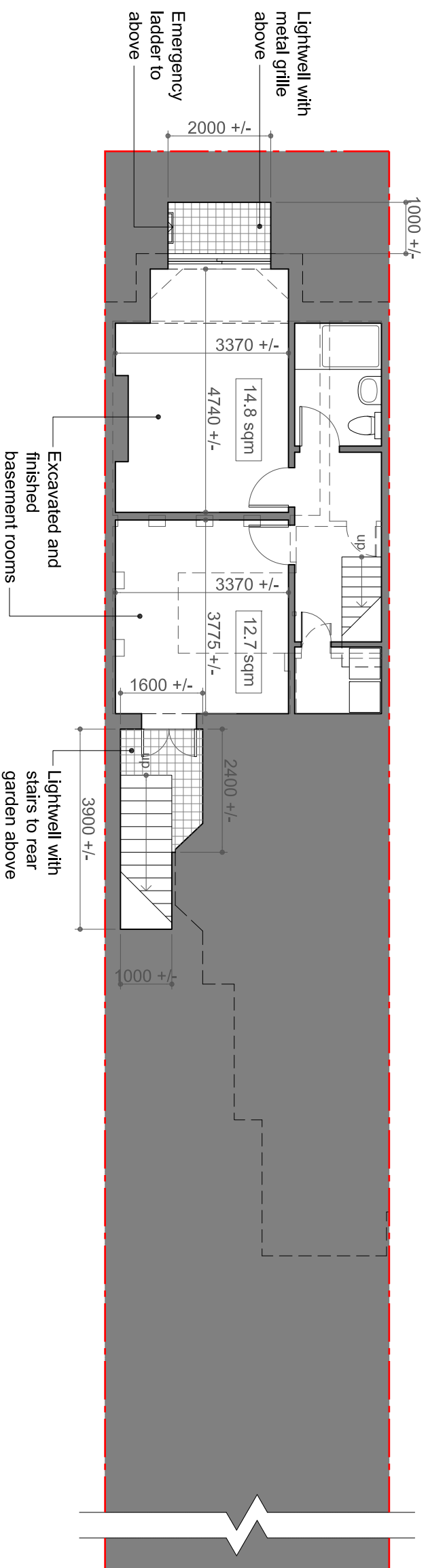

2 Basement Floor Plan - Proposed
Scale 1:100

Proposed Basement GIA:
41.8 sqm

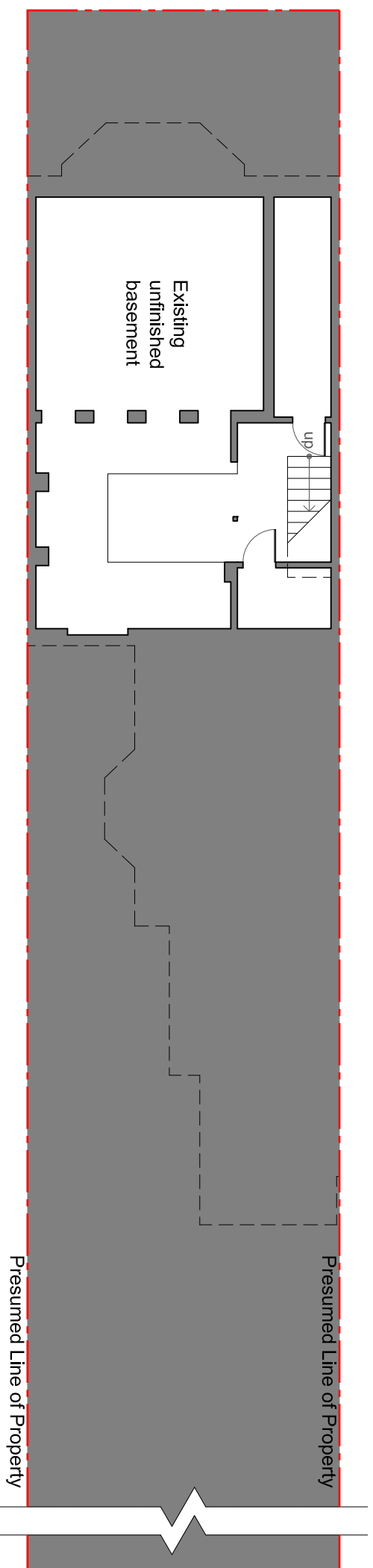

1 Basement Floor Plan - Existing
Scale 1:100

Existing Basement GIA:
13.7 sqm
(Based on floor area above 1.5m height)

Drawing Title:
Basement Floor Plan - Existing / Proposed

Project Address:
**Ground Floor Flat
6 Sumatra Road
London, NW6 1PU**

Status:
Planning Application

Rev:	Date:	Description:
1	9 Mar 15	Gross internal areas

Project no: 1413
Drawn by: FH
Date: 12 Nov 2014

Page size: A3
Page no: 2 of 9
Drawing no. **A-100**