

20 WEDDERBURN ROAD

16 WEDDERBURN ROAD

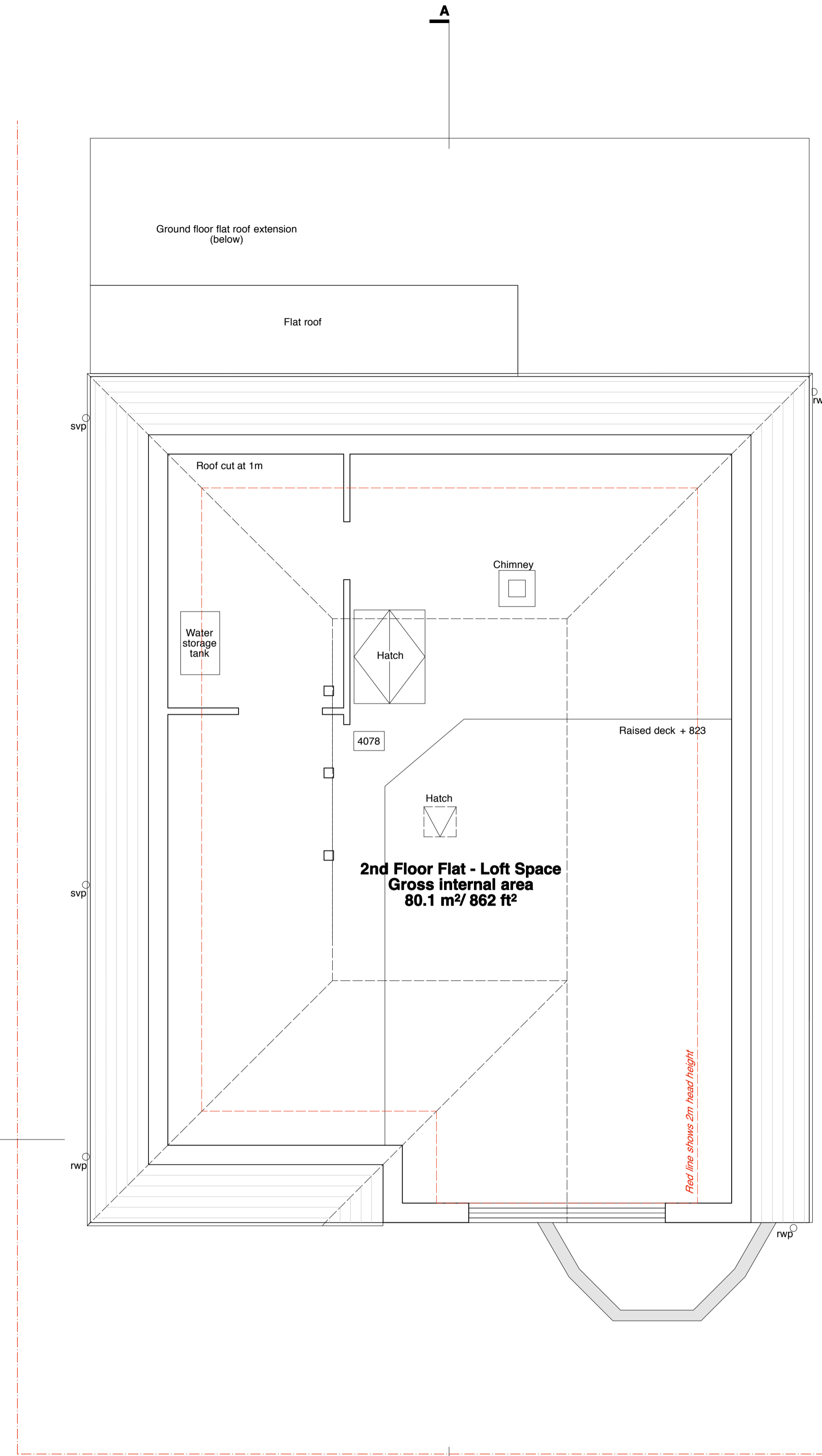

# LOFT PLAN EXISTING

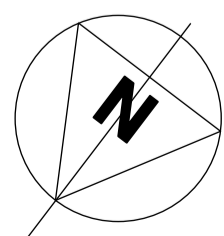

rev.	date	notes

**gpad** architecture & interior design

CLIENT **ADAM ANDREWS**

PROJECT  
**18 WEDDERBURN ROAD,  
LONDON NW3 5QG**

TITLE  
**EXISTING LOFT PLAN**

DWG NO **476-PA.05** REV

DRAWN BY **MWJ** SCALE **1:50@A1**

CHECKED BY DATE **March 2015**

T: 020 7549 2133 Unit 1  
F: 020 7549 2144 95 Dullington Street  
E: info@gpadltd.com Clerkenwell  
W: www.gpadltd.com London EC1V 0BC

This drawing is the copyright of gpad ltd. Not to be reproduced, retained or disclosed to any unauthorised person either wholly or in part without written permission. Do not scale the drawing. All indicated dimensions to be checked and verified on site by the contractor before commencement of any fabrication drawings or work whatsoever on site. Report any discrepancies to the Architect immediately. Drawings to be read in conjunction with relevant drawings and specifications.

FILE NAME PRINT SIZE **A1**