

THIS DRAWING MUST BE READ IN CONJUNCTION WITH OTHER ARCHITECT'S, CONSULTANT'S, SUB-CONTRACTOR'S AND SPECIALIST DRAWINGS.

ALL DIMENSIONS ARE IN MILLIMETRES UNLESS STATED OTHERWISE.

ALL DIMENSIONS ARE TO BE VERIFIED ON SITE AND CONFIRMED, BY THE CONTRACTOR, BEFORE COMMENCEMENT OF CONSTRUCTION.

IF THIS DRAWING EXCEEDS THE QUANTITIES TAKEN, IN ANY WAY, THE ARCHITECTS ARE TO BE INFORMED BEFORE THE WORK IS PUT IN HAND.

Rev Date Revision By Chk

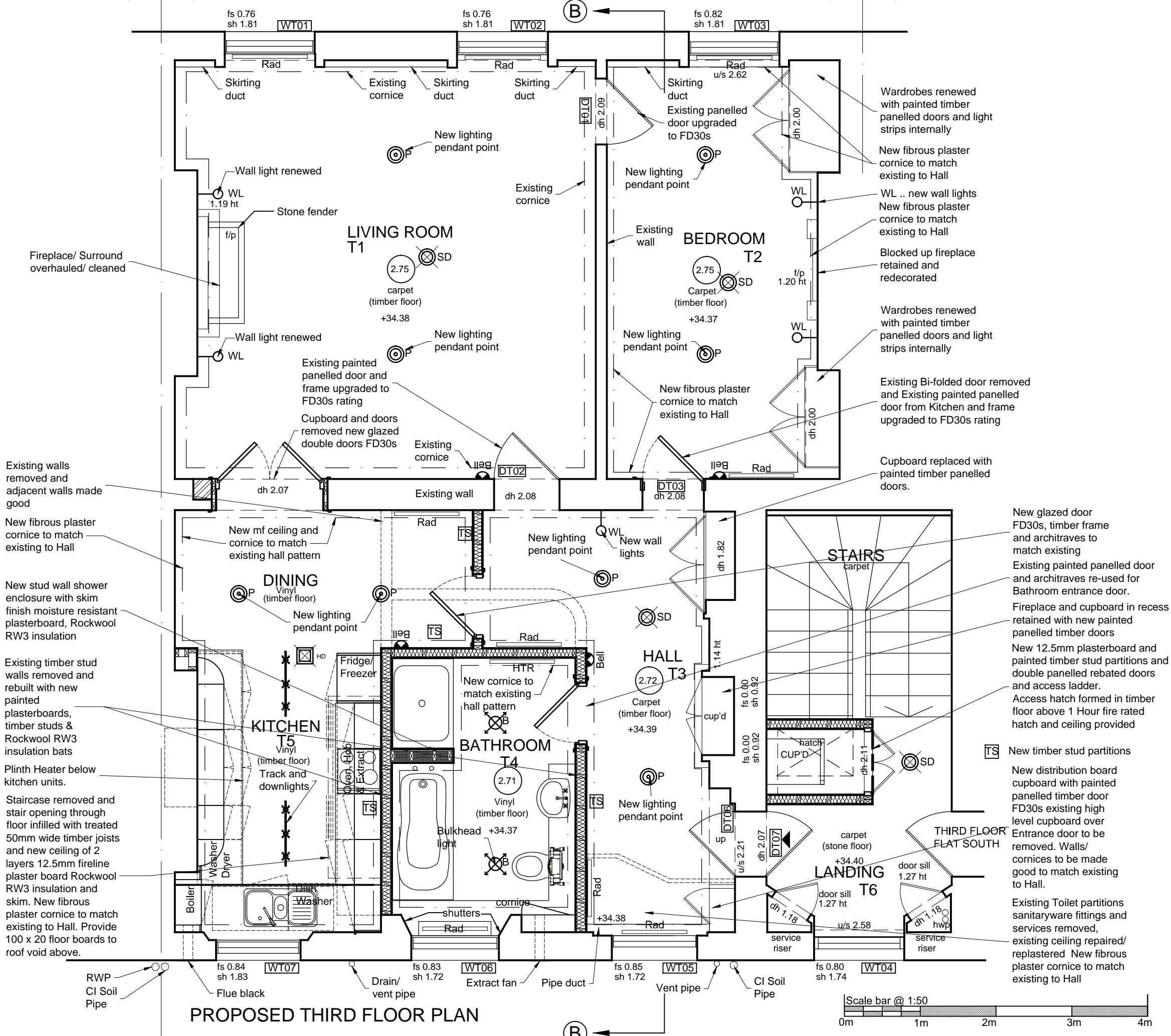

PROPOSED THIRD FLOOR PLAN



Notes

0000 Denotes ceiling height

GHK ARCHITECTS

Architects Designers Historic Building Specialists

Gilmore Hankey Kirke Limited ©
Heckfield Place, 530 Fulham Road, London SW6 5NR
Tel: +44 (0)20 7471 8000

Email: mail@ghkarchitects.co.uk
Web: http://www.architects.co.uk

Client
The Honourable Society of Gray's Inn

Project Name
**No 3 Raymond Buildings
Third Floor Flat North**
Drawing
Proposed Third Floor Plan

Scale 1:50 @ A3

Drawn by AM 16/02/2015

Checked by LM 17/02/2015

Project No. Drawing No Revision

HK 2154 01.131

