



Existing dormer windows retained behind new lift shaft.

**New Lift Shaft**  
 Micro-rib insulated external cladding system - off-white colour to match adjacent off-white glazed bricks to lightwell.  
 Single ply membrane on insulation on metal deck to form flat roof to shaft.  
 New steel structure to structural engineer's specification.

Existing RWPs re-routed to suit extent of new lift shaft.

Line of extent of new lift shaft internally within Ground & Lower Ground floors.

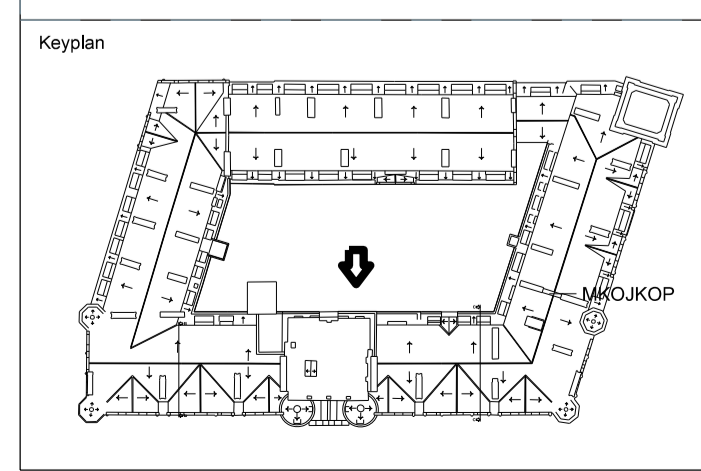

Notes:  
 1. Do not scale  
 2. Contractor to Check all dimensions and report omissions and errors to the Architect

No	Revision	Date	Initial	Chkd
03	Issued for Planning consent	03.02.15	SC	
02	Issued for Planning Permission	19.12.14	MG	
01	Created	05.12.14	MG	
	No Revision			

**NOTE:** These plans are based on preliminary survey drawings and are subject to change until final revisions are issued.

To be read in conjunction with Epr proposed Plans & Sections

**EPR** architects  
 30 Millbank  
 London SW1P 4DU  
 +44 (0) 20 7932 7600  
 www.epr.co.uk

Russell Hotel  
 Bloomsbury  
 Proposed Courtyard Elevation  
 East

PLANNING 1: 100 @ A1 05.12.14  
 Project No Type Btg Number Zone/Lvl Rev  
**10089 - T - 01 - 0416 - ZEA 03**