

Hand Court

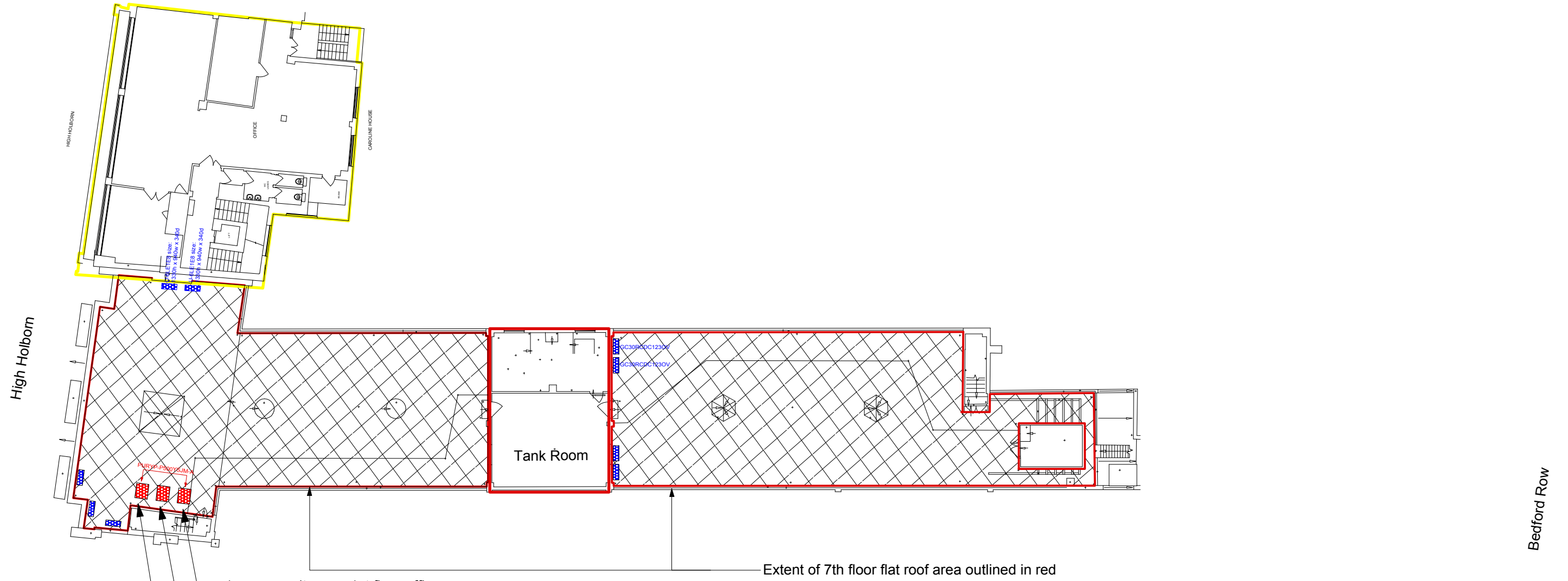

- 1no new unit serve 1st floor office.
- 1no new unit serve 4th floor office.
- 1no new unit serve 3rd floor office.

Extent of 7th floor flat roof area outlined in red

Brownlow Street



**DRAWING NOTES:**  
 All dimensions to be checked on site prior to commencement of any works, and/or preparation of any shop drawings.  
 Sizes of and dimensions to any structural elements are indicative only. See structural engineers drawings for actual sizes and dimensions.  
 Sizes of and dimensions to any service elements are indicative only. See service engineers drawings for actual sizes and dimensions.  
 This drawing to be read in conjunction with all other Architect's drawings, specifications and other Consultants' information.  
 All proprietary systems shown on this drawing are to be installed strictly in accordance with the Manufacturers/Suppliers recommended details.  
 Any discrepancies between information shown on this drawing and any other contract information or manufacturers/suppliers recommendations is to be brought to the attention of the Architect.  
 DO NOT SCALE FROM THIS DRAWING.

**DRAWING NOTES:**

High Holborn House	Existing condenser locations and model number
18-23 Hand Court	Proposed condenser locations and model number
45-48 Bedford Row	
Caroline House	
Brownlow House	
Extent of Lightwells	Flat Roof at 7th Floor Level

STATUS	REVISION	DATE

DRAWING <b>Proposed Seventh Floor Plan</b>	
SCALE 1:250 @ A3	DRAWING FILE REF
DATE Feb. 2015	DRAWN BY HW
DWG No. 807_PL_P--07	REVISION P1
DRAWING STATUS <b>Planning</b>	

<b>Buckley Gray Yeoman</b> Studio 4.04 The Tea Building 56 Shoreditch High Street London E1 6JJ T: 020 7033 9913 F: 020 7033 9914	
CLIENT	MPG Holborn 2 Ltd
PROJECT	High Holborn House