

0 12.5m 25m

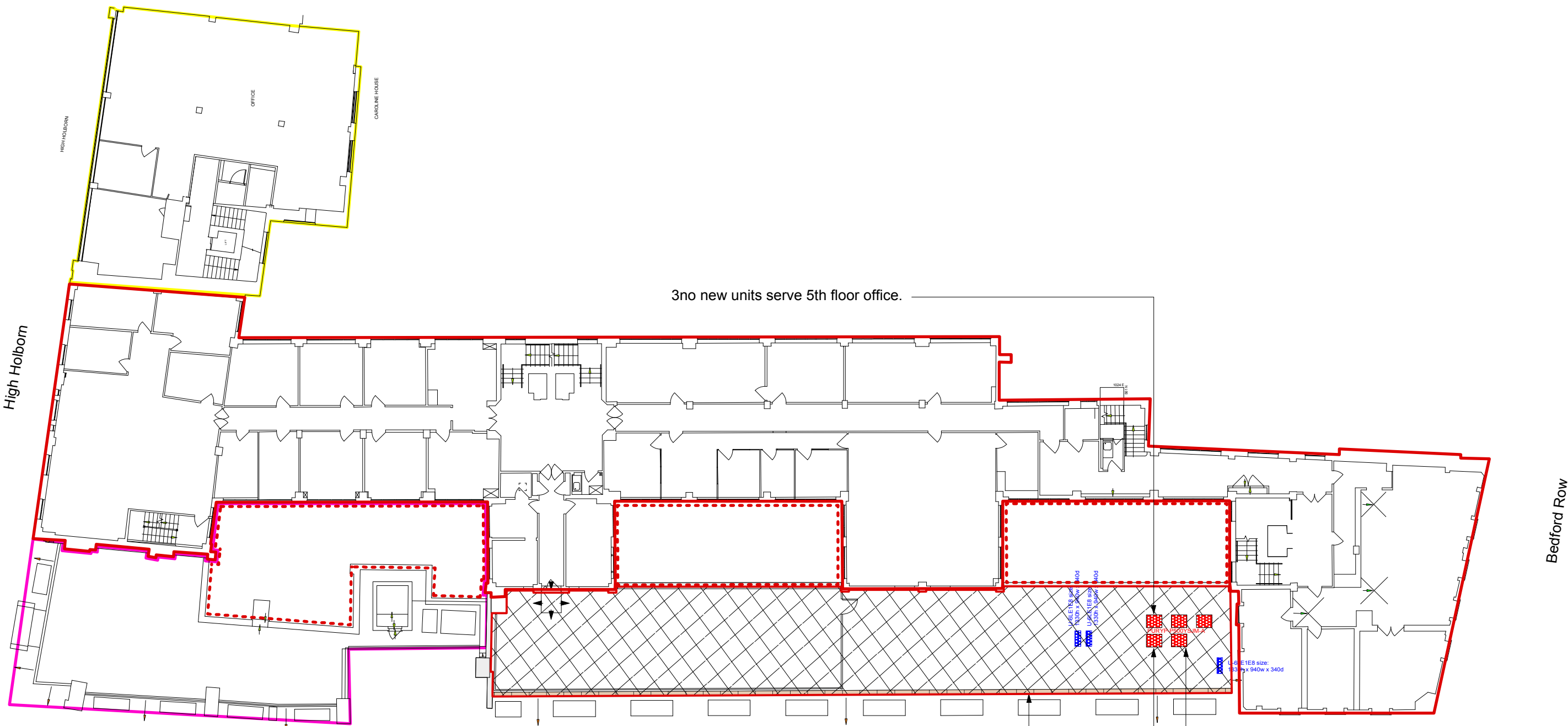

Hand Court



3no new units serve 5th floor office.

Extent of High Holborn House 5th floor flat roof area outlined in red

1no new units serve 4th floor office.

1no new units serve 2nd floor office.

DRAWING NOTES:

All dimensions to be checked on site prior to commencement of any works, and/or preparation of any shop drawings.
Sizes of and dimensions to any structural elements are indicative only. See structural engineers drawings for actual sizes/dimensions.
Sizes of and dimensions to any service elements are indicative only. See service engineers drawings for actual sizes and dimensions.
This drawing to be read in conjunction with all other Architect's drawings, specifications and other Consultants' information.
All proprietary systems shown on this drawing are to be installed strictly in accordance with the Manufacturers/Suppliers recommended details.
Any discrepancies between information shown on this drawing and any other contract information or manufacturers/suppliers recommendations is to be brought to the attention of the Architect.
DO NOT SCALE FROM THIS DRAWING.

DRAWING NOTES:

Building Identification
— High Holborn House
— 18-23 Hand Court
— 45-48 Bedford Row
— Caroline House
— Brownlow House
- - - Extent of Lightwells

Existing condenser locations and model number

Proposed condenser locations and model number

Flat Roof at 5th Floor Level

All existing units are set back sufficiently from parapet wall to avoid being seen from street level.

			DRAWING		Buckley Gray Yeoman Studio 4.04 The Tea Building 56 Shoreditch High Street London E1 6JJ T: 020 7033 9913 F: 020 7033 9914	
			Proposed Fifth Floor Plan			
			SCALE 1:250 @ A3	DRAWING FILE REF		
			DATE Feb. 2015	DRAWN BY HW		
			DWG No. 807_PL_P--05	REVISION P1		
		DRAWING STATUS Planning		CLIENT MPG Holborn 2 Ltd		
				PROJECT High Holborn House		
STATUS	REVISION	DATE	Information contained on this drawing is the sole copyright of Buckley Gray Yeoman and is not to be reproduced without their permission.			