

Hand Court

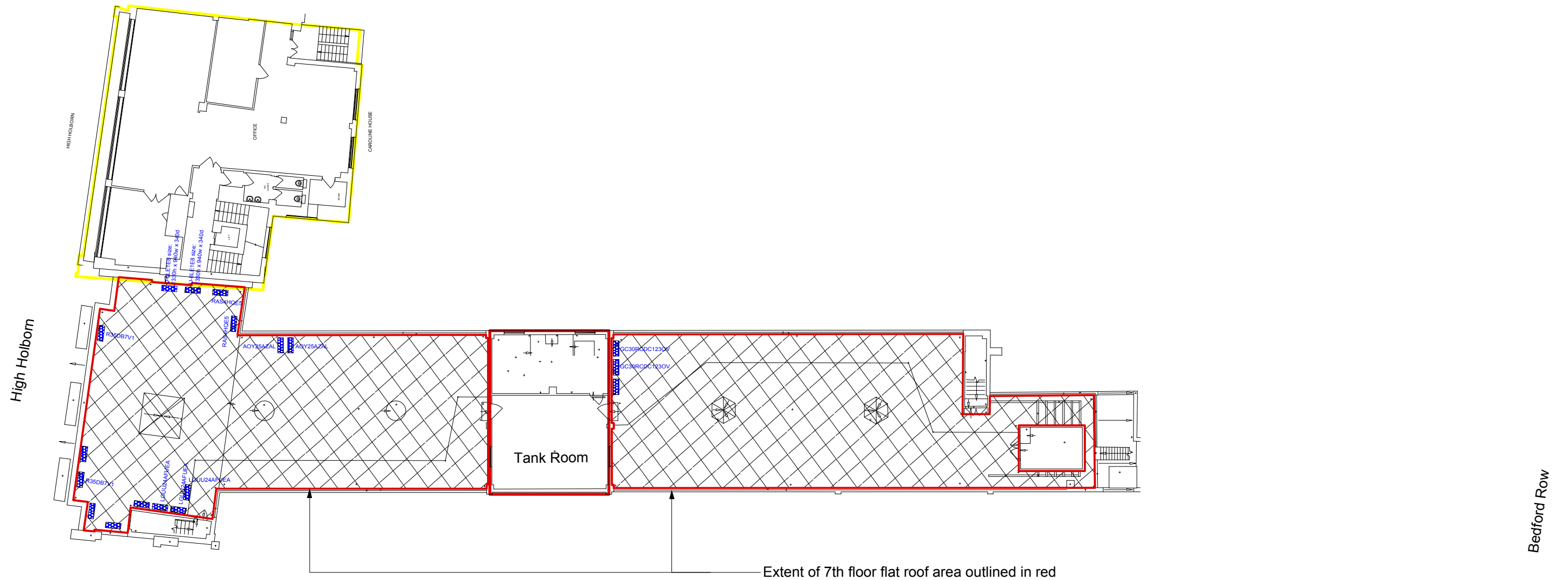

Extent of 7th floor flat roof area outlined in red

Brownlow Street

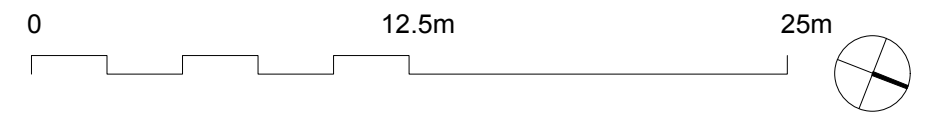

DRAWING NOTES:
 All dimensions to be checked on site prior to commencement of any works, and/or preparation of any shop drawings.
 Sizes of and dimensions to any structural elements are indicative only. See structural engineers drawings for actual sizes and dimensions.
 Sizes of and dimensions to any service elements are indicative only. See service engineers drawings for actual sizes and dimensions.
 This drawing to be read in conjunction with all other Architect's drawings, specifications and other Consultants' information.
 All proprietary systems shown on this drawing are to be installed strictly in accordance with the Manufacturers/Suppliers recommended details.
 Any discrepancies between information shown on this drawing and any other contract information or manufacturers/suppliers recommendations is to be brought to the attention of the Architect.
 DO NOT SCALE FROM THIS DRAWING.

DRAWING NOTES:

Building Identification

- High Holborn House
- 18-23 Hand Court
- 45-48 Bedford Row
- Caroline House
- Brownlow House
- - - - Extent of Lightwells

Existing condenser locations and model number

Flat Roof at 7th Floor Level

			DRAWING				
			Existing Seventh Floor Plan				
			SCALE	1:250 @ A3		DRAWING FILE REF	
			DATE	Feb. 2015		DRAWN BY	HW
			DWG No.	807_EX_P--07		REVISION	P1
DRAWING STATUS			Planning		CLIENT MPG Holborn 2 Ltd		
PROJECT			High Holborn House				
STATUS		REVISION	DATE				

Information contained on this drawing is the sole copyright of Buckley Gray Yeoman and is not to be reproduced without their permission.