

11 Maryon Mews
London NW3 2PU

18th February 2015

Senior Planning Officer
Regeneration and Planning Development Management
London Borough of Camden
Town Hall
Judd Street
London WC1H 8ND

Dear Sir/Madam,

PLANNING APPLICATIONS: 2015/0621/P & 2015/0622/P
SITE ADDRESS: 12 MARYON MEWS, LONDON NW3 2PU

Further to my recent correspondence of 15 February 2015, I enclose additional information relating to the above planning applications.

The enclosed are Land Registry Title Deed Plans of some of the individual Maryon Mews properties which are within the Maryon Mews Residents Company Ltd. (as is No. 12).

They display a discrepancy in the walkway areas, outlined in yellow which have led to confusion over this application. The Maryon Mews Residents Company Ltd. owns the walkways.

My correspondence of 15 February should be considered in the context of these Title Deed Plans in order to give a more comprehensive understanding of the application.

No residents were given any notification of these plans to be able to voice an objection. Is there any right of appeal?

Yours faithfully,

A black rectangular redaction box covering the signature of William Bramer.

William Bramer
Chairman
Maryon Mews Residents Company Ltd.

Silos brochure - Maryon Mews
(J. Sanders & Sons)

1975 Brochure info
(shanty walkway)

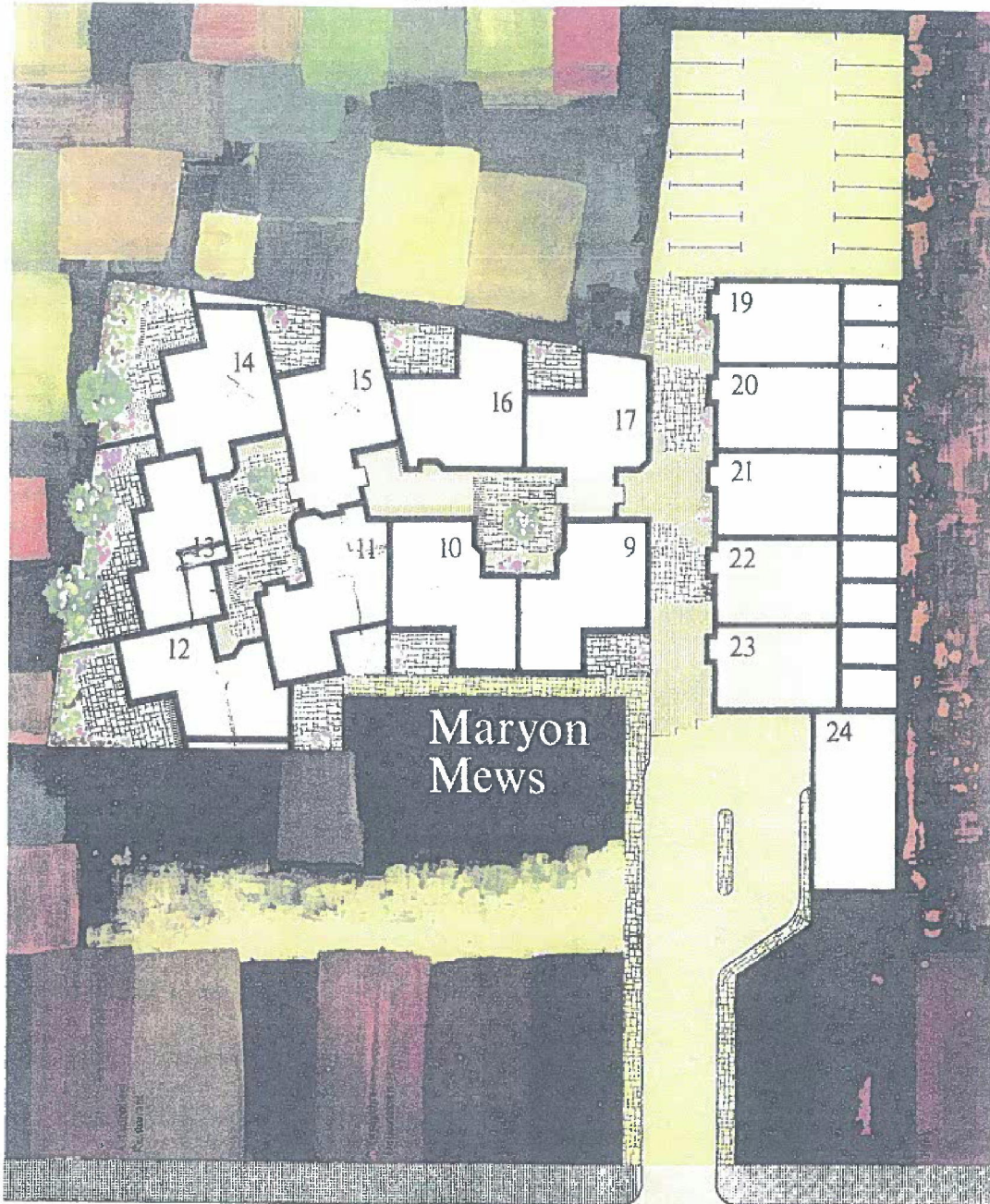

South End Road

no 9 Maryon Mews

Maryon Mews NW3

NG1270037



Sanders

H137

H M LAND REGISTRY

Title No: NG1270037

COPY (liable for distortion in scale)

of plan to Sanders

dated 6/10/1975

6/90

No 10

INDL 74113

10 Million / 1000

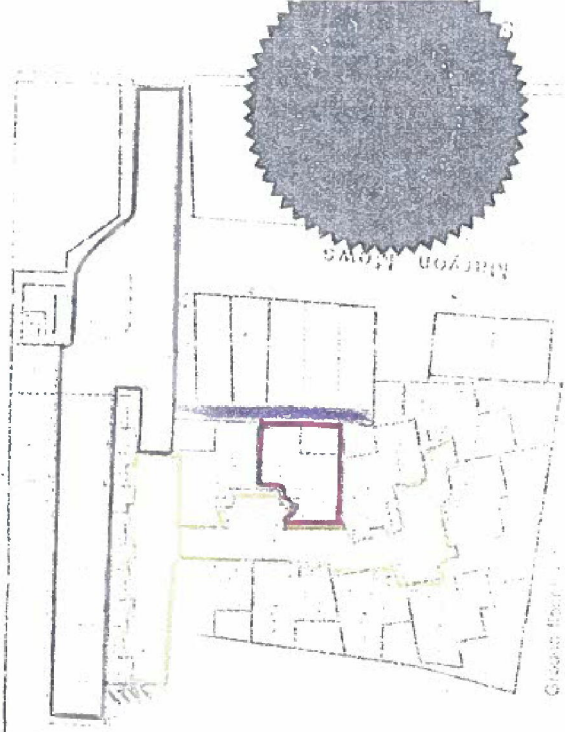

H.M. LAND REGISTRY
 TITLE No 74223
 PHOTOGRAPHIC COPY
 (made to discretion in scale)
 of PLAN No 78576/20
 dated 16/11/1975

Salliers

10 Maryon Mews

Address: 10 Maryon Mews NW3 2PU

Search: 2012/03339

HIGHWAYS INFORMATION



LEGEND

Public Highway	Border Agreements Maintaining Authority	Borough
Public Highway Centre Line	London Borough of Camden	Borough Boundary
Public Highway Carriageway	Transport for London	TfL Red Route
Public Highway Footway	London Borough of Islington	Transport for London Red Route
Crown Estate Maintained Area	City of London	Engineering Services Proposed Scheme
Crown Estate Carriageway	London Borough of Westminster	Area of Proposed Scheme
Crown Estate Footway	London Borough of Haringey	CrossRail
Housing Estate	Crown Estate	Crossrail Development Area
Housing Estate Area	London Borough of Barnet	Kings Cross
Housing Estate Carriageway	London Borough of Brent	Kings Cross Development Area
Housing Estate Footway		
Private Roads		
Private Road Centre Line		
Private Road Area		

Please note: Where indicated, Public Highway denotes the carriageway and adjacent footway. Right of way is not mapped.

11 Maryon Mews

No 11.

NGL273755

11 Maryon Mews NWG

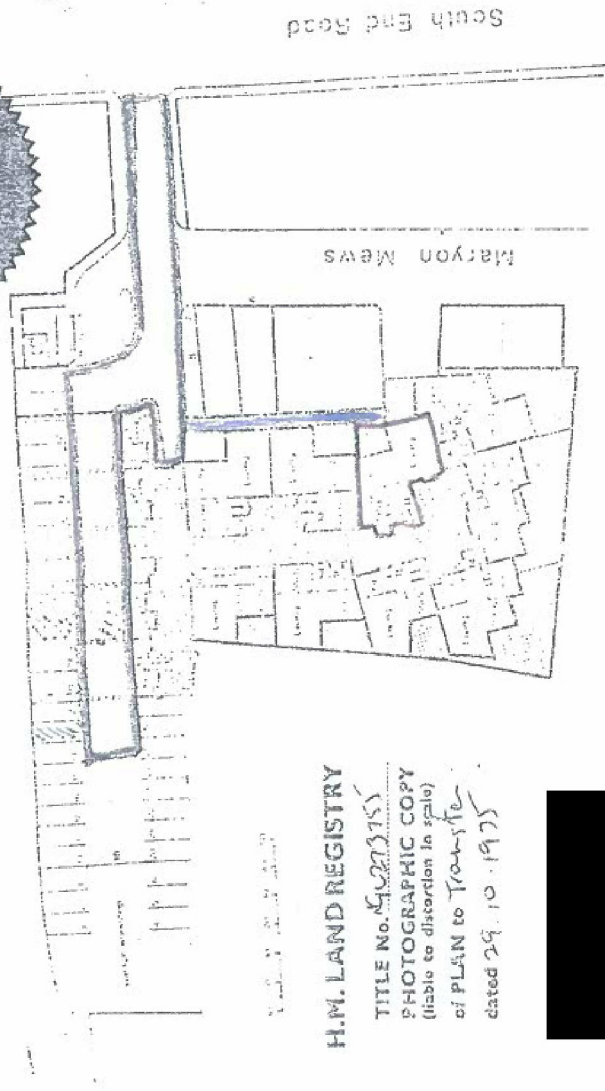
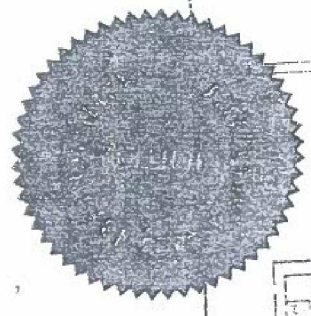

South End Road

Maryon Mews

H.M. LAND REGISTRY

TITLE No. NGL273755
PHOTOGRAPHIC COPY
(liable to distortion in scale)
of PLAN to Transfer
dated 29.10.1975



Solicitors to the Purchaser.

Simpsons

12 Maryon Mews

no 12

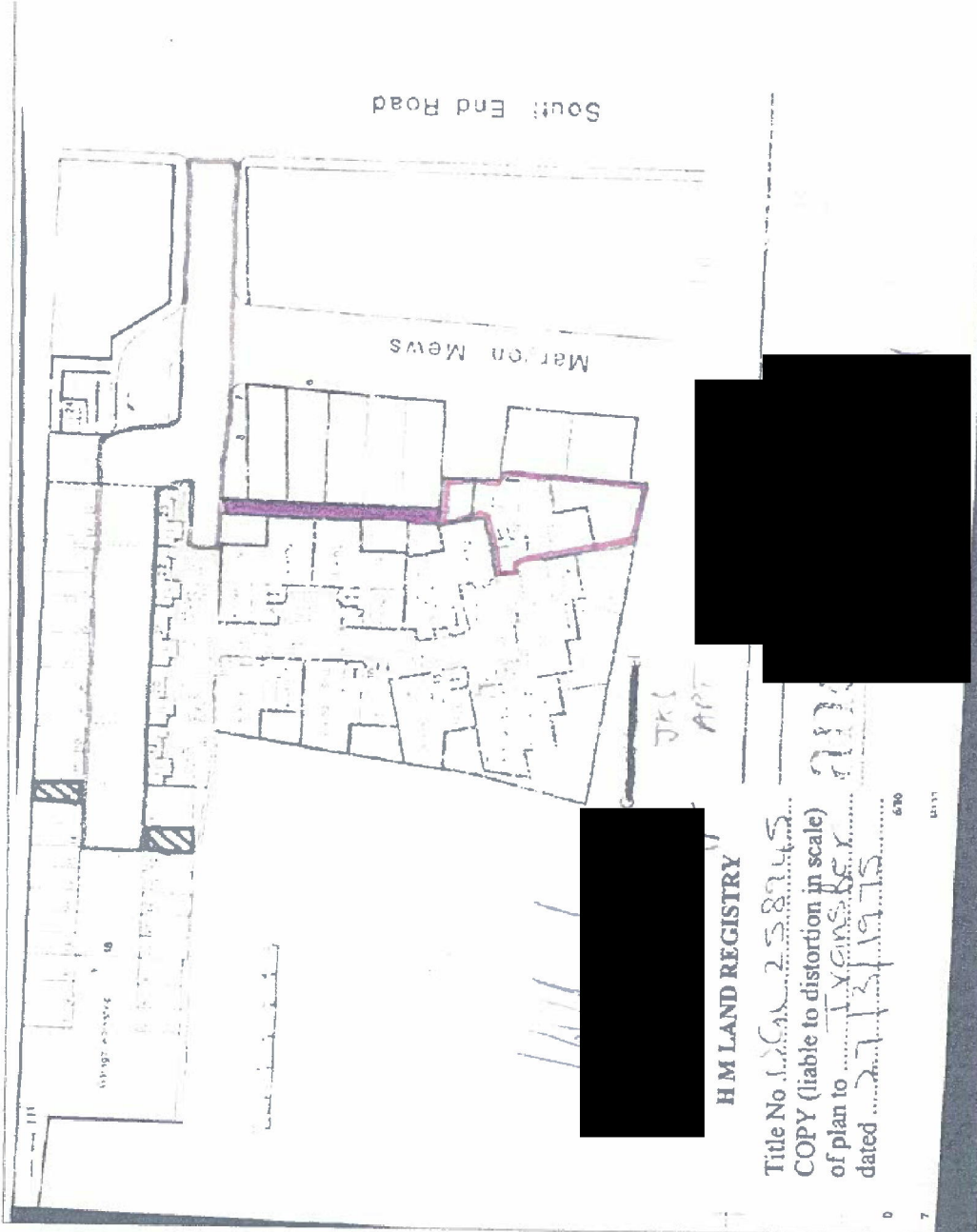

HM LAND REGISTRY

Title No. ... 258245
 COPY (liable to distortion in scale)
 of plan to ... TXGNS/851
 dated ... 27/3/1975

670
 671

13. Mayson Mees

No 13

NGL271726

Mayson Mees NGL271726



H 137

H.M. LAND REGISTRY

TITLE No. NGL 271726

PHOTOGRAPHIC COPY
(liable to distortion in scale)

of PLAN to Transfer

dated 10-10-1975

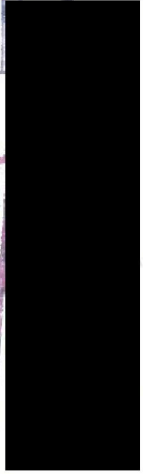

14 Marston Mews

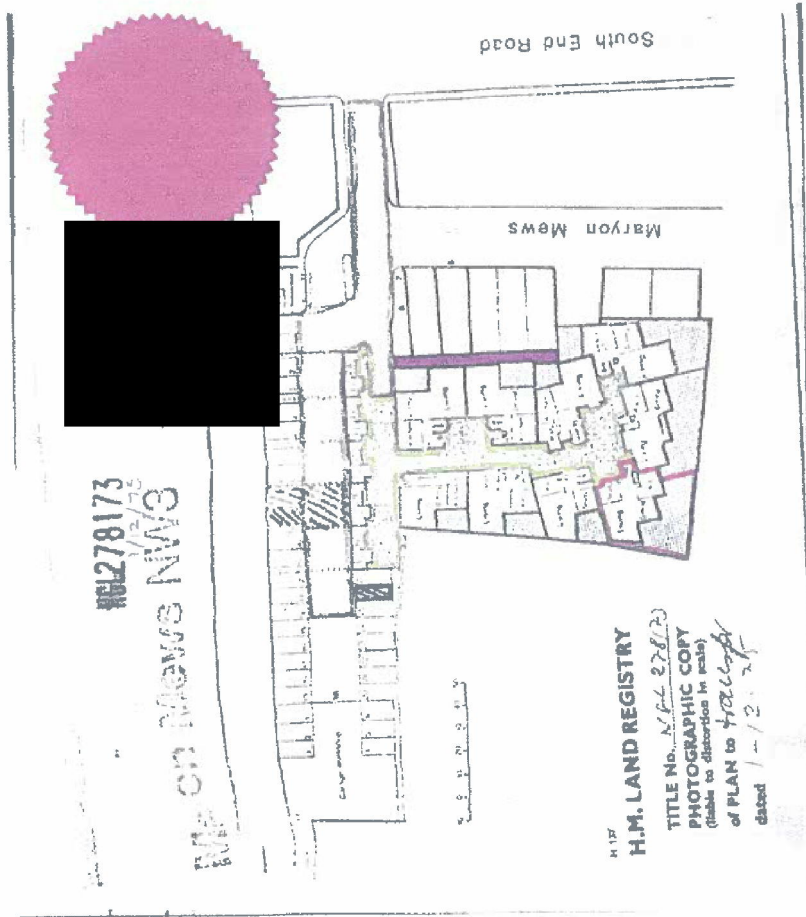

This official copy is incomplete without the preceding notes page.

14

15 Maryon Mews

LS

Maryon Mews NW3

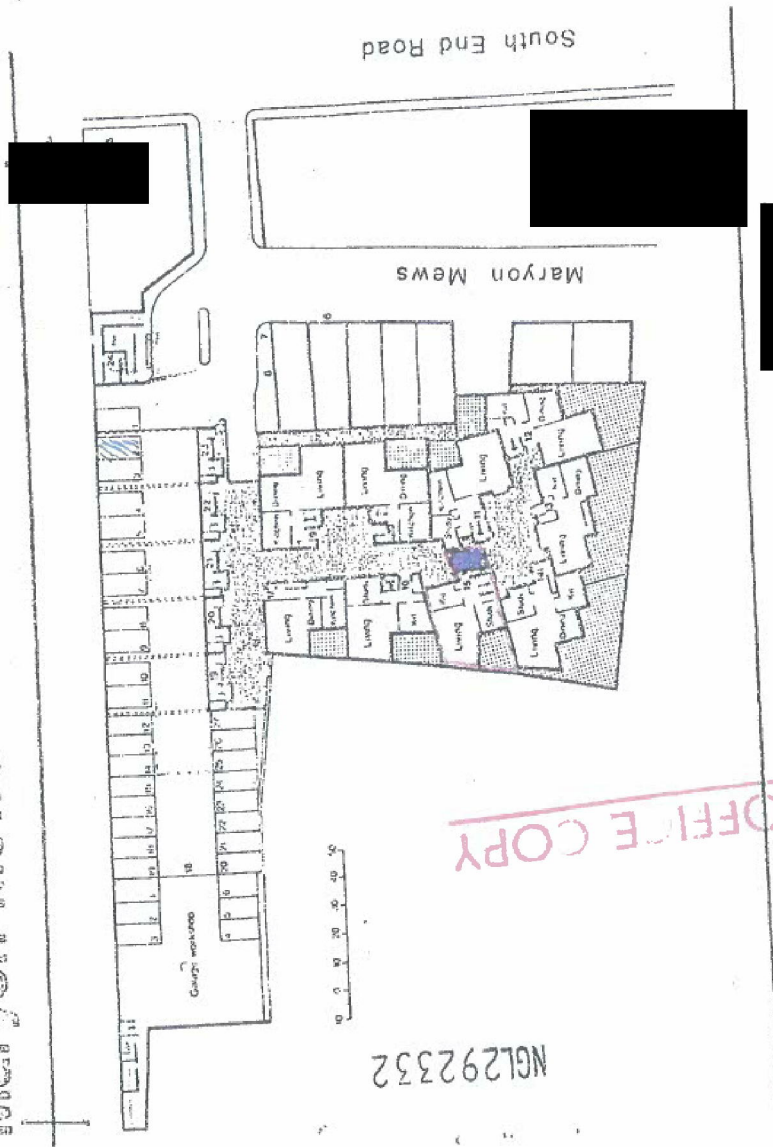

NGL292332

OFFICE COPY

Sanders

No 15



16 Maryon Mews

Maryon Mews 1974
NG127407

H.M. LAND REGISTRY
TITLE No. NG127407
PHOTOGRAPHIC COPY
(liable to distortion in scale)
of PLAN of [redacted]
dated 8/10/1975

Maryon Mews

Road

[redacted]

This document may be inspected without charge upon request.

17 Milsion Mews.

no 17.

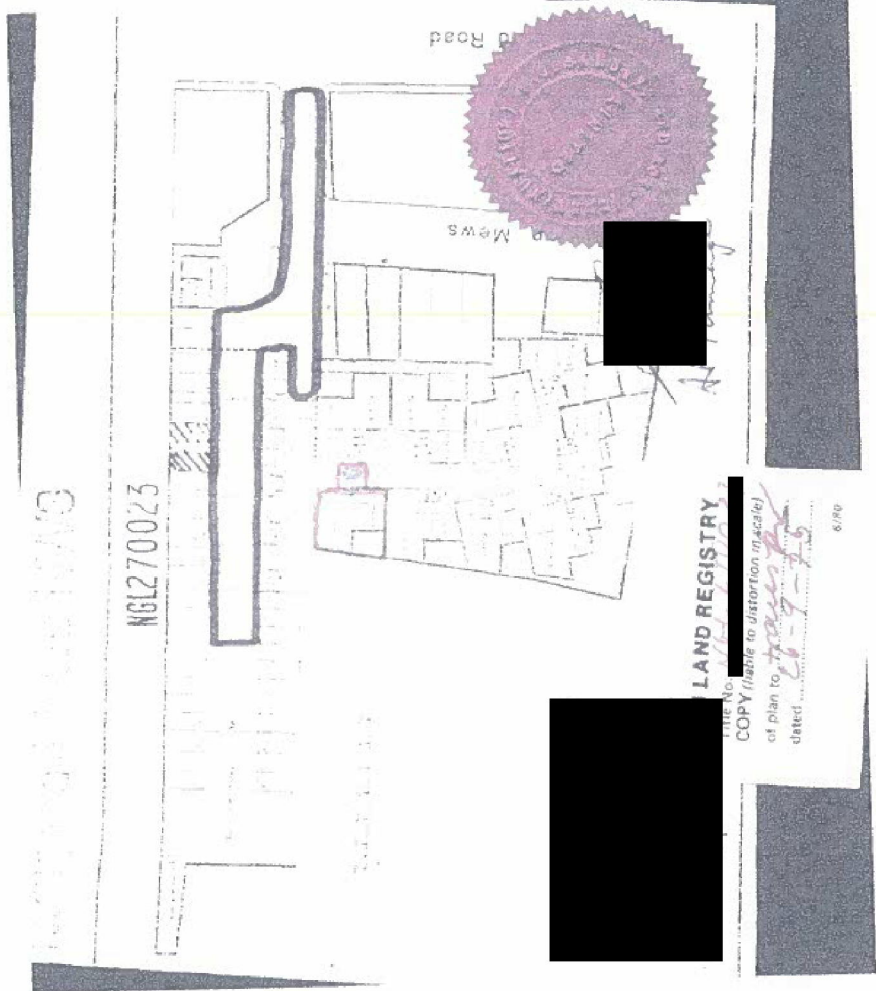

22 Maroon Mews

no 22

PS
1/5/2006
1/5/2006
1/5/2006

Maroon Mews NW3

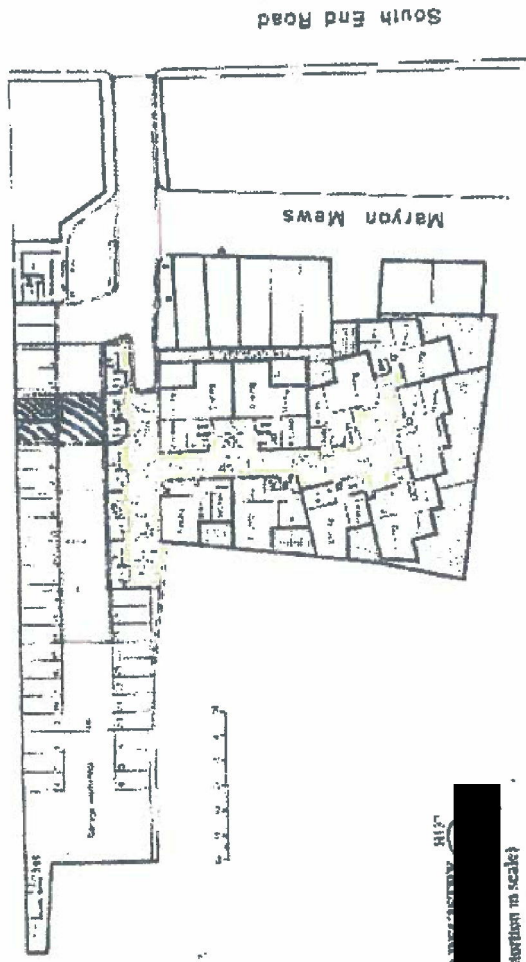

THE
COPY (able to distortion in scale)
of plan in...
dated...
1/5/2006

9-3 Midyon News

no 23

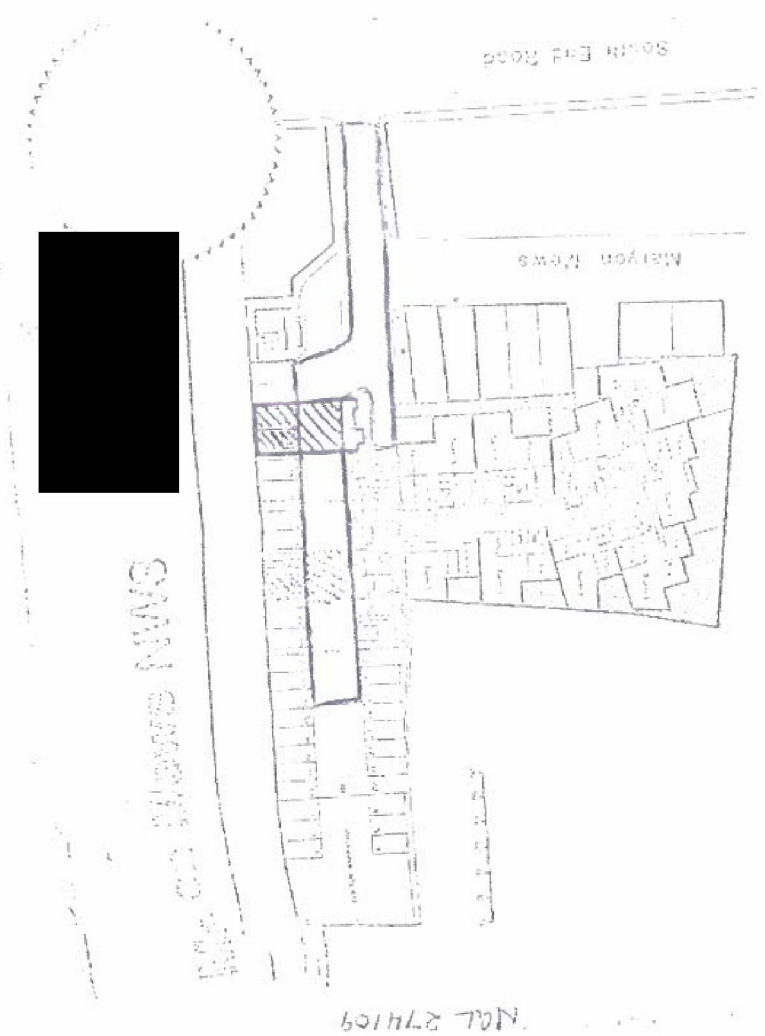

FILE NO. [REDACTED]
 COPY THIS
 OF PLAN TO
 dated 1987

MAP 274109

no 23