

2/200x90 PFCs bolted together with M12 bolts @ 450cc with spacers

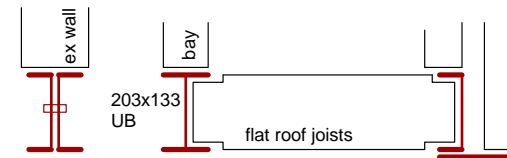

TYPICAL SECTION THRO' FLAT ROOF

Ground floor slab: Beam & Block but blocks not used. Instead void concrete filled at same time as laying 75mm oversite concrete reinforced with A142 mesh

8mm corner bars cast into wall and bent into slab topping

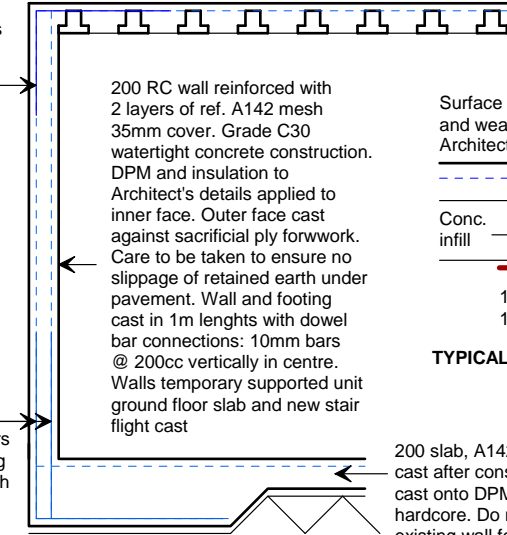

Surface waterproofing, insulation and wearing surface (setts?) to Architect's details

75 concrete topping



TYPICAL SECTION THRO' FLOOR BEAM

8mm starter bars in pairs. 1m long legs tied to mesh

200 slab, A142 mesh reinforced cast after construction of walls. cast onto DPM onto compacted hardcore. Do not undermine existing wall foundations

TYPICAL SECTION THRO' BASEMENT WALLS

Project
EXTENSIONS:
22 CHESTERFORD GARDENS
HAMPSTEAD
LONDON

Latter Ramsay Consultants
Consulting Civil and Structural Engineers

35-36 Guild Street, Stratford-upon-Avon, Warwickshire CV37 6QY
Telephone 44(0)1789 261172 email: mike@latterramsay.co.uk

Drawing Title
PROPOSED STRUCTURAL WORKS

Date	05/01/15	Drawing No	14M555/D01	Rev
Scale				
Drawn	mjw			