

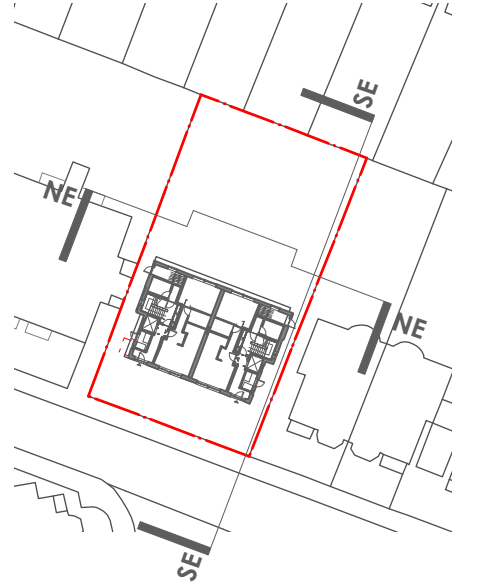

01 PROPOSED NORTH-EAST ELEVATION [NE]  
SCALE 1:100

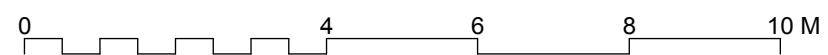

02 PROPOSED SOUTH-EAST ELEVATION [SE]  
SCALE 1:100



© john pardey architects

- Do not Scale. Used figured dimensions only.
- All dimensions to be checked on site.
- All drawings to be read in conjunction with engineer's drawings. Any discrepancies between consultants drawings to be reported to the Architect before any work commences.
- The Contractor's attention is drawn to the Health & Safety matters identified in the Health & Safety plan and on drawings as being potentially hazardous.
- These items should not be considered as a full and final list.
- The Work Package Contractor's normal Health & Safety obligations still apply when undertaking constructional operations both on and off site.

**NOTE:** ALL MATERIALS USED WITHIN THE PROPOSED REFURBISHMENT WILL MATCH THE EXISTING

**MATERIAL LEGEND**

- 01) RENDER: no change - existing rendered finish repaired as necessary - colour to match existing
- 02) BRICK: no change - existing brickwork and pointing repaired as necessary - replacement bricks to match existing stock.
- 03) ROOFING: no change - natural slate to match existing to any roof repairs
- 04) WINDOWS 1: new double glazed metal windows - appearance and finish to match existing. all lower floor level opening and accessible windows to be BS PAS 24:2012 with P1A rated laminated glass
- 05) WINDOWS 2: new double glazed windows - appearance and finish to match existing
- 06) RENDERED INFILL: existing opening blocked up with recessed rendered masonry to match existing render
- 07) DORMER WINDOWS: new double glazing to dormer windows - appearance to match existing
- 08) ENTRANCE DOORS: solid core with outer finish powder coated metal and glazed side panels - colour to match existing. entrance door to have metal canopy. door to be BS PAS 24:2012 or acceptable enhanced security standard. integrated audio visual access control.
- 09) REFUSE/CYCLE STORE DOORS: painted metal louvre door - colour to match existing windows. door to be self closing and locking.
- 10) GATES: no change - self closing and locking gates integrating to 2.4m vertical boarded timber fence.
- 11) RAINWATER GOODS: no change - made good where necessary
- 12) PV PANELS: photovoltaic panels mounted horizontally to dormers
- LANDSCAPING: no change - internal works only

B	24/02/15	TW	Cycle store doors added
A	12/12/14	TW	PV panels shown
rev	date	initials	description

drawing:

PROPOSED ELEVATIONS [SHEET 02]

project:

CLIFFORD PUGH HOUSE

drawing no:

1409\_401

status code/ revision:

B

status:

PLANNING

scale @ A1:

1:100

date:

NOV 2014

jpa

john pardey architects  
Beck Farm Studio      St Leonards Road  
East End      Lymington      SO41 5SR  
www.johnpardeyarchitects.com      01590 626465