

Sent 16/2/15

2015/1073



Planning Services
Camden Town Hall
Argyle Street
London WC1H 8EQ

Email (enquiries only): env.devcon@camden.gov.uk
Telephone : 020 7974 1911
Fax : 020 7974 5713

For office use
Date
Payee
App. No.

Fee

Application for tree works: works to trees subject to a tree preservation order (TPO)
and/or notification of proposed works to trees in a conservation area.

Town and Country Planning Act 1990

You can complete and submit this form electronically via the Planning Portal by visiting www.planningportal.gov.uk/apply

Publication of applications on planning authority websites

Please note that the information provided on this application form and in supporting documents may be published on the Authority's website. If you require any further clarification, please contact the Authority's planning department.

Please complete using block capitals and black ink.

You must use this form if you are applying for work to trees protected by a tree preservation order (TPO). (You may also use it to give notice of works to trees in a conservation area).

It is important that you read the accompanying guidance notes before filling in the form. Without the correct information, your application / notice cannot proceed.

1. Applicant Name and Address	2. Agent Name and Address
Title: <input type="text" value="Mrs"/> First name: <input type="text" value="Jennifer"/>	Title: <input type="text"/> First name: <input type="text"/>
Last name: <input type="text" value="Ross"/>	Last name: <input type="text"/>
Company (optional): <input type="text"/>	Company (optional): <input type="text"/>
Unit: <input type="text"/> House number: <input type="text" value="21"/> House suffix: <input type="text"/>	Unit: <input type="text"/> House number: <input type="text"/> House suffix: <input type="text"/>
House name: <input type="text" value="The Garden Flat"/>	House name: <input type="text"/>
Address 1: <input type="text" value="21 Thurlow Road"/>	Address 1: <input type="text"/>
Address 2: <input type="text"/>	Address 2: <input type="text"/>
Address 3: <input type="text"/>	Address 3: <input type="text"/>
Town: <input type="text" value="London"/>	Town: <input type="text"/>
County: <input type="text"/>	County: <input type="text"/>
Country: <input type="text" value="UK"/>	Country: <input type="text"/>
Postcode: <input type="text" value="NW3 5PP"/>	Postcode: <input type="text"/>

3. Trees Location

If all trees stand at the address shown in Question 1, go to Question 4. Otherwise, please provide the full address/location of the site where the tree(s) stand (including full postcode where available)

Unit:	<input type="text"/>	House number:	<input type="text"/>	House suffix:	<input type="text"/>
House name:	<input type="text"/>				
Address 1:	<input type="text"/>				
Address 2:	<input type="text"/>				
Address 3:	<input type="text"/>				
Town:	<input type="text"/>				
County:	<input type="text"/>				
Postcode (if known):	<input type="text"/>				

If the location is unclear or there is not a full postal address, either describe as clearly as possible where it is (for example, 'Land to the rear of 12 to 18 High Street' or 'Woodland adjoining Elm Road') or provide an Ordnance Survey grid reference:

Description:

4. Trees Ownership

Is the applicant the owner of the tree(s): ☒ Yes ☐ No
If 'No' please provide the address of the owner (if known and if different from the trees location)

Title:	<input type="text"/>	First name:	<input type="text"/>
Last name:	<input type="text"/>		
Company (optional):	<input type="text"/>		
Unit:	<input type="text"/>	House number:	<input type="text"/>
House name:	<input type="text"/>		
Address 1:	<input type="text"/>		
Address 2:	<input type="text"/>		
Address 3:	<input type="text"/>		
Town:	<input type="text"/>		
County:	<input type="text"/>		
Country:	<input type="text"/>		
Postcode:	<input type="text"/>		
Telephone numbers			
Country code:	National number:	Extension number:	
<input type="text"/>	<input type="text"/>	<input type="text"/>	
Country code:	<input type="text"/>		
<input type="text"/>	<input type="text"/>		
Country code:	Fax number (optional):		
<input type="text"/>	<input type="text"/>		
Email address (optional):	<input type="text"/>		

5. What Are You Applying For?

Are you seeking consent for works to tree(s) subject to a TPO? ☐ Yes ☐ No

Are you wishing to carry out works to tree(s) in a conservation area? ☒ Yes ☐ No

6. Tree Preservation Order Details

If you know which TPO protects the tree(s), enter its title or number below.

7. Identification Of Tree(s) And Description Of Works

Please identify the tree(s) and provide a full and clear specification of the works you want to carry out. Continue on a separate sheet if necessary. You might find it useful to contact an arborist (tree surgeon) for help with defining appropriate work. Where trees are protected by a TPO, please number them as shown in the First Schedule to the TPO where this is available. Use the same numbers on your sketch plan (see guidance notes).

Please provide the following information below: tree species (and the number used on the sketch plan) and description of works. Where trees are protected by a TPO you must also provide reasons for the work and, where trees are being felled, please give your proposals for planting replacement trees (including quantity, species, position and size) or reasons for not wanting to replant.
E.g. Oak (T3) - fell because of excessive shading and low amenity value. Replant with 1 standard ash in the same place.

7. Identification Of Tree(s) And Description Of Works continued ...

Removal of A conifer in the front of the house.

It is a rather sad conifer, ^{totally covered with ivy} which is struggling in its present position & there is little growth on the lower part & the top is rather weak. It also severely limits the ^{afternoon} light to the remainder of the front garden & the rooms at the front of the house at ground floor level (ours)

We propose to replace it with a flowering cherry which was ^{what} originally grew there. See attached letters from 2009 when we received permission to remove the conifer.

8. Trees - Additional Information

^{sadly} but delayed it past the allowed time.
Application reference & decision 2009/1438/T

Additional information may be attached to electronic communications or provided separately in paper format. April 24, 09

For all trees

A sketch plan clearly showing the position of trees listed in Question 7 must be provided when applying for works to trees covered by a TPO. A sketch plan is also advised when notifying the LPA of works to trees in a conservation area (see guidance notes). It would also be helpful if you provided details of any advice given on site by an LPA officer.

For works to trees covered by a TPO

Please indicate whether the reasons for carrying out the proposed works include any of the following. If so, your application must be accompanied by the necessary evidence to support your proposals. (See guidance notes for further details)

1. **Condition of the tree(s)** - e.g. it is diseased or you have fears that it might break or fall: ☐ Yes ☐ No
If YES, you are required to provide written arboricultural advice or other diagnostic information from an appropriate expert.

2. **Alleged damage to property** - e.g. subsidence or damage to drains or drives. ☐ Yes ☐ No
If YES, you are required to provide for:

Subsidence

A report by an engineer or surveyor, to include a description of damage, vegetation, monitoring data, soil, roots and repair proposals. Also a report from an arboriculturist to support the tree work proposals.

Other structural damage (e.g. drains, walls and hard surfaces)

Written technical evidence from an appropriate expert, including description of damage and possible solutions.

Documents and plans (for any tree)

Are you providing separate information (e.g. an additional schedule of work for Question 7)? ☐ Yes ☐ No

If YES, please provide the reference numbers of plans, documents, professional reports, photographs etc in support of your application. If they are being provided separately from this form, please detail how they are being submitted.

9. Authority Employee / Member

With respect to the Authority, I am:

- (a) a member of staff (c) related to a member of staff
(b) an elected member (d) related to an elected member

Do any of these statements apply to you?

☐ Yes

☒ No

If Yes, please provide details of the name, relationship and role

10. Application For Tree Works - Checklist

Only one copy of the application form and additional information (Question 8) is required. Please use the guidance and this checklist to make sure that this form has been completed correctly and that all relevant information is submitted. Please note that failure to supply precise and detailed information may result in your application being rejected or delayed. You do not need to fill out this section, but it may help you to submit a valid form.

Sketch Plan

- A sketch plan showing the location of all trees (see Question 8)

☒

For all trees

(see Question 7)

- Clear identification of the trees concerned
- A full and clear specification of the works to be carried out

☒

☒

For works to trees protected by a TPO

(see Question 7)

Have you:

- stated reasons for the proposed works?
- provided evidence in support of the stated reasons? in particular:
 - if your reasons relate to the condition of the tree(s) - written evidence from an appropriate expert
 - if you are alleging subsidence damage - a report by an appropriate engineer or surveyor and one from an arboriculturist.
 - in respect of other structural damage - written technical evidence
- included all other information listed in Question 8?

☐

☐

☐

☐

☐

11. Declaration - Trees

I/we hereby apply for planning permission/consent as described in this form and the accompanying plans/drawings and additional information. I/we confirm that, to the best of my/our knowledge, any facts stated are true and accurate and any opinions given are the genuine opinions of the person(s) giving them.

Signed - Applicant:

Or signed - Agent:

[Redacted Signature]

[Redacted Signature]

Date (DD/MM/YYYY):

16/2/15

(This date must not be before the date of sending or hand-delivery of the form)

12. Applicant Contact Details

Telephone numbers

Extension

[Redacted Contact Details]

13. Agent Contact Details

Telephone numbers

Extension number:

Country code:

National number:

Country code:

Mobile number (optional):

Country code:

Fax number (optional):

Email address (optional):

Electronic communication - If you submit this form by fax or e-mail the LPA may communicate with you in the same manner.
(Please see guidance notes)

House - 21 Thurlow Road
the garden flat.

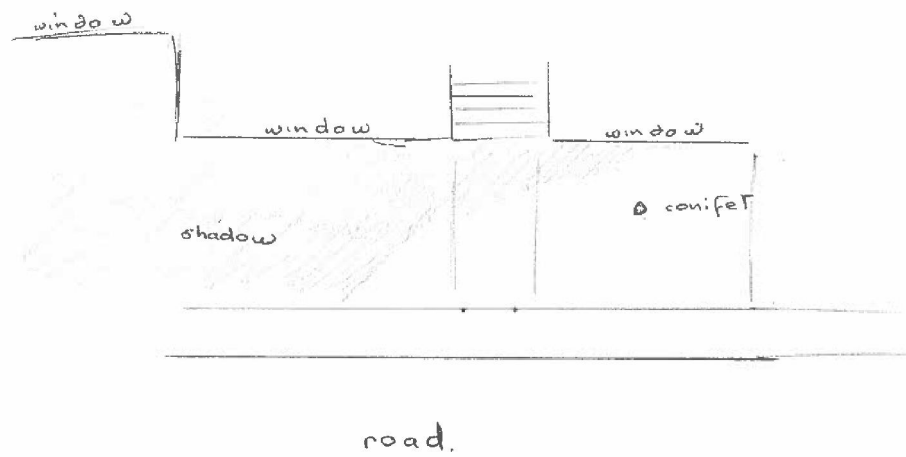



The Garden Flat
21 Thurlow Road
Hampstead
London, NW3 5PP

Kevin Fisher
Tree Officer
London Borough of Camden
Tree Section
Argyle Street
London WC1H 8NL

March 17, 2009

Dear Mr Fisher

The Garden Flat, 21 Thurlow Road, Hampstead, NW3 5PP

I am writing to you following a conversation with Alex (from your Department) this afternoon.

We have recently moved to Hampstead and I am looking to do some tree work in the garden. When we lived in Gloucester Crescent (27) you were very helpful with advice and granting permission for work on the trees in our garden and I am hoping that I may look to you for some more advice regarding three trees in our new home.

Firstly, a eucalyptus which has a girth of some 180 cm has been planted about 20 ft from the back of the house and we were advised by our surveyor at the time of purchase to remove it before it causes damage to the foundations. This obviously needs to be done in two stages to minimise the risk of heave and since last year the existing owners pollarded the tree and removed the low laterals - stage one has already been done. What I would like to do now is to carry out stage two - ie remove the remainder before the spring gets too advanced and replace it with a smaller less invasive tree, a tree more fitting to the garden. I would appreciate some suggestions.

First
Application

The second tree is a rather sad conifer which is growing up through the cherry at the front of the house. The tree itself is struggling in its present position and there is little growth on the lower part and the top is rather weak. It also severely limits the afternoon sunlight to the remainder of our front garden.

The last tree which needs attention is actually next door. It is a huge ^{no?} which has been neglected for years. It has a large amount of suckers growing at the base which need removing, it needs the canopy lifting to allow sunlight to filter through the trunk tidying and some laterals removed. It also has more suckers growing into the wall between our two properties which needs to be sorted out.

2nd
Application

As far as I am aware none of the trees in our garden have TPOs.

Yours sincerely,

Jennifer Ross

Martin - Hawn beams
Pleached 10 yrs £350.



Camden

ENVIRONMENT

Development Control Team

Camden Town Hall
Argyle Street
Entrance
Euston Road
London WC1H 8ND

TREE WORK APPLICATION FORM

Town & Country Planning Act 1990

Please read accompanying notes before answering any questions. Please complete all sections in BLOCK CAPITALS.

COMPLETE: (IF KNOWN)

TPO REF: _____ CA: _____

WARD: _____

1 Applicant (in block capitals)

Name Jennifer Ross

Address The Garden Flat

21 Thurlow Road

Hampstead, London

Post Code NW3 5PP

Tel. No. [REDACTED]

Agent (if any) to whom correspondence will be sent.

Name _____

Address _____

Post Code _____

Tel. No. _____

2 Address of Application Site (where tree is located)

As above

Post Code NW3 5PP

Is the applicant the owner of the land (Tick as appropriate)

Yes ☒

No ☐

If not, please specify the applicant's interest in the land (eg, occupier, tenant, adjoining neighbour, none):

Please tick relevant boxes: Is the tree in the:-

front ☒
one

rear ☒
one

side ☐

If the proposed works are not in the front of the property then please give a daytime telephone number where you can be contacted so that we can gain access.

Tel. no: as above

3 Proposed Works

Please describe the proposed works as fully as possible giving reasons for the proposed works;

If proposals will not fit in the area below, please continue on a separate sheet and attach. eg. type and location of tree.

See attached letter

Sketch Plan

In the space below, please provide a sketch or street plan showing the location of the tree(s) in relation to surrounding properties and neighbouring trees.

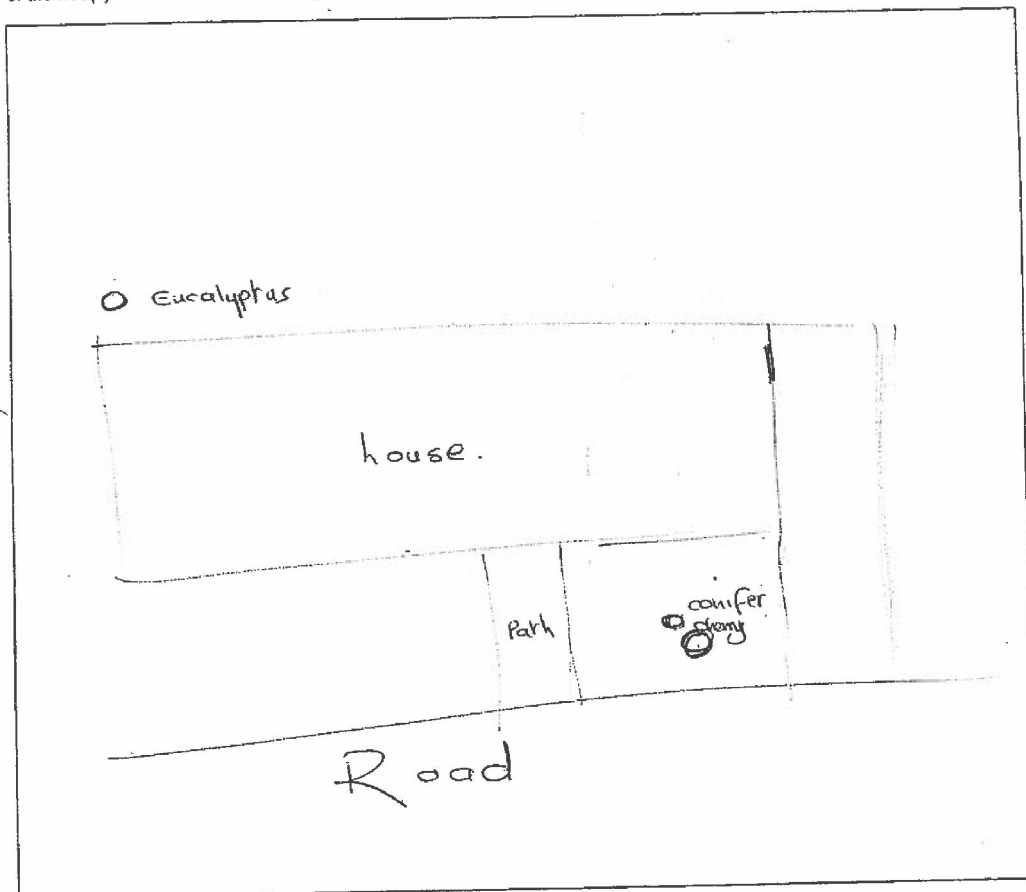

5 Additional information

Please list below any documentary evidence to support your proposal ie. structural engineer's report, arboricultural report etc and attach it to your application.

3 photos

6 Sign and Date your application and send your completed form to the following address:

Tree Section
Environment Department
Camden Town Hall
Argyle Street
London
WC1H 8ND

Signed: _____

Date: 17/3/09



Urban Design & Renewal Service
Planning
London Borough of Camden
Town Hall
Argyle Street
London WC1H 8ND

Tel 020 7278 4444
Fax 020 7974 1930
Textlink 020 7974 6866

urban.design@camden.gov.uk
www.camden.gov.uk/planning

Jennifer Ross
21 Thurlow Road
London
NW3 5PP

Application Ref: **2009/1433/T**
Please ask for: **Naomi Charman**
Telephone: 020 7974 5283

24 April 2009

Dear Sir/Madam

DECISION

Town and Country Planning Acts 1990 (as amended)
**NO OBJECTION TO SECTION 211 NOTICE OF WORKS TO TREE/S IN A
CONSERVATION AREA**

Address:
**21 Thurlow Road
London
NW3 5PP**

Proposed Work:
**REAR GARDEN: 1 x Eucalyptus - Remove.
FRONT GARDEN: 1 x Conifer - Remove.**

The Council has considered your notification of intended works to trees dated 17 March 2009 and does not wish to object.

Informative(s):

- 1 This notice is valid for 2 years from the date of this letter or until the work is completed, whichever is the sooner.
- 2 You are advised that the appropriate standards for tree work are set out in BS 3998: 1989. Failure to ensure that the proposed works are carried out to these standards may result in damage to the tree(s) and may result in legal action by the Council.
- 3 Please note that any approval given by the Council does not give an exemption from the requirements to comply with the Wildlife and Countryside Act 1981 (as



INVESTOR IN PEOPLE

amended), or any other Acts offering protection to wildlife. Of particular note is the protection offered to bats, birds and their nests, whilst being built or in use. For further information contact Natural England on 020 7932 5800.

Yours faithfully

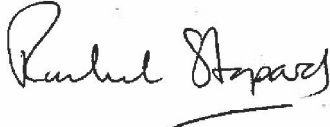
A handwritten signature in black ink, appearing to read 'Rachel Stopard', with a horizontal line drawn underneath the name.

Rachel Stopard
Director of Culture & Environment