

NOTES

- DO NOT SCALE FROM THIS DRAWING.
- ALL ROUTES SUBJECT TO AGREEMENT WITH PLANNING AND HERITAGE OFFICERS.

SYSTEM 1 & 2

MITSUBISHI PURY-P500YJM-A



CAPACITY - HEATING (NOMINAL) - 63.0  
COOLING (NOMINAL) - 56.0  
HIGH PERFORMANCE - 57.6  
COP (RATED) HTG - 54.8  
COOLING (L/K) - 515

POWER INPUT - HEATING (NOMINAL) - 15.19  
COOLING (NOMINAL) - 14.85  
HIGH PERFORMANCE - 17.21  
COP (RATED) HTG - 17.74  
COOLING (L/K) - 9.36

COP/EEER - 4.91 / 3.77

MAX NO. OF CONNECTIBLE INDOOR UNITS - 50

AIRFLOW (m³/MIN) - 85 / 85

NOISE (dBA) - 59

WEIGHT (kg) - 24.8 - 24.8

DIMENSIONS (mm) - WIDTH - 920 x 920  
DEPTH - 768  
HEIGHT - 1710

ELECTRICAL SUPPLY - 380-415v, 50Hz

PHASE - 3

STARTING CURRENT (A) - 8 / 8

RUNNING CURRENT (A) - HEATING - 22.3  
COOLING - 22.9

FUSE RATING (A) - 25 / 20

MAIN CABLE NO. CORES - 4 - EARTH

SYSTEM 3 & 4

MITSUBISHI PURY-P600YJM-A



CAPACITY - HEATING (NOMINAL) - 76.5  
COOLING (NOMINAL) - 69.0  
HIGH PERFORMANCE - 69.2  
COP (RATED) HTG - 66.6  
COOLING (L/K) - 635

POWER INPUT - HEATING (NOMINAL) - 19.07  
COOLING (NOMINAL) - 18.65  
HIGH PERFORMANCE - 21.75  
COP (RATED) HTG - 17.35  
COOLING (L/K) - 12.38

COP/EEER - 4.91 / 3.51

MAX NO. OF CONNECTIBLE INDOOR UNITS - 50

AIRFLOW (m³/MIN) - 85 / 85

NOISE (dBA) - 62

WEIGHT (kg) - 24.5 - 24.5

DIMENSIONS (mm) - WIDTH - 920 x 920  
DEPTH - 768  
HEIGHT - 1710

ELECTRICAL SUPPLY - 380-415v, 50Hz

PHASE - 3

STARTING CURRENT (A) - 8 / 8

RUNNING CURRENT (A) - HEATING - 29.4  
COOLING - 30.3

FUSE RATING (A) - 25 / 25

MAIN CABLE NO. CORES - 4 - EARTH

SYSTEM 5

MITSUBISHI PURY-P250YJM-A



CAPACITY - HEATING (NOMINAL) - 31.5  
COOLING (NOMINAL) - 28.0  
HIGH PERFORMANCE - 31.5  
COP (RATED) HTG - 28.7  
COOLING (L/K) - 26.6

POWER INPUT - HEATING (NOMINAL) - 7.32  
COOLING (NOMINAL) - 7.15  
HIGH PERFORMANCE - 9.22  
COP (RATED) HTG - 7.15  
COOLING (L/K) - 4.05

COP/EEER - 4.10 / 3.97

MAX NO. OF CONNECTIBLE INDOOR UNITS - 25

AIRFLOW (m³/MIN) - 85 / 85

NOISE (dBA) - 57

WEIGHT (kg) - 24.8

DIMENSIONS (mm) - WIDTH - 920  
DEPTH - 768  
HEIGHT - 1710

ELECTRICAL SUPPLY - 380-415v, 50Hz

PHASE - 3

STARTING CURRENT (A) - 8

RUNNING CURRENT (A) - HEATING - 11.3  
COOLING - 9.9

FUSE RATING (A) - 20

MAIN CABLE NO. CORES - 4 - EARTH

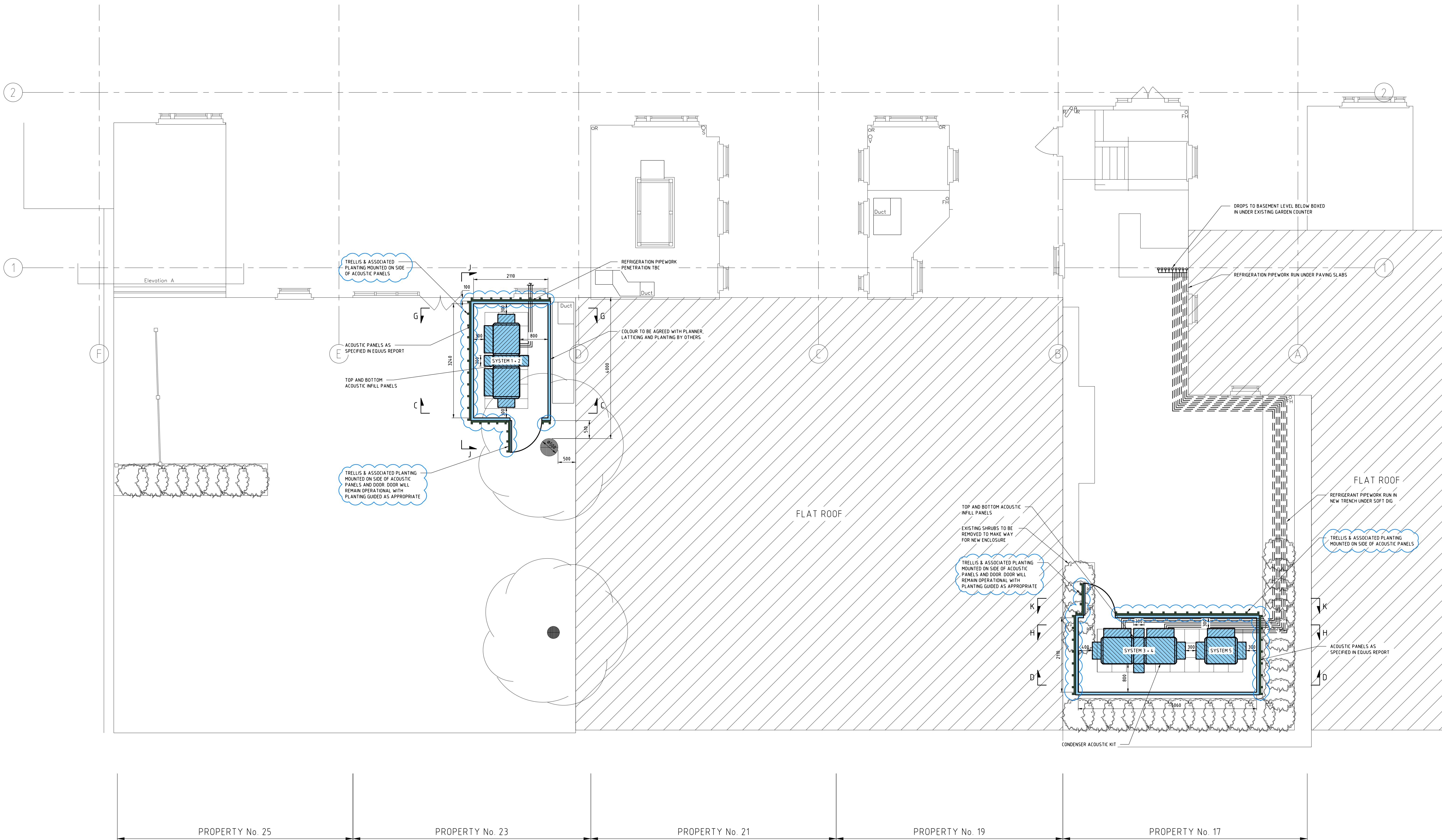

FOR PLANNING

REV	DESCRIPTION	DATE	CHKD
PL5	PROPOSED TRELLIS SHOWN ON ACOUSTIC ENCLOSURES	29/07/14	
PL4	REFRIGERANT PIPEWORK RE-ROUTED TO RUN UNDER PAVING SLABS	02/07/14	
PL3	DOOR POSITION SWING ADJUSTED TO AVOID ACOUSTIC ENCLOSURE TO AVOID IMPACTING THE EXISTING TREE	23/06/14	
PL2	DRAWING UPDATED TO INCORPORATE COMMENTS	17/01/14	KL
PL1	ISSUED FOR PLANNING	15/11/13	KL

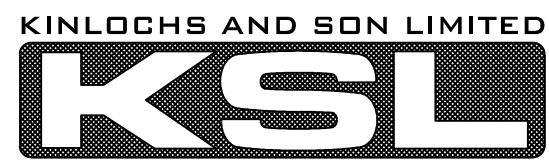

Unit D4 Laser Quay  
Culpeper Close, Medway City Estate,  
Rochester, Kent ME2 4HU  
Tel: 01634 290999  
Fax: 01634 294499

CLIENT

THE ACADEMY HOTEL

PROJECT

THE ACADEMY HOTEL

TITLE

PROPOSED EXTERNAL GROUND FLOOR  
NEW CONDENSER LAYOUT

SCALE

1:50

PAGE SIZE

A0

DATE

AUGUST 2013

DRAWN

APP

ENGINEER

MP

CHECKED

MP

DRAWING NO.

REVISION

2745-M203

PL1 PL2 PL3 PL4 PL5