

Notes: Do not scale from this drawing. Contractor to take and check all dimensions on site before work commences. Discrepancies to be reported to architect. Subcontractors to verify all dimensions on site before making shop drawings or commencing manufacture. This drawing is copyright.

WOLSEY MEWS

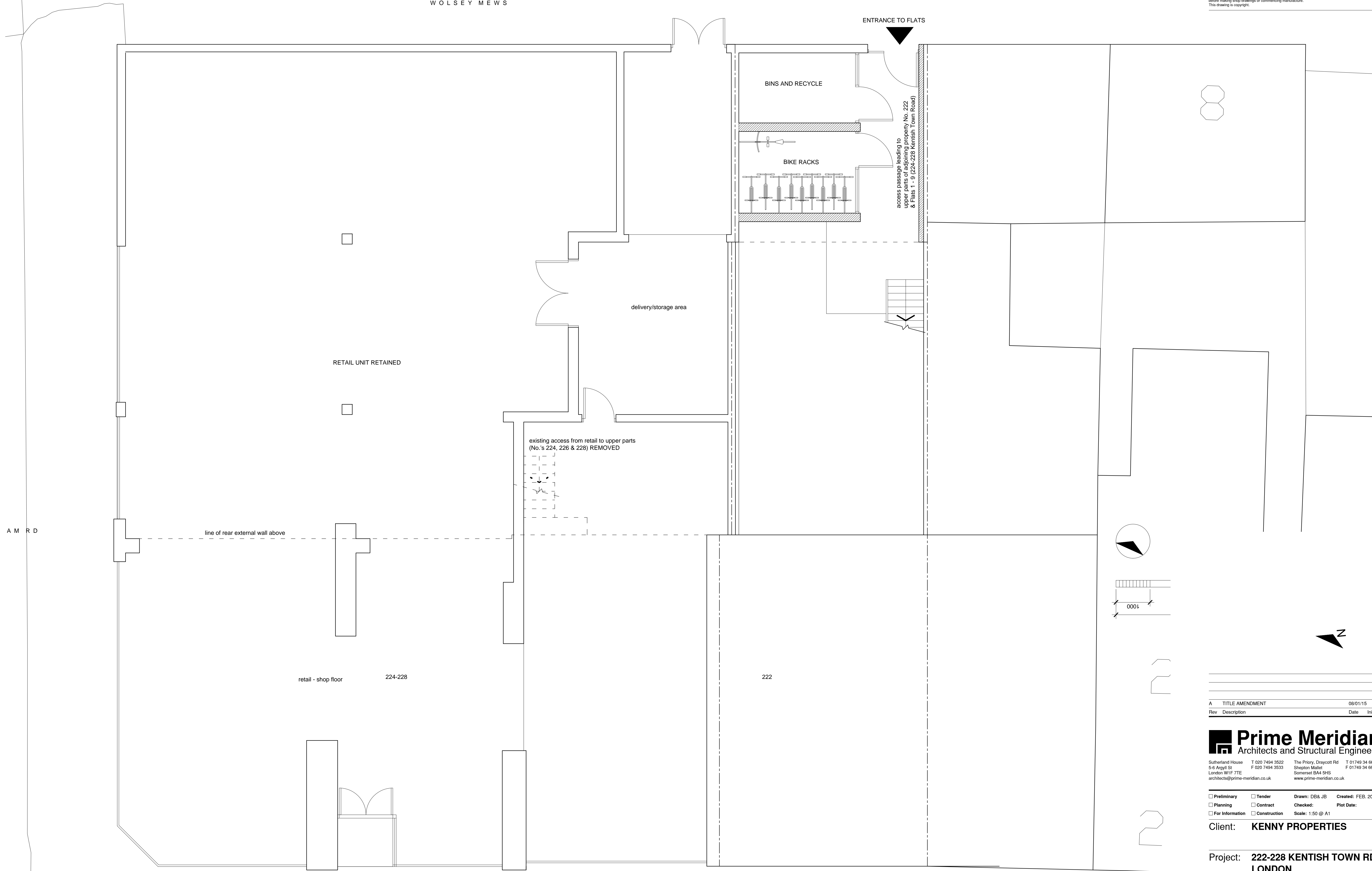

PROPOSED GROUND FLOOR PLAN

KENTISH TOWN RD

Rev	Description	Date	Initial
A	TITLE AMENDMENT	08/01/15	

Prime Meridian
Architects and Structural Engineers

Sutherland House T 020 7494 3522 The Priory, Draycott Rd T 01749 34 66 91
5-6 Argyl St F 020 7494 3533 Shapton Mallet F 01749 34 66 77
London W1F 7TE architects@prime-meridian.co.uk Somerset BA4 5HS www.primemeridian.co.uk

- Preliminary
- Tender
- Drawn: DB& JB
- Created: FEB. 2015
- Planning
- Contract
- Checked:
- Plot Date:
- For Information
- Construction
- Scale: 1:50 @ A1

Client: **KENNY PROPERTIES**

Project: **222-228 KENTISH TOWN RD
LONDON
NW5 2AD**

Title: **PROPOSED GROUND
FLOOR PLAN**