

GRIDLINE A - SET OUT FROM CORNER TO RIGHT OF DOORWAY (AS LOOKED AT FROM FRONT LIGHTWELL) OF FRONT LIGHTWELL AT BASEMENT LEVEL.

GRIDLINE B - SET OUT ON CENTRE LINE OF SPINE WALL AT BASEMENT LEVEL.

GRIDLINE C - LINE OF EXTERNAL FACE OF REAR WALL OF MAIN HOUSE AT BASEMENT LEVEL.

GRIDLINE D - LINE OF EXTERNAL CORNER OF EXISTING REAR OUTBUILDING AT BASEMENT LEVEL.

GRIDLINE E - LINE OF INNER FACE OF REAR WALL TO LIGHTWELL AT BASEMENT LEVEL.

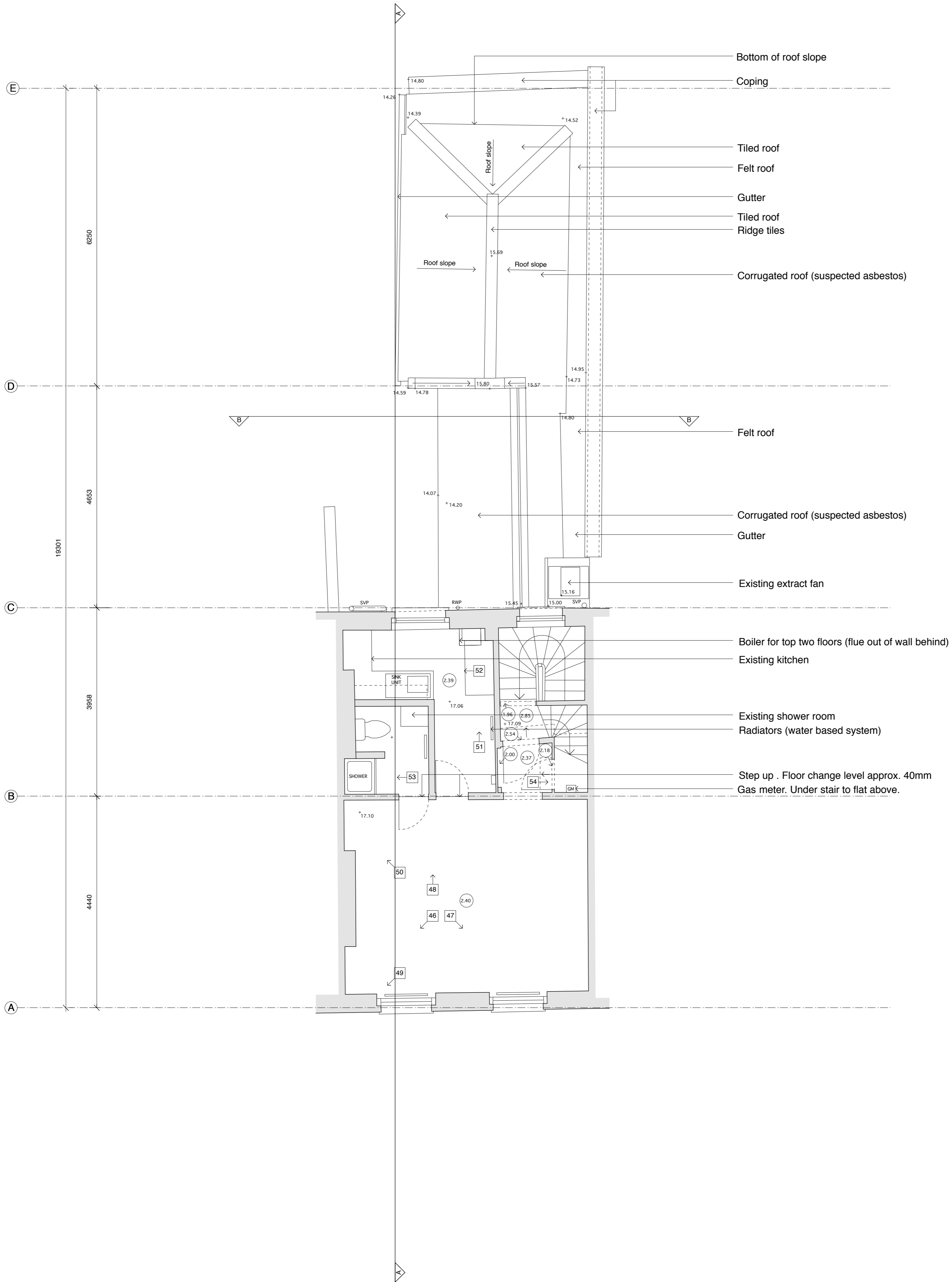

SECOND FLOOR PLAN

© 2013 syte architects limited
 The drawings are the property of syte architects limited. They may not be reproduced, stored in a retrieval system, or transmitted in any form or by any means, electronic, mechanical, photocopying, recording, or by any information storage and retrieval system, without the prior written permission of syte architects limited.

PLANNING ISSUE

revisions
 A - 17.05.13 Revised to Planning Issue
 B - 23.07.13 Position of section lines amended to match proposed drawings

syte

60-64 Newark Street London W1F 8TS T: 020 7754 8212 F: 020 7754 8201

client

lan Pirie

project

6 Leigh Street
 London
 WC1H 9EW

drawing title

Second Floor Plan
 As Existing

date	drawn by	revision
Jan 13	RW	B
scale	checked by	drawing
1:50@A1		
1:100@A3	RW	205.103

