

GENERAL NOTES

All setting out must be checked on site
All levels must be checked on site and refer to Ordnance Datum Newlyn unless alternative Datum given
All fixings and weatherings must be checked on site
All dimensions must be checked on site
This drawing must not be scaled
This drawing must be read in conjunction with all other relevant drawings and specification clauses
This drawing must not be used for land transfer purposes
Calculated areas in accordance with Assael Architecture's Definition of Areas for Schedule of Areas
This drawing must not be used on site unless issued for construction
Subject to survey, consultation and approval from all statutory Authorities

Revision Status:
P=Preliminary C=Contract

© 2013 Assael Architecture Limited

Assael Architecture Limited has prepared this document in accordance with the instructions of the Client under the agreed Terms of Appointment. This document is for the sole and specific use of the Client and Assael Architecture shall not be responsible for any use of its contents for any purpose other than that for which it was prepared and provided. Should the Client require to pass electronic copies of the document to other parties, this should be for co-ordination purposes only, the whole of the file should be so copied, but no professional liability or warranty shall be extended to other parties by Assael Architecture in this connection without the explicit written agreement thereto by Assael Architecture Limited.

DRAWING NOTES

E-FILE REF N°		A2413 Working Elevations			
STATUS	REVISION	DATE	DRN	CHK	CDM
P15	PLANNING SUBMISSION	20.01.14	KS	LW	--

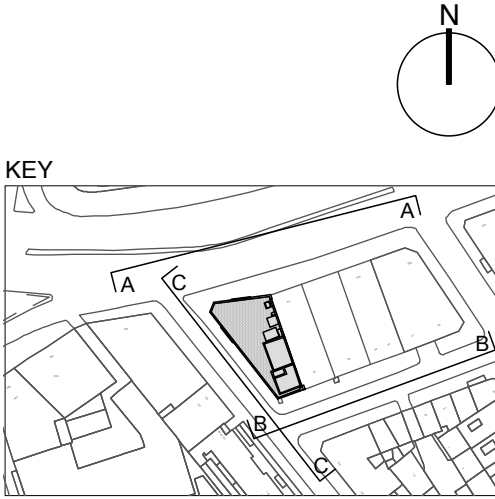

CLIENT

S2 Estates (Euston Road) LLP

PROJECT TITLE

373-375 Euston Road

DRAWING TITLE

**Proposed North Elevation
AA**

SCALE @ A1 SIZE / A3 SIZE

1:200 / 1:400

DATE

July '13

DRAWING N°

A2413 400

STATUS & REVISION

P15

Assael

Assael Architecture Limited
Studio 13
50 Carnwath Road
London SW6 3EG

T +44 (0) 20 7736 7744
F +44 (0) 20 7736 6677
E info@assael.co.uk
W www.assael.co.uk

GENERAL NOTES

All setting out must be checked on site
All levels must be checked on site and refer to
Ordnance Datum Newlyn unless alternative Datum given
All fixings and weathervings must be checked on site
All dimensions must be checked on site
This drawing must not be scaled
This drawing must be read in conjunction with all other
relevant drawings and specification clauses
This drawing must not be used for land transfer purposes
Calculated areas in accordance with Assael Architecture's
Definition of Areas for Schedule of Areas
This drawing must not be used on site unless issued for
construction
Subject to survey, consultation and approval from all
statutory Authorities

Revision Status:
P=Preliminary C=Contract

© 2013 Assael Architecture Limited

Assael Architecture Limited has prepared this document in
accordance with the instructions of the Client under the agreed
Terms of Appointment. This document is for the sole and specific use
of the Client and Assael Architecture shall not be responsible for any
use of its contents for any purpose other than that for which it was
prepared and provided. Should the Client require to pass electronic
copies of the document to other parties, this should be for
co-ordination purposes only, the whole of the file should be so
copied, but no professional liability or warranty shall be extended to
other parties by Assael Architecture in this connection without the
explicit written agreement thereto by Assael Architecture Limited.

DRAWING NOTES

E-FILE REF N°		A2413 Working Elevations			
STATUS	REVISION	DATE	DRN	CHK	CDM
P15	PLANNING SUBMISSION	20.01.14	KS	LW	--

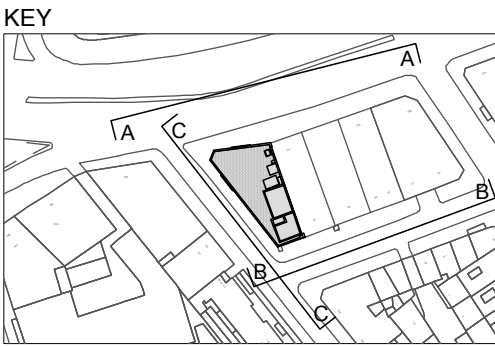

CLIENT

S2 Estates (Euston Road) LLP

PROJECT TITLE

373-375 Euston Road

DRAWING TITLE

**Proposed South Elevation
BB**

SCALE @ A1 SIZE / A3 SIZE	DATE
1:200	July '13
DRAWING N°	STATUS & REVISION
A2413 401	P15

Assael

Assael Architecture Limited
Studio 13
50 Carmwath Road
London SW6 3EG

T +44 (0) 20 7736 7744
F +44 (0) 20 7736 6677
E info@assael.co.uk
W www.assael.co.uk

GENERAL NOTES

All setting out must be checked on site
All levels must be checked on site and refer to
Ordnance Datum Newlyn unless alternative Datum given
All fixings and weathervings must be checked on site
All dimensions must be checked on site
This drawing must not be scaled
This drawing must be read in conjunction with all other
relevant drawings and specification clauses
This drawing must not be used for land transfer purposes
Calculated areas in accordance with Assael Architecture's
Definition of Areas for Schedule of Areas
This drawing must not be used on site unless issued for
construction
Subject to survey, consultation and approval from all
statutory Authorities

Revision Status:
P=Preliminary C=Contract

© 2013 Assael Architecture Limited

Assael Architecture Limited has prepared this document in
accordance with the instructions of the Client under the agreed
Terms of Appointment. This document is for the sole and specific use
of the Client and Assael Architecture shall not be responsible for any
use of its contents for any purpose other than that for which it was
prepared and provided. Should the Client require to pass electronic
copies of the document to other parties, this should be for
co-ordination purposes only, the whole of the file should be so
copied, but no professional liability or warranty shall be extended to
other parties by Assael Architecture in this connection without the
explicit written agreement thereto by Assael Architecture Limited.

DRAWING NOTES

E-FILE REF N°		A2413 Working Elevations			
STATUS	REVISION	DATE	DRN	CHK	CDM
P15	PLANNING SUBMISSION	20.01.14	KS	LW	--

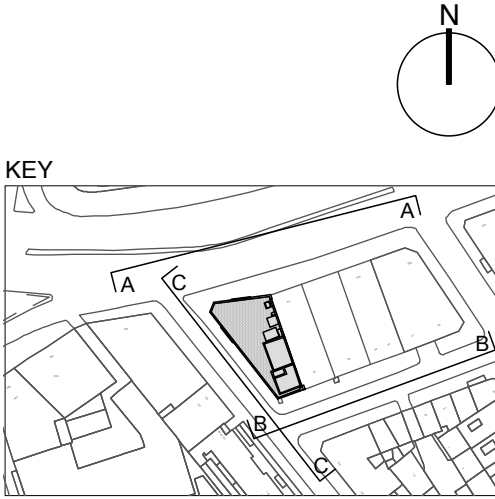

CLIENT

S2 Estates (Euston Road) LLP

PROJECT TITLE

373-375 Euston Road

DRAWING TITLE

**Proposed West Elevation
CC**

SCALE @ A1 SIZE / A3 SIZE

1:200 / 1:400

DRAWING N°

A2413 402

DATE

July '13

STATUS & REVISION

P15

Assael

Assael Architecture Limited
Studio 13
50 Carmwath Road
London SW6 3EG

T +44 (0) 20 7736 7744
F +44 (0) 20 7736 6677
E info@assael.co.uk
W www.assael.co.uk