

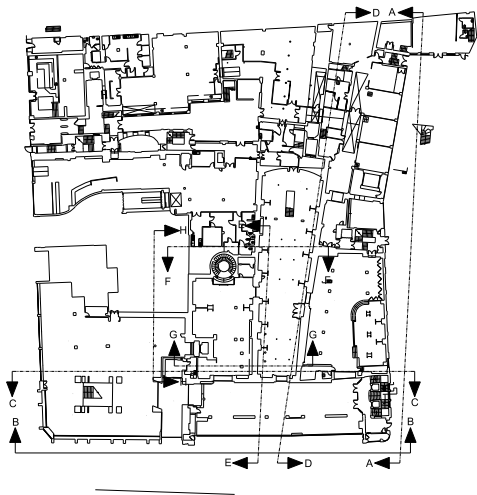

Section C



KEY TO WORKS TO WINDOWS

- Existing timber windows to be replaced
- Existing steel windows to be refurbished
- Existing steel rooflights to be refurbished
- Existing aluminium windows to be replaced

REV.	DESCRIPTION	DATE	DRN BY	CKD BY
------	-------------	------	--------	--------

PROJECT	Heals Refurbishment Phase 2	JOB No.	5354	DRAWING No.	P(0)172	REVISION	-
TITLE	Section C - Tottenham Court Road Window Application	SCALE	1:200 @ A3	DRAWN BY	AR	CHECKED BY	MB
CLIENT	Threadneedle Property Investments Ltd	STATUS	Planning			DATE	December 2014

j**marchitects**

2nd Floor
Threeways House
40-44 Clipstone Street
London
W1W 5DW

T: 0207 580 5330
F: 0207 436 5348
lon@jmarchitects.net
www.jmarchitects.net