

# 1:250 Means of Escape Principle and Secondary shown in Green

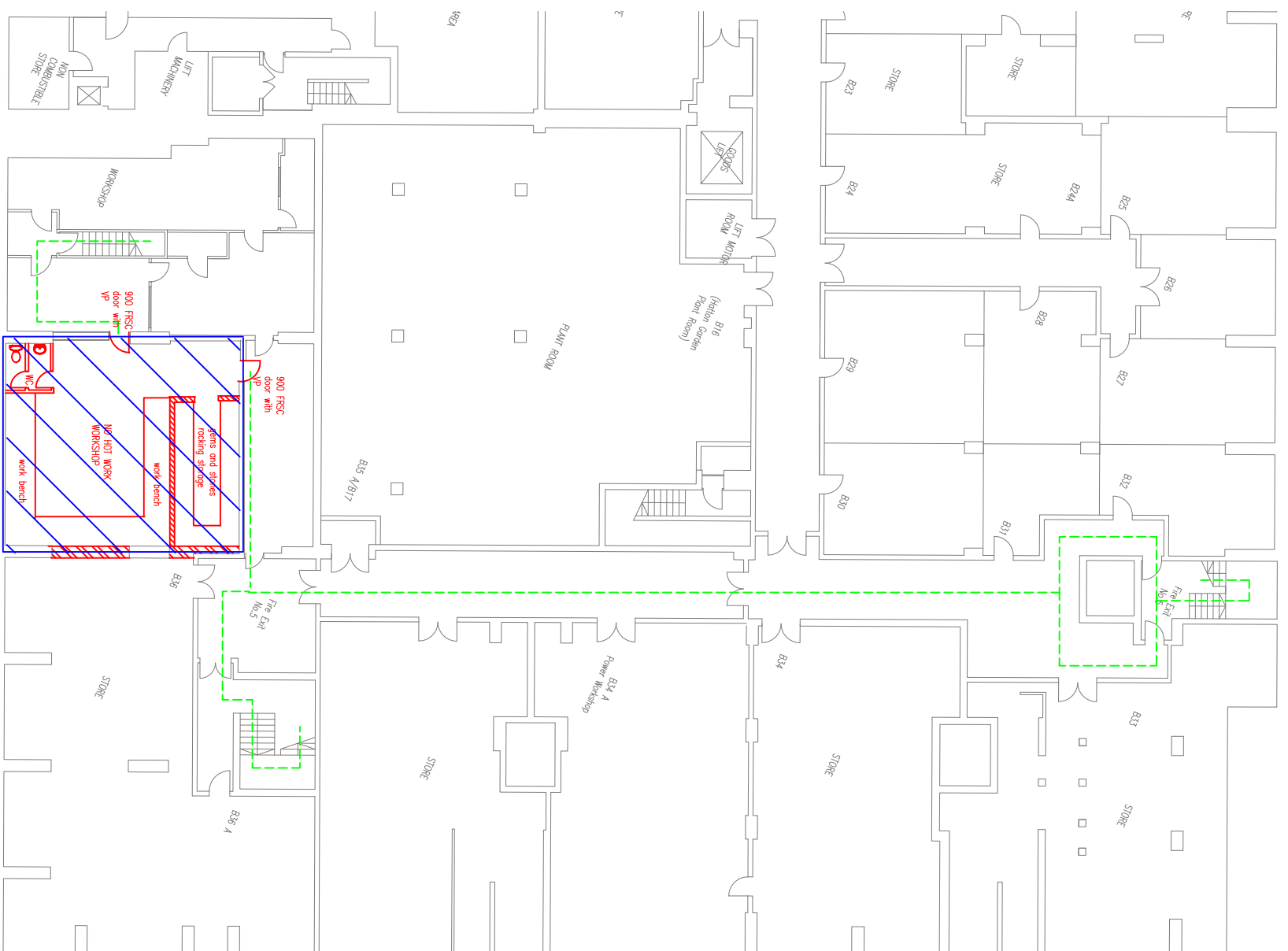

### DESIGN NOTES

- 1 DAYLIGHT FLOURSECENT LIGHTING TO WORKING PLAN TO COMPLY B REGS
- 2 AIR INTAKE AND EXTRACT VIA LANDLORDS VENTILATION SYSTEM TO COMPLY WITH B REGS
- 3 MEANS OF ESCAPE FIRE DOORS AND EMERGENCY LIGHTS TO COMPLY WITH B REGS INCLUDING LINKAGE TO SPRINKLER FIRE MANAGEMENT SYSTEM

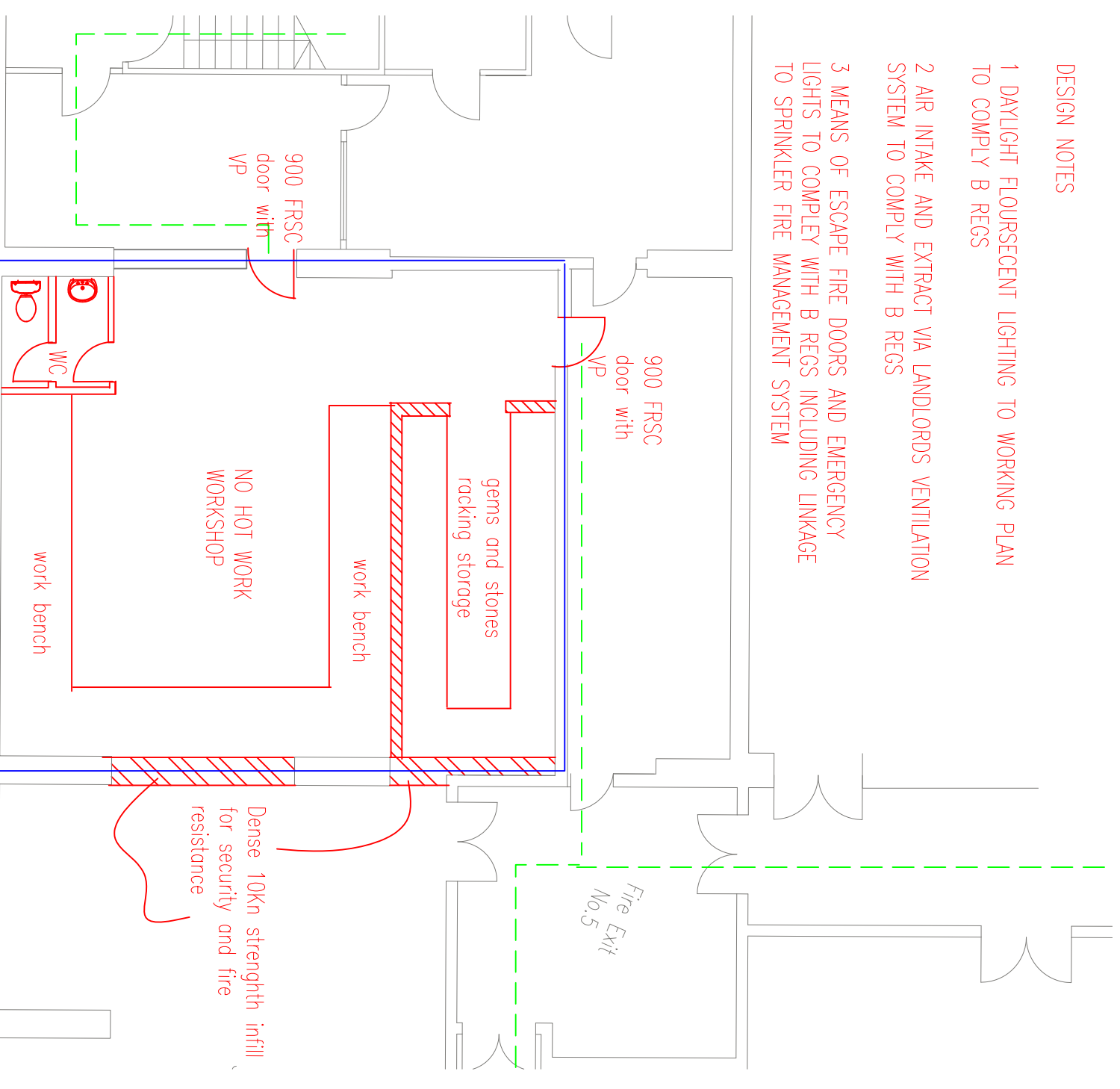

## 1:100 Proposed GA Layout + Use

**CHANGE OF USE APPLICATION AT BASEMENT LEVEL**  
**Drawing No 98-003 PROPOSED GA AND ESCAPE**

**Print at A3**

Address **98 HATTON GARDEN LONDON EC1N 8NX**  
**PROPOSED LAYOUT GA AND ESCAPE**

DATE  
**FEB 2015**

Scale  
**SEE NOTE**