

ELEVATION A - EXISTING

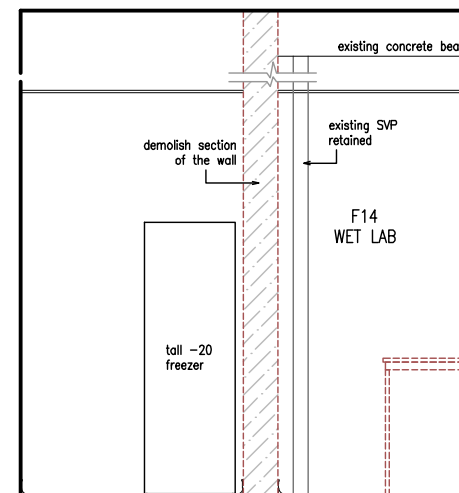

ELEVATION B - EXISTING

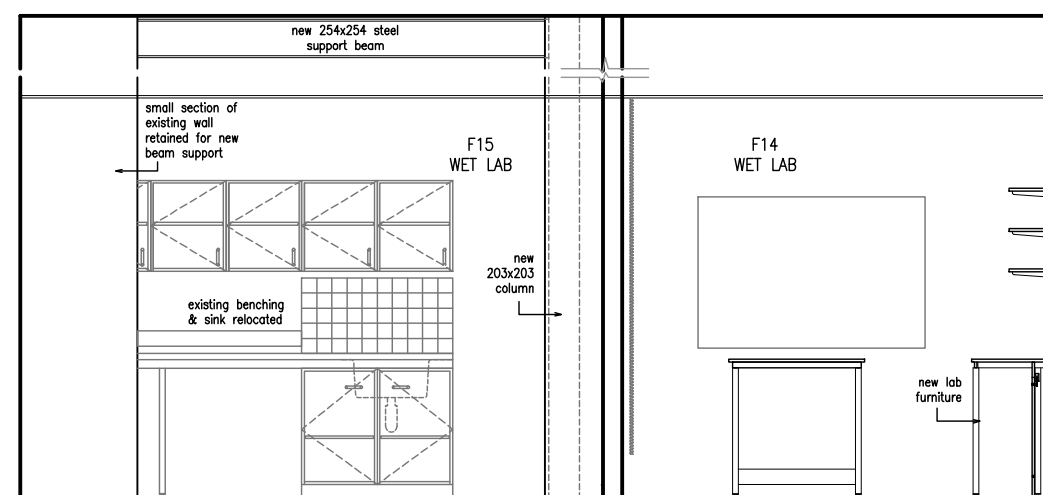

ELEVATION A - PROPOSED

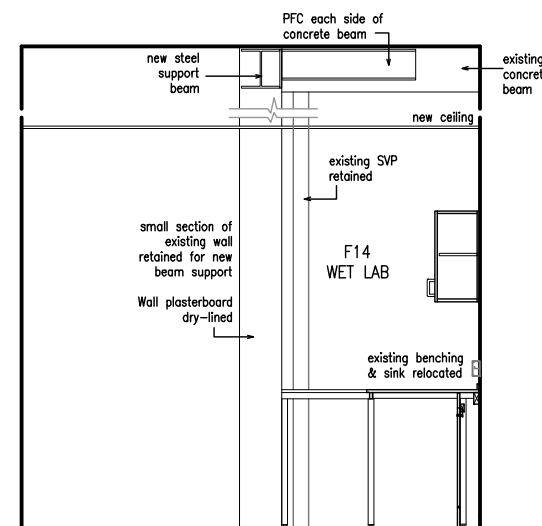

ELEVATION B - PROPOSED

WILSON MASON

Wilson Mason LLP - Chartered Architects - www.wilsonmason.co.uk
 3 Chandos Street, Cavendish Square, London W1G 9JU T 020 7637 1501

This drawing is to be read in conjunction with all relevant consultants' and specialists' drawings.
 Notify the Contract Administrator of any discrepancies before proceeding.
 Do not scale from this drawing. All dimensions are to be checked on site. This drawing is subject to copyright.

client University College London
 project Physics Refurbishment

drawing PROPOSED F14-F15 ELEVATIONS

1:50 at A3

Stage A/B 5923 - TP- L(2)-01

rev

-