

GENERAL NOTES:
The contractor shall be responsible for all health and safety measures necessary to ensure safety of personnel and stability of the structures/ground.

Method statements should be issued for approval of the Sd prior to commencement.

The contractor should take all reasonable steps to prevent damage to the existing services, its operation and the general public.

Safety barriers are to be provided to prevent public access to the area of the works.

The contractor shall provide all necessary plant to allow the excavations to be carried out safely.

Where mechanical diggers are used the Contractor shall allow for suitably qualified personnel to prevent damage to existing services and operations.

After completion of the boreholes they are to be back filled with excavated materials and enclosed with fresh material as for existing.

REQUIREMENT FOR ADDITIONAL SITE INVESTIGATION.

The object of carrying out the additional investigation is to supplement the existing 3 boreholes which show that the ground at the site is consistently London Clay and that there is little variation in soil strength across the site. The additional investigation must address the issues and criticisms raised by the C&C in their report.

It is proposed that there is one additional borehole which is to be carried out at a depth of 10m. This is to be carried out at a depth of 10m.

In order to examine in detail the condition of the ground near to the surface it is proposed that the contractor shall install a series of 3 boreholes at 10m depth. Drilled samples are to be taken between these. Beyond 5 metres depth the U100s shall be taken at 10 metre intervals and SP1s between the samples at 1 metre intervals to 10 metres depth and 1.5 metre intervals beyond that. Drilled samples to be retained from SP1s.

Allowance should be made for the installation of a granthipe at a depth of 6 metres below ground level.

The work is to be supervised by chartered geologist or engineer (or to be provided).

The samples are to be taken back to the lab immediately and sampled under the supervision of C&C and an agreed log returned. Samples will be photographed after testing.

An allowance is to be made for undertaking unconsolidated undrained tests on 100 mm samples on 15 undisturbed samples.

It is suggested that a number of test pits are dug to examine the existing foundations and the near surface soil conditions, particularly along the right boundary. This will help in defining the conditions with respect to drainage. The test pits along the boundaries should be dug to a depth of at least one metre and should be photographed and tagged by a suitably qualified engineer.

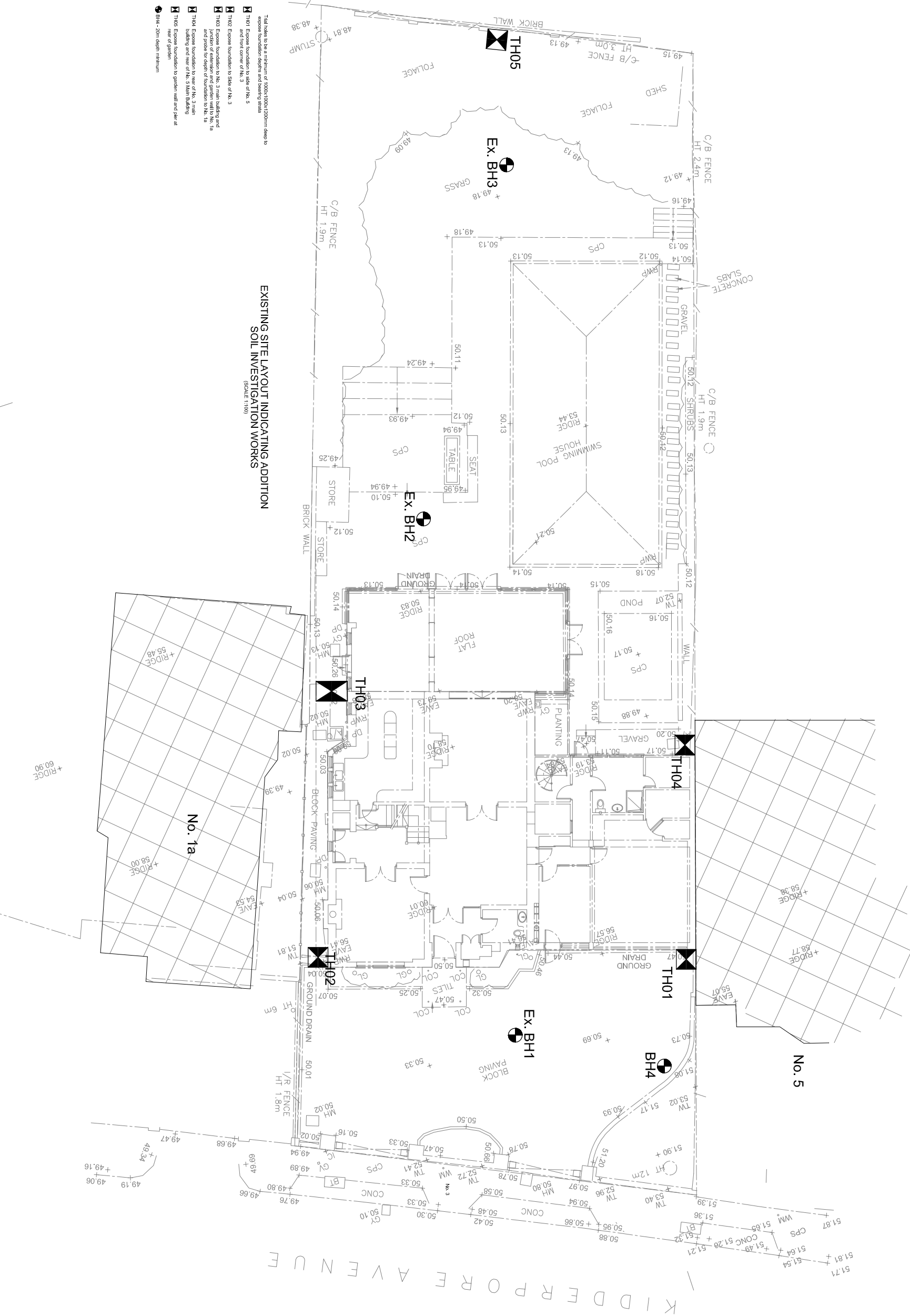

EXISTING SITE LAYOUT INDICATING ADDITION SOIL INVESTIGATION WORKS
(SCALE 1:100)

- TH01 to be a minimum of 1000x1000x1200mm deep to expose foundation depths and bearing areas
- TH01 Expose foundation to side of No. 5 and front corner of No. 3
 - TH02 Expose foundation to side of No. 3
 - TH03 Expose foundation to No. 3 main building and garden area and probe for depth of foundation to No. 1a
 - TH04 Expose foundation to rear of No. 3 main building and rear of No. 5 Main Building
 - TH05 Expose foundation to garden wall and rear of rear of garden
 - BH4 - 20m depth minimum

3 KIDDERPORE AVENUE LONDON NW3 7SX

FOR CONSTRUCTION (D&B)

EXISTING SITE LAYOUT INDICATING ADDITION SOIL INVESTIGATION WORKS

Scale at A1		Date	Drawn By
1:100		31.01.11	GB
Project No.	Dwg No.	Rev.	
8148	SI-02	A	