

Basement:
300 RC walls, slab over and slab below.

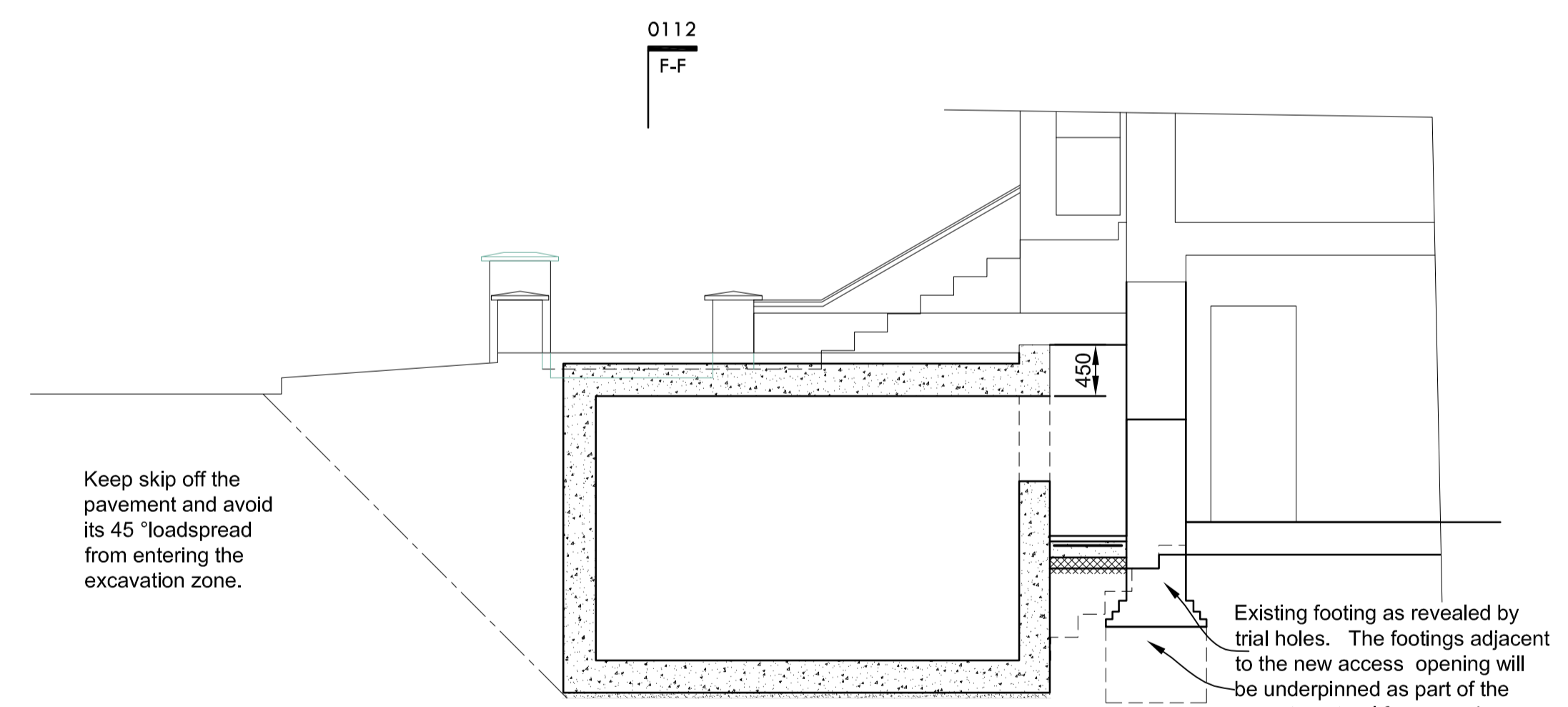

A - A

NOTES		
1 This drawing is to be read in conjunction with the Architects drawings and the project specification. Do not scale off the drawing.	3 All timber is to be C16 grade and tanalised. Paint all cut ends with timber preservative, on site.	5 All concrete (except blinding concrete) is to be minimum 35 N/mm ² with 20 diameter aggregate and is to be mechanically vibrated, when placed. All concrete work must comply with BS 8110.
2 All steelwork is to be grade S275, shot blasted and painted with 2 coats of zinc phosphate primer or red oxide primer. All bolts are to be grade 8.8. All fabrication is to be done in accordance with BS5950.	4 All brickwork is to be 20.5 N/mm ² in 1:1:6 mortar unless used as an external facing brick. All blockwork is to be 3.5 N/mm ² in 1:1:6 mortar. All unless noted otherwise on drawing.	6 The Contractor must provide full details of their proposed temporary works, before commencing the structural works.

Cooper Associates

CONSULTING CIVIL AND STRUCTURAL ENGINEERS

6 Bartholomew Place
LONDON, EC1A 7HH

Tel: 020 7606 0192 post@engcooper.com
Fax: 020 7606 2896 www.engcooper.com

ARCHITECT	Nagan Johnson Architects
PROJECT	16 Provost Road, London NW3 4ST

DRAWING TITLE											
Front Basement SECTIONS											
ISSUE STATUS	<table border="1"> <tr> <td>Preliminary</td> <td>Information</td> <td>Tender</td> <td>For Use</td> <td>Record</td> </tr> <tr> <td><input type="checkbox"/></td> <td><input type="checkbox"/></td> <td><input type="checkbox"/></td> <td><input type="checkbox"/></td> <td><input type="checkbox"/></td> </tr> </table>	Preliminary	Information	Tender	For Use	Record	<input type="checkbox"/>	<input type="checkbox"/>	<input type="checkbox"/>	<input type="checkbox"/>	<input type="checkbox"/>
Preliminary	Information	Tender	For Use	Record							
<input type="checkbox"/>	<input type="checkbox"/>	<input type="checkbox"/>	<input type="checkbox"/>	<input type="checkbox"/>							
DRAWN	CHECKED										
A.W.	DEC '13										
DRAWING NUMBER	REVISION										
CA4297/B01	B										

REV.	DATE	DESCRIPTION