

## EQUIPMENT SCHEDULE

REF	MODEL	DESCRIPTION	DIMENSIONS	WEIGHT	POWER	FUSE	PIPE SIZE
			h x w x d	kg		A	
SYS1/AC01	RAV-SM566KRT-E	HIGH LEVEL WALL MOUNTED TYPE AC UNIT	320 x 1050 x 228	12	VIA OUTDOOR	N/A	1/2" + 1/4"
SYS1/OUT1	RAV-SP564ATP-E	SINGLE SPLIT EXTERNAL CONDENSING UNIT	550 x 780 x 290	38	230V/1ph/50Hz	16	1/2" + 1/4"
AHU1	HR200V	VENT AXIA HEAT RECOVERY VENTILATION UNIT	275 x 495 x 373	20	230V/1ph/50Hz	6	N/A
AHU2	HR200V	VENT AXIA HEAT RECOVERY VENTILATION UNIT	275 x 495 x 373	20	230V/1ph/50Hz	6	N/A

This drawing is protected under Copyright and at no time must any portion of this drawing be reproduced or copied in any way, without the permission of Adaptive Cooling Ltd.

All dimensions must be checked on site and NOT scaled from this drawing.

Building parameters taken from drawings provided.

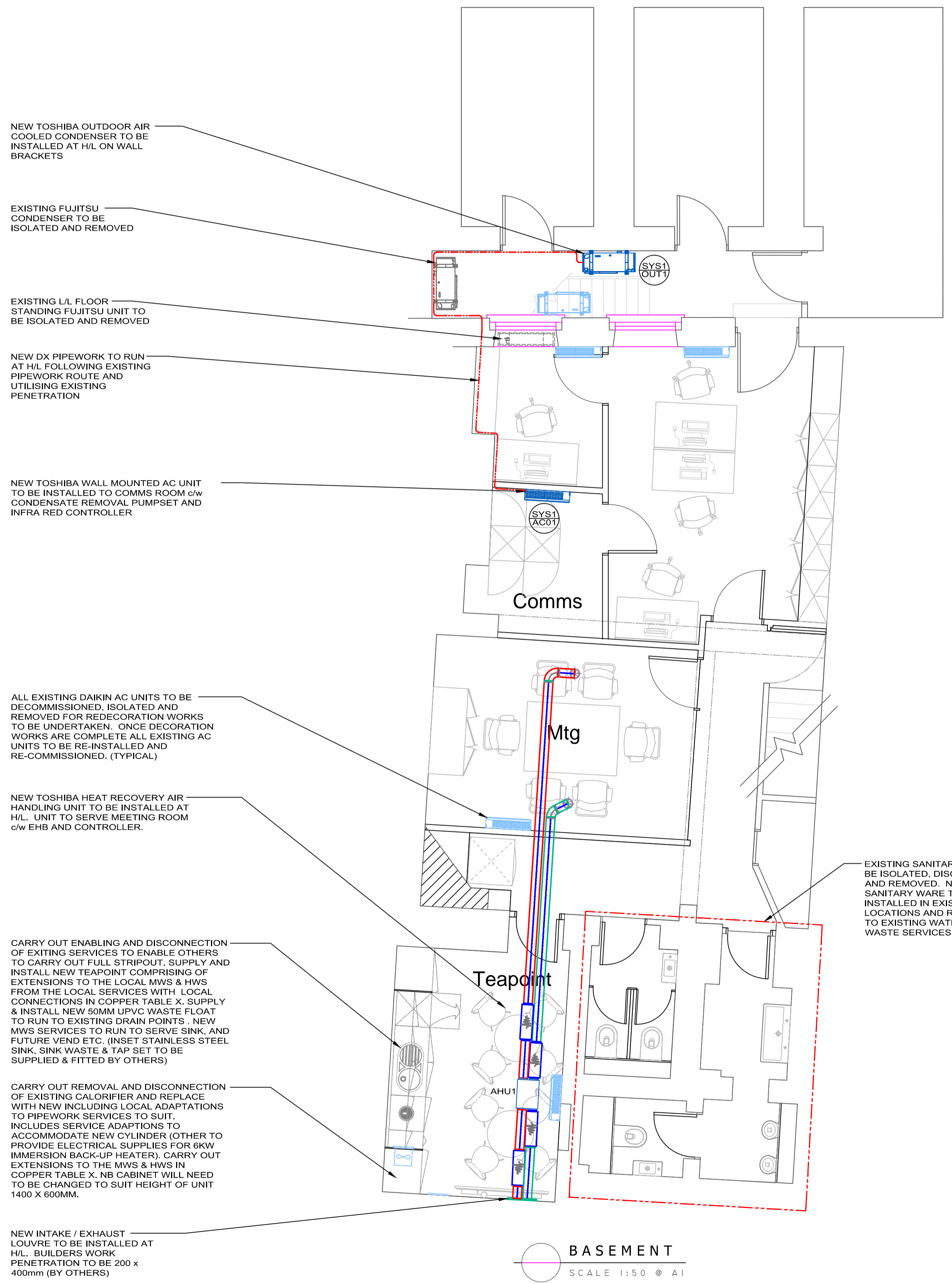

NEW TOSHIBA OUTDOOR AIR COOLED CONDENSER TO BE INSTALLED AT H/L ON WALL BRACKETS

EXISTING FUJITSU CONDENSER TO BE ISOLATED AND REMOVED

EXISTING L/L FLOOR STANDING FUJITSU UNIT TO BE ISOLATED AND REMOVED

NEW DX PIPEWORK TO RUN AT H/L FOLLOWING EXISTING PIPEWORK ROUTE AND UTILISING EXISTING PENETRATION

NEW TOSHIBA WALL MOUNTED AC UNIT TO BE INSTALLED TO COMMS ROOM c/w CONDENSATE REMOVAL PUMPSET AND INFRA RED CONTROLLER

ALL EXISTING DAIKIN AC UNITS TO BE DECOMMISSIONED, ISOLATED AND REMOVED FOR REDECORATION WORKS TO BE UNDERTAKEN. ONCE DECORATION WORKS ARE COMPLETE ALL EXISTING AC UNITS TO BE RE-INSTALLED AND RE-COMMISSIONED. (TYPICAL)

NEW TOSHIBA HEAT RECOVERY AIR HANDLING UNIT TO BE INSTALLED AT H/L. UNIT TO SERVE MEETING ROOM c/w EHB AND CONTROLLER.

CARRY OUT ENABLING AND DISCONNECTION OF EXISTING SERVICES TO ENABLE OTHERS TO CARRY OUT FULL STRIPOUT. SUPPLY AND INSTALL NEW TEAPPOINT COMPRISING OF EXTENSIONS TO THE LOCAL MWS & HWS FROM THE LOCAL SERVICES WITH LOCAL CONNECTIONS IN COPPER TABLE X. SUPPLY & INSTALL NEW 50MM UPVC WASTE FLOAT TO RUN TO EXISTING DRAIN POINTS. NEW MWS SERVICES TO RUN TO SERVE SINK, AND FUTURE VEND ETC. (INSET STAINLESS STEEL SINK, SINK WASTE & TAP SET TO BE SUPPLIED & FITTED BY OTHERS)

CARRY OUT REMOVAL AND DISCONNECTION OF EXISTING CALORIFIER AND REPLACE WITH NEW INCLUDING LOCAL ADAPTATIONS TO PIPEWORK SERVICES TO SUIT. INCLUDES SERVICE ADAPTIONS TO ACCOMMODATE NEW CYLINDER (OTHER TO PROVIDE ELECTRICAL SUPPLIES FOR 6kW IMMERSION BACK-UP HEATER). CARRY OUT EXTENSIONS TO THE MWS & HWS IN COPPER TABLE X. NB CABINET WILL NEED TO BE CHANGED TO SUIT HEIGHT OF UNIT 1400 X 600MM.

NEW INTAKE / EXHAUST LOUVRE TO BE INSTALLED AT H/L. BUILDERS WORK PENETRATION TO BE 200 x 400mm (BY OTHERS)

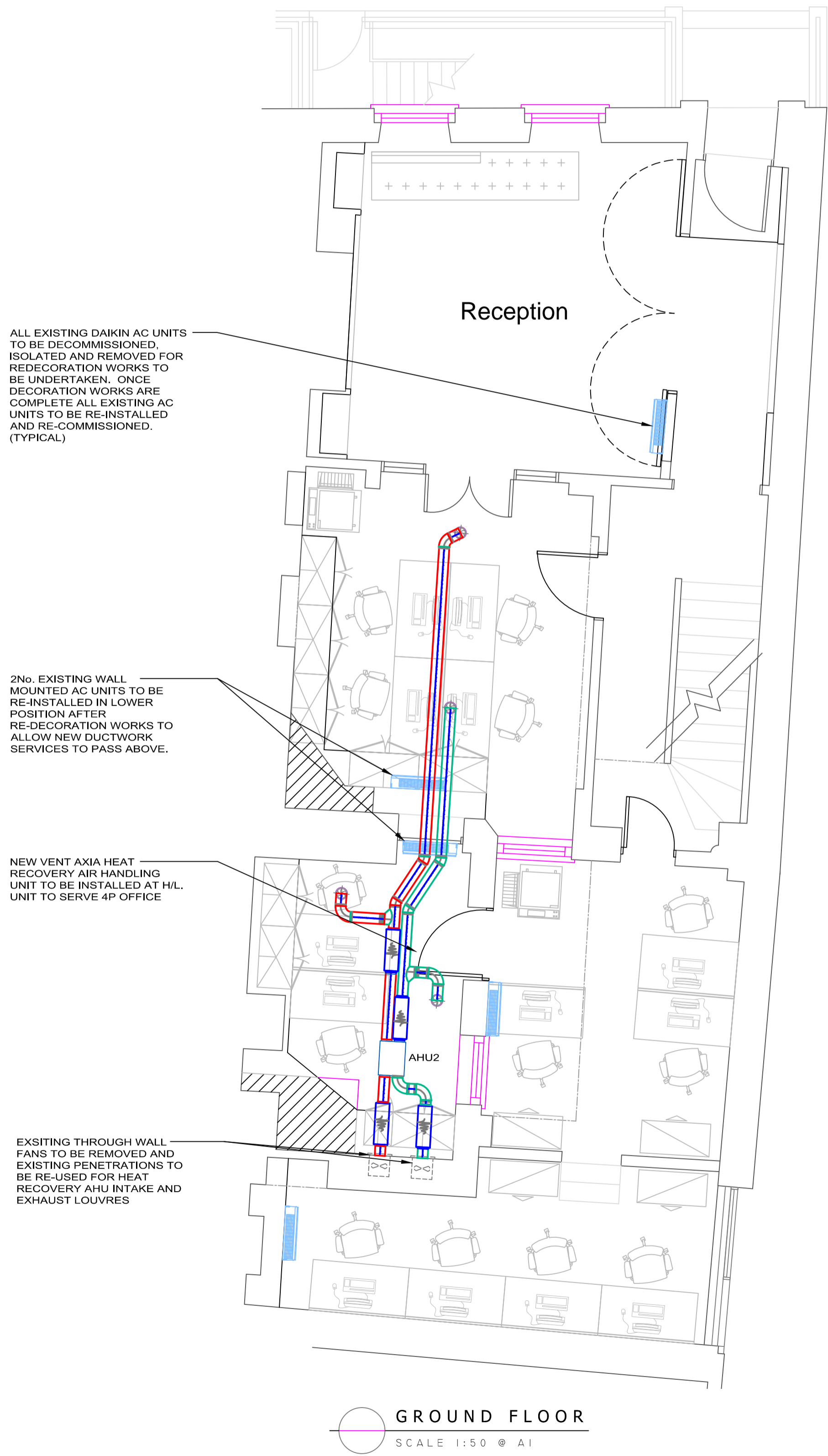

ALL EXISTING DAIKIN AC UNITS TO BE DECOMMISSIONED, ISOLATED AND REMOVED FOR REDECORATION WORKS TO BE UNDERTAKEN. ONCE DECORATION WORKS ARE COMPLETE ALL EXISTING AC UNITS TO BE RE-INSTALLED AND RE-COMMISSIONED. (TYPICAL)

2No. EXISTING WALL MOUNTED AC UNITS TO BE RE-INSTALLED IN LOWER POSITION AFTER RE-DECORATION WORKS TO ALLOW NEW DUCTWORK SERVICES TO PASS ABOVE.

NEW VENT AXIA HEAT RECOVERY AIR HANDLING UNIT TO BE INSTALLED AT H/L. UNIT TO SERVE 4P OFFICE

EXISTING SANITARY WARE TO BE ISOLATED, DISCONNECTED AND REMOVED. NEW SANITARY WARE TO BE INSTALLED IN EXISTING LOCATIONS AND RE-PLUMBED TO EXISTING WATER AND WASTE SERVICES.

EXISTING THROUGH WALL FANS TO BE REMOVED AND EXISTING PENETRATIONS TO BE RE-USED FOR HEAT RECOVERY AHU INTAKE AND EXHAUST LOUVRES

**PRELIMINARY ISSUE**

STATUS	
<span style="background-color: yellow; border: 1px solid black; width: 15px; height: 10px;"></span> Preliminary / Info	<span style="background-color: #ffff00; border: 1px solid black; width: 15px; height: 10px;"></span> Approval / Comments
<span style="background-color: #cccccc; border: 1px solid black; width: 15px; height: 10px;"></span> Contract	<span style="background-color: #cccccc; border: 1px solid black; width: 15px; height: 10px;"></span> As - Built
<span style="background-color: #cccccc; border: 1px solid black; width: 15px; height: 10px;"></span> Construction	<span style="background-color: #cccccc; border: 1px solid black; width: 15px; height: 10px;"></span> Building Control

Rev	Revision	By	Date	Chk'd
T1	FIRST ISSUE OF PRELIMINARY DRAWING	DDB	19.01.15	RW

**ADAPTIVE COOLING** LIMITED  
 TELEPHONE: 01635 873485  
 EMAIL: INFO@ADAPTIVECOOLING.CO.UK

IN CONJUNCTION WITH

**peldonrose**  
 workplaceconsultants

Peldon Rose Limited  
 Staffing House, 42 Worple Road  
 London SW19 4EQ  
 Telephone: 020 8971 7777  
 Facsimile: 020 8971 7799  
 E-mail: design@peldonrose.com web: www.peldonrose.com

Client  
**BACE**

Project  
**16 GREAT JAMES STREET LONDON**

Title  
**BASEMENT & GROUND FLOOR MECHANICAL SERVICES ADDITIONALS AND ALTERATIONS**

Scale	Date	Dsgnr/CAD	Checkd/Date
ACq2059	19.01.15	DDB	RW

Drawing Number				
Project No.	Drawing	Floor	Detail	Revision
ACq2059	M01	B	M	T1