

NOTE
 The general contractor shall be notified of any discrepancies or variations relating to manufacturing and installation. The contractor is to check and check site survey to confirm that design intent can be met and is responsible for environment in which it is to be installed.
 All information is subject to statutory approval & site survey.
 The general contractor is to notify Peldon Rose Limited in writing of all work that are required to be carried out prior to the works.

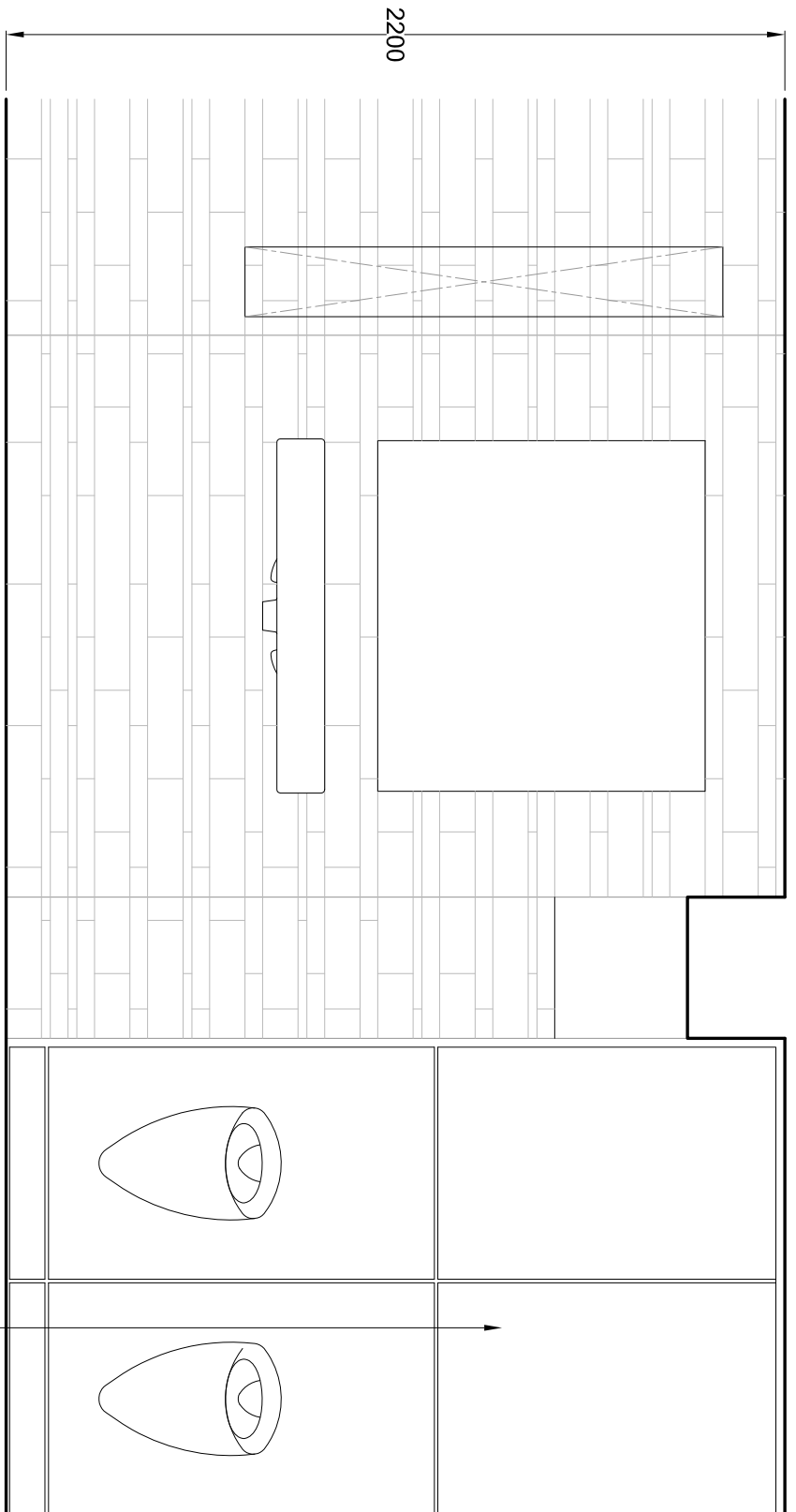

ELEVATION 2
 Scale: 1:20 @ A1

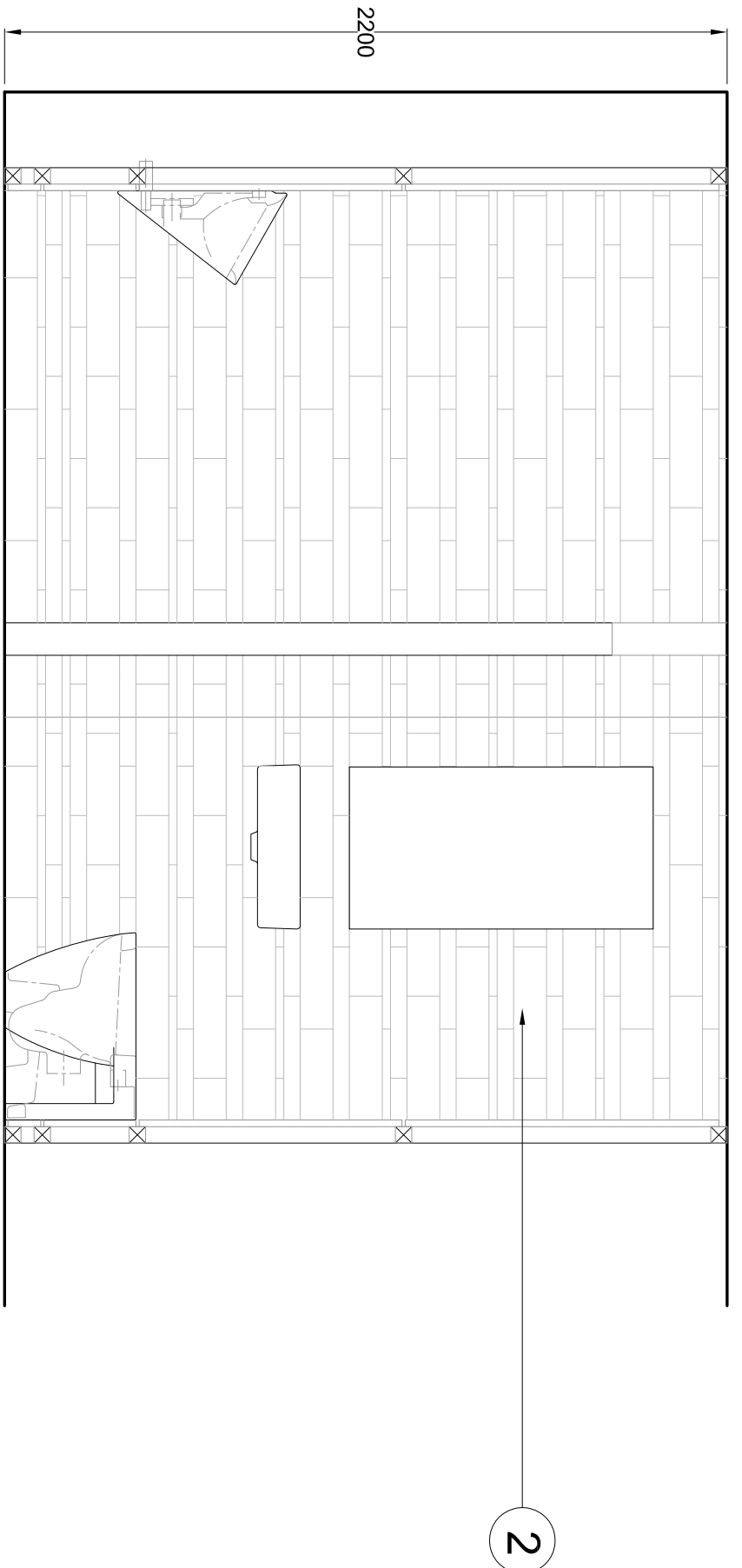

ELEVATION 1
 Scale: 1:20 @ A1

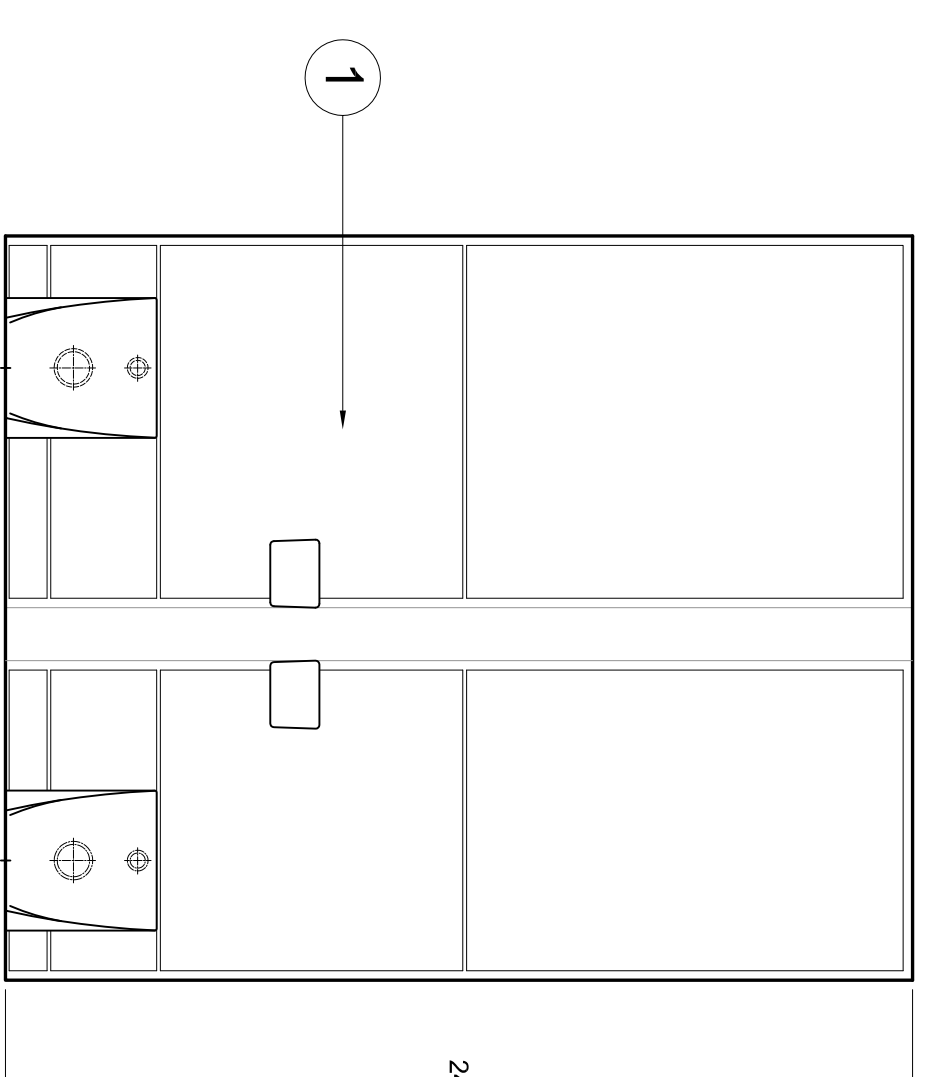

ELEVATION 3
 Scale: 1:20 @ A1

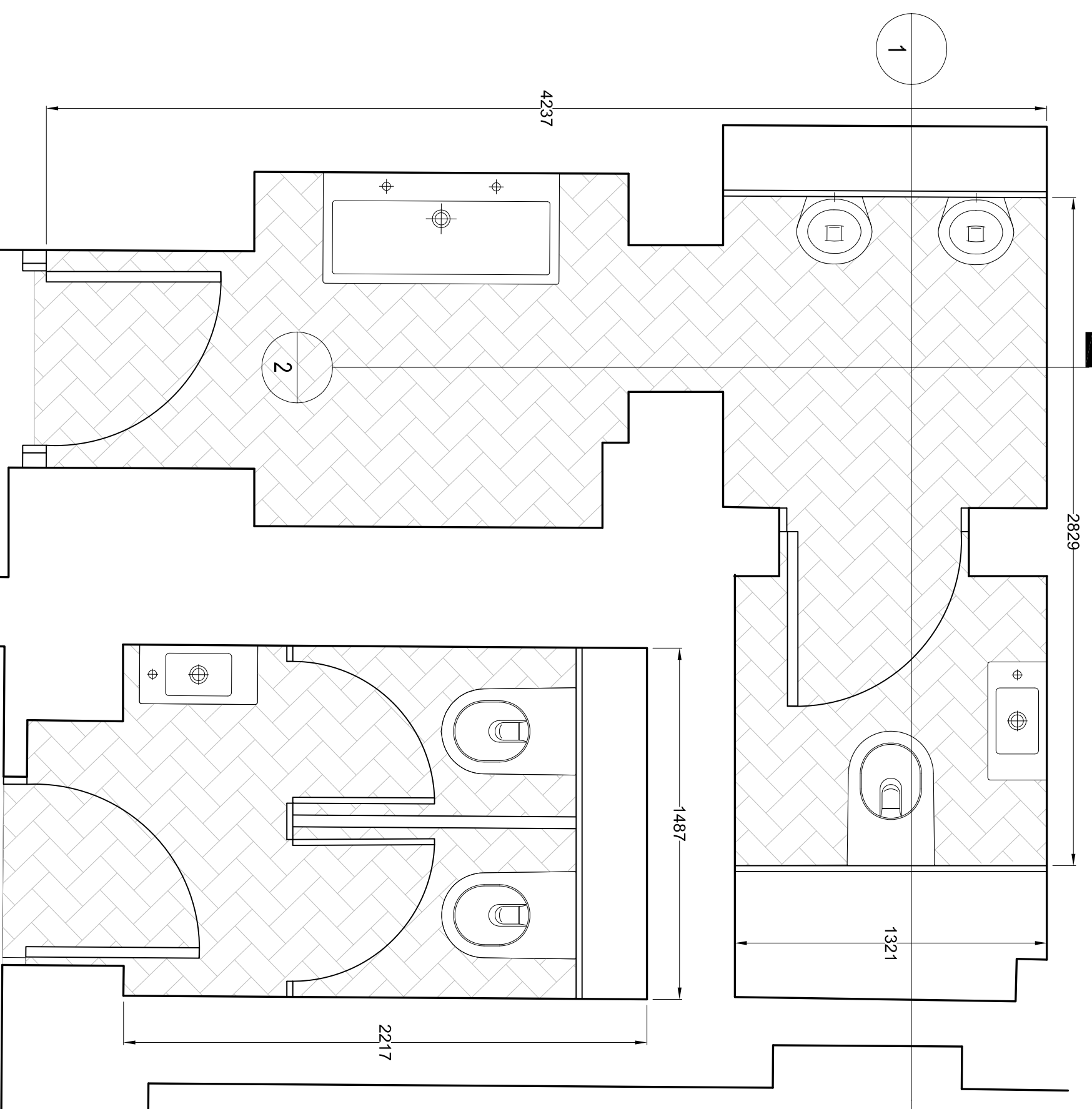

PLAN - LOWER GROUND FLOOR WC'S
 Scale: 1:20 @ A1

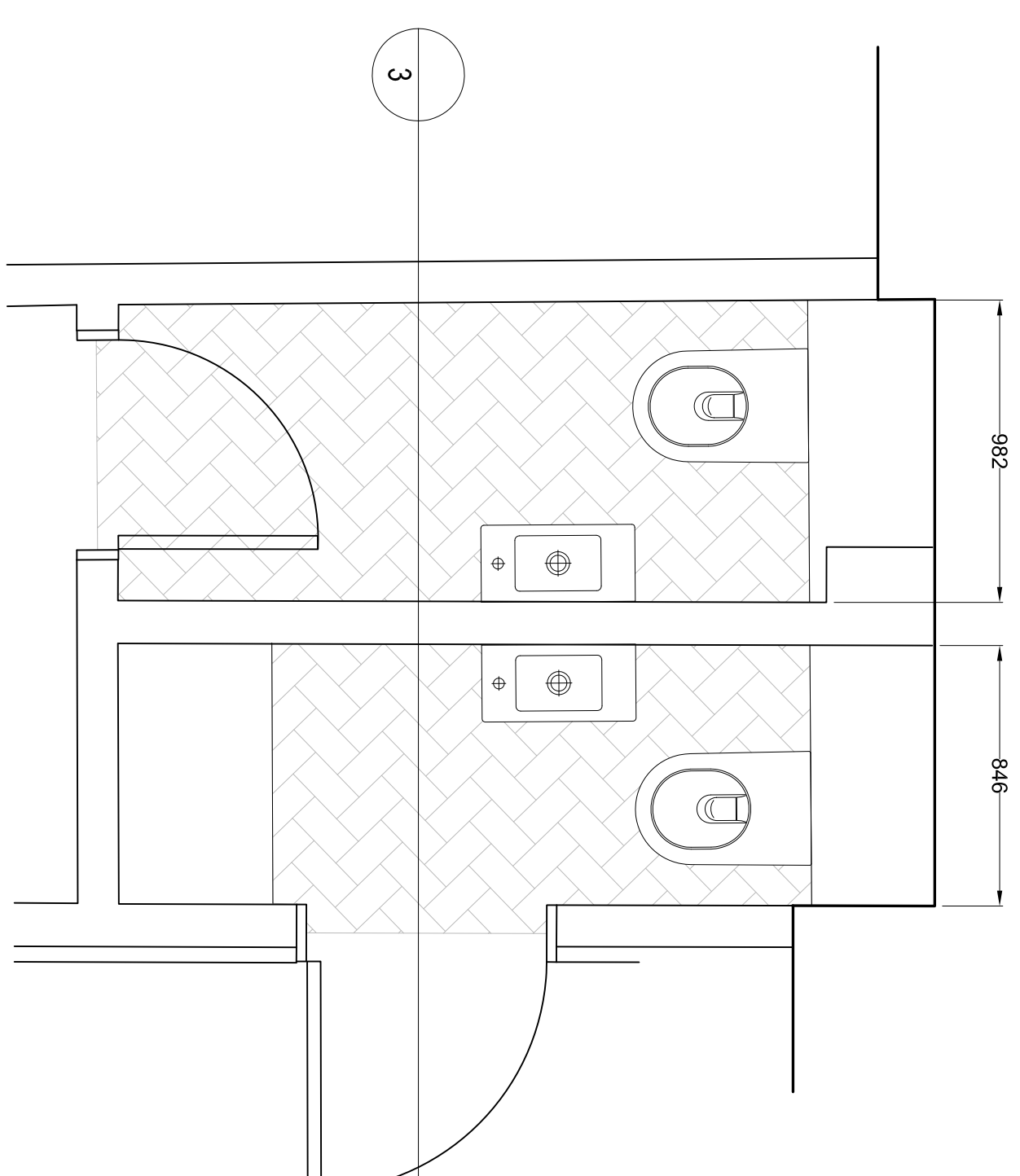

PLAN - THIRD FLOOR WC'S
 Scale: 1:20 @ A1

- FINISHES**
1. Solid Core Laminate IPS System & Cubicles - White
 2. Wall Tiles - Gresitec Viking RNK7443

REV	DATE	DESCRIPTION	BY	CHK
1	04.02.15	Submitted FOR PLANNING	ks	

FOR PLANNING

peldonrose
 workplaceconsultants

Peldon Rose Limited
 Sterling House, 42, Wootton Road, London
 SW18 7TT
 Switchboard: 020 8971 7777
 Fax: 020 8971 7799
 Email: design@peldonrose.com
 peldonrose.com

CLIENT
BACE
PROJECT
 16 GREAT JAMES STREET
 LONDON
 WC1N 3DP

TITLE
 LOWER GROUND & THIRD FLOOR
 PROPOSED WC'S:
 PLANS & ELEVATIONS

DATE	SHEET	DRAWN BY	
03.02.2015	A1	KS	
SCALE	FILE REF.	CHECKED BY	
1:20 @ A1	/	-	
DRAWING NUMBER	FLOOR/TYPE	NUMBER	REVISION
EN1769-PL	40	01	/

This drawing is produced under copyright and at no time should this drawing be reproduced in whole or in part without the permission of Peldon Rose Limited



© COPYRIGHT