

NOTE
 The general contractor is to notify Peldon Rose Limited of any discrepancies or variations relating to setting out prior to manufacturing and construction. The contractor is to carry out checks and ensure that design intent can be met and is responsible for environments in which it is to be installed.
 All information is subject to statutory approval & site survey.
 The general contractor is to notify Peldon Rose Limited in writing of all works that are required to be carried out prior to the works.

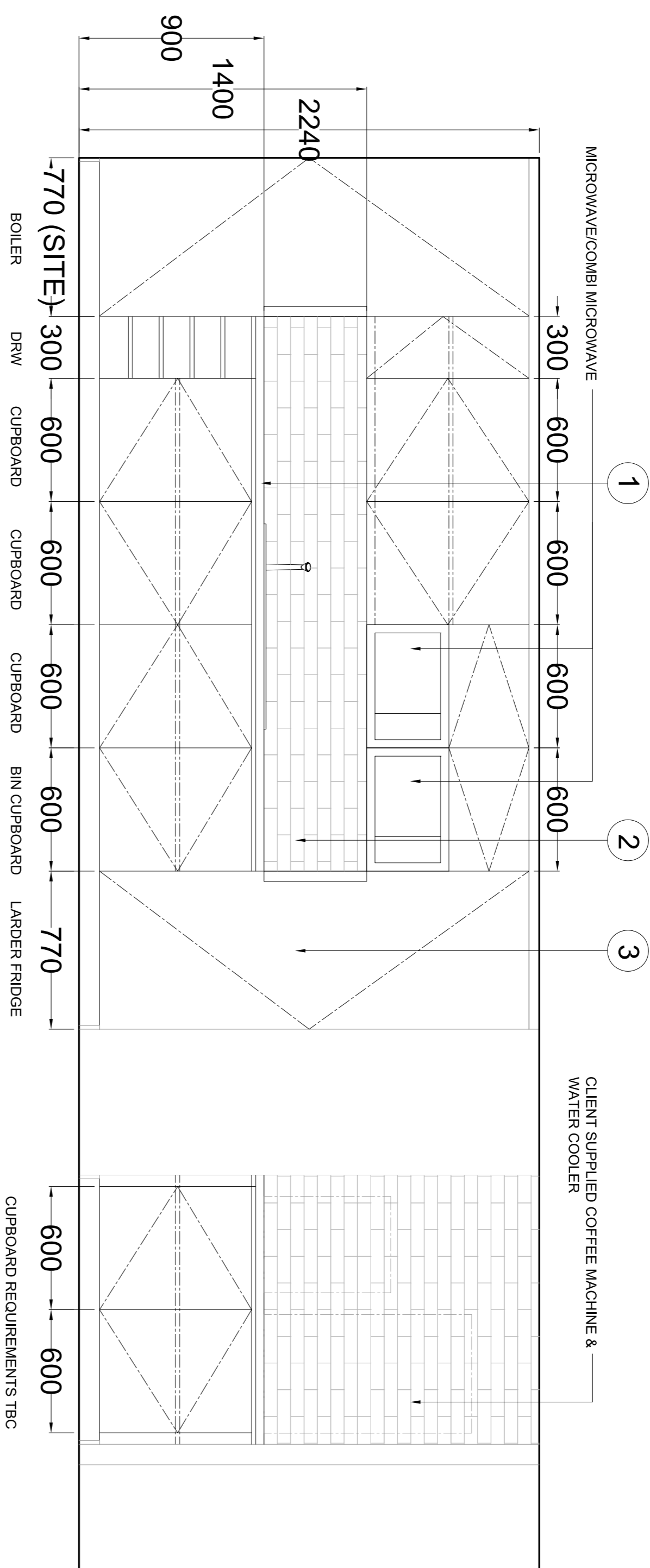

ELEVATION 1
 Scale: 1:20 @ A1

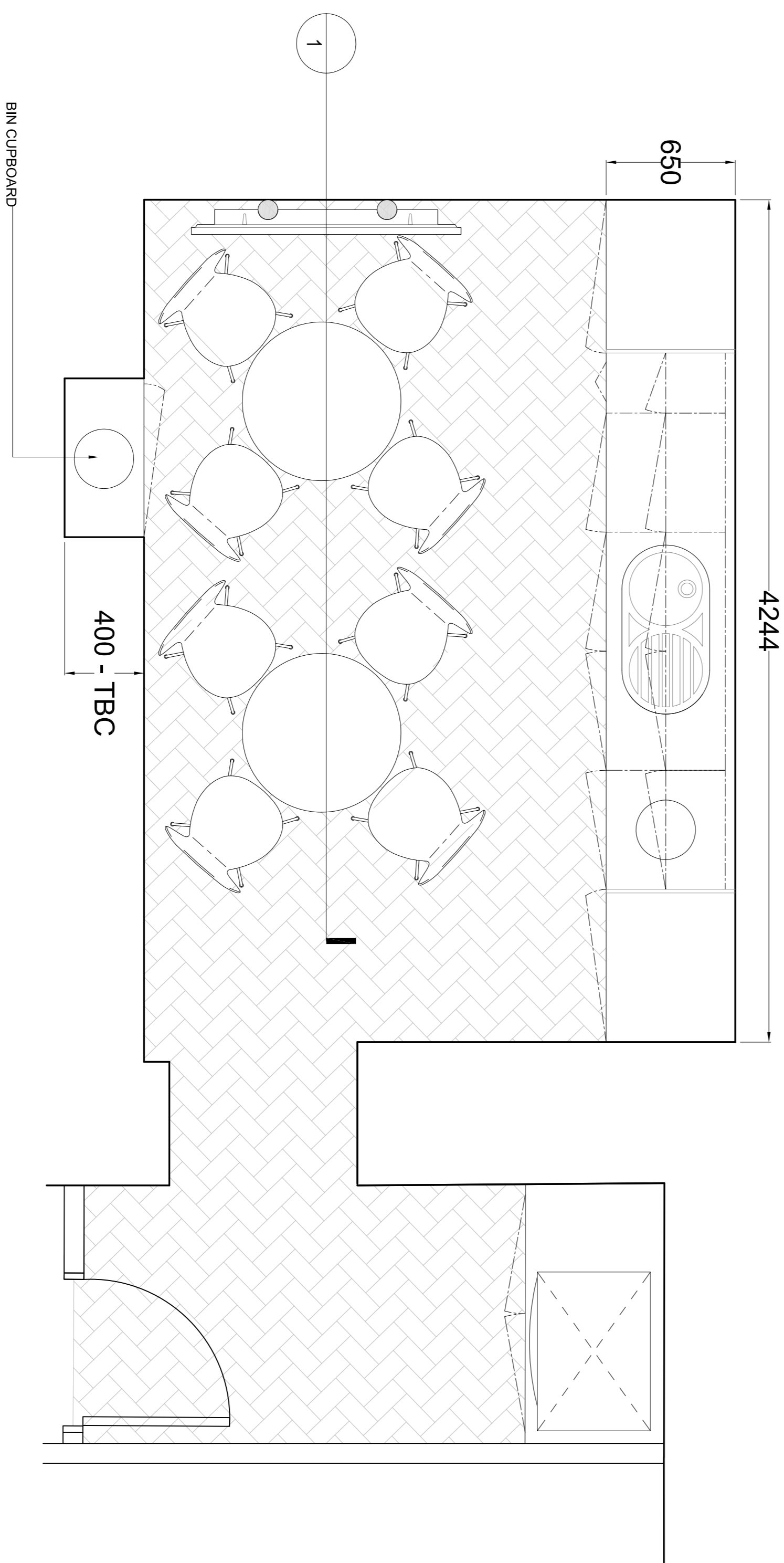

PLAN - LOWER GROUND TEA POINT
 Scale: 1:20 @ A1

- FINISHES**
1. Worktop - Corian 'White Jasmine'
 2. Splashback - Craven Dunhill 'Raku' Bronze B231
 3. Cupboards - Vinyl wrapped gloss 'Cream'

REV	DATE	DESCRIPTION	BY	CHK
1	04.02.15	Submitted FOR PLANNING	ks	

DRAWING STATUS
FOR PLANNING



Peldon Rose Limited
 Sterling House, 42, Woopie Road, London
 SW14 8JH
 Switchboard: 020 8971 1777
 Fax: 020 8971 7799
 Email: design@peldonrose.com
 peldonrose.com

CLIENT
BACE
PROJECT
 16 GREAT JAMES STREET
 LONDON
 WC1N 3DP

TITLE
 LOWER GROUND FLOOR
 PROPOSED TEA POINT:
 PLAN & ELEVATION

DATE	SHEET	DRAWN BY
03.02.2015	A1	KS
SCALE	FILE REF.	CHECKED BY
1:20 @ A1	/	-

DRAWING NUMBER	FLOOR/TYPE	NUMBER	REVISION
EN1769-PL	11	01	/

This drawing is produced under copyright and at no time should this drawing be reproduced in whole or in part without the permission of Peldon Rose Limited
 © COPYRIGHT
 0 1 2 3 4 5 6 7 8 9