

NOTE!
 ALL SETTING OUT DIMENSIONS SHOWN ON THIS DRAWING TO GRID ARE TO BE CHECKED AND VERIFIED ON SITE PRIOR TO ANY BUILDERS WORKS BEING UNDERTAKEN. ANY DISCREPANCIES MUST BE NOTIFIED IMMEDIATELY TO NOVUM SO THAT THE APPROPRIATE ACTION CAN BE TAKEN BEFORE FABRICATION OF THE STEELWORK AND GLASS COMMENCES

NOTES!

1. For Project General Notes Etc Refer To Drawing No DR-100.
2. This Drawing Must Be Read In Conjunction With All Relevant Architects, Engineers, Services And Specialist Manufacturers Drawings And Specifications.
3. For Details Of Structural Steelwork Refer To Crofton Engineering Drawings.

STEELWORK NOTES

- All Steelwork To Be Painted Finish RAL 7038 Matt
- Leigis Paint system D7 for Exposure category C5
- Epoxy Zinc Phosphate Primer w/ DFT of 250 Microns (CA00V3)
- High Performance, Non Metallic, Acrylic Urethane Top Coat with DFT of 75 Microns (C137V2)
- All Welds To Be 6mm Fillet Welds U.N.O
- All welds to be of architectural standard
- All Steel To Be Grade S275JR U.N.O upto 15mm thickness. All to steel over 15mm thickness to be S275J0 U.N.O in accordance with EN10025-2:2004-Part 2

GLASS NOTES

- All Glass To Be 17.5mm Laminated comprising 2no 8mm clear heat strengthened c/w 1.52mm clear interlayer

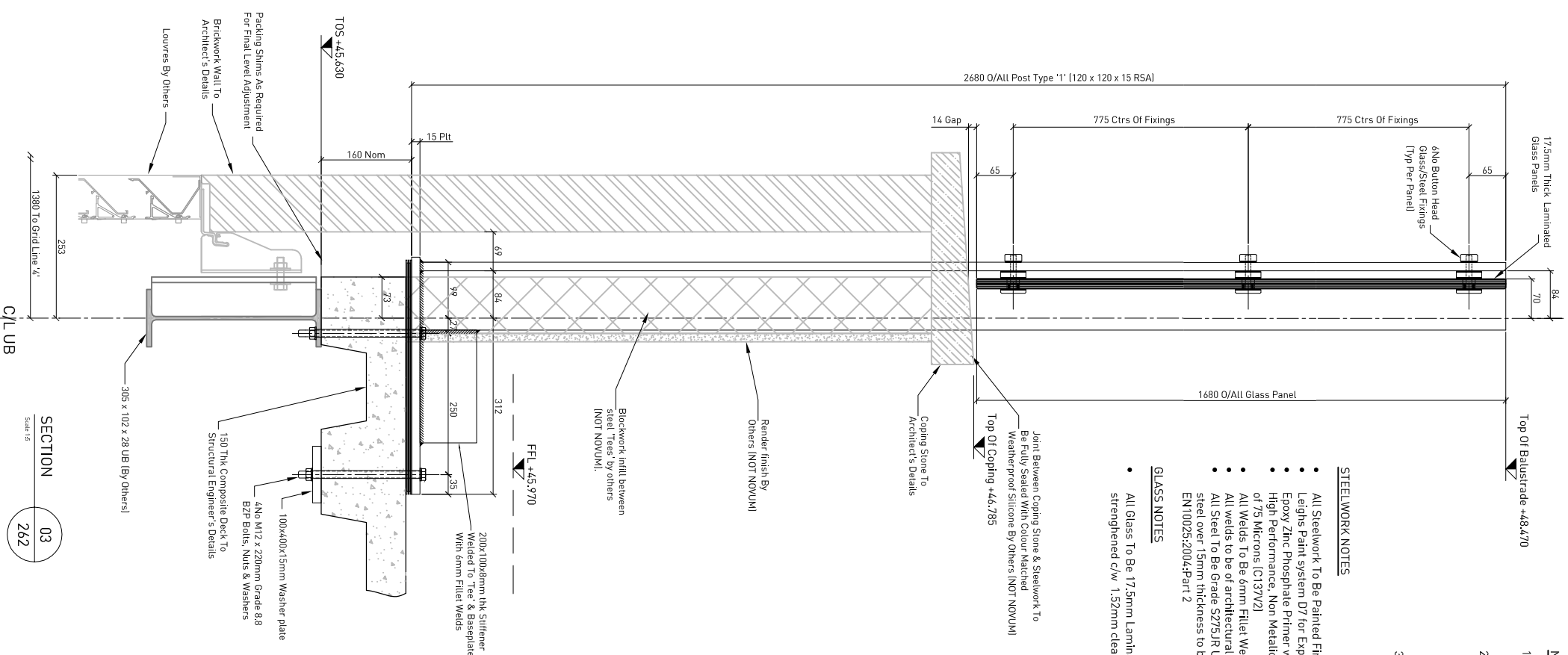
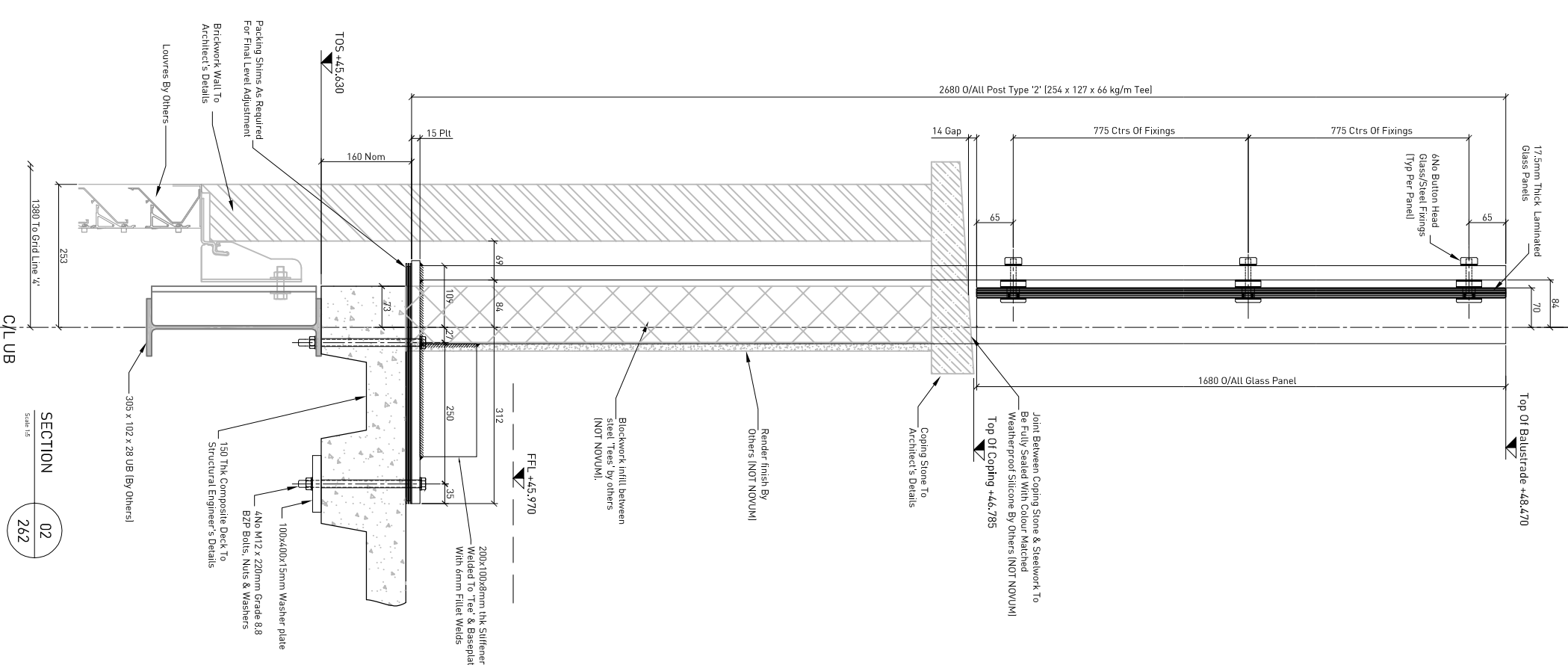
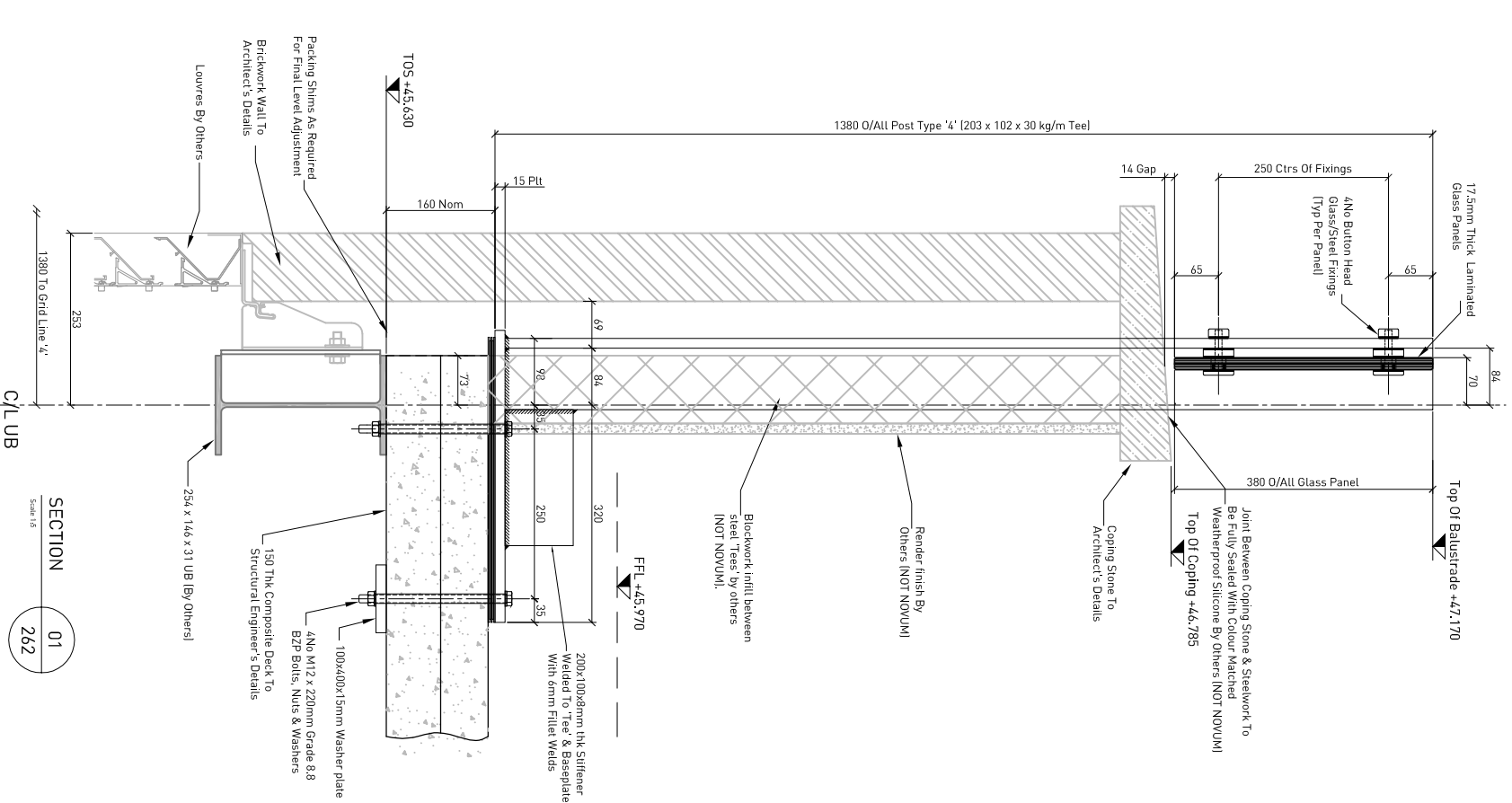

DATE	01.02.13	JW	DR
AS BUILT			
DATE	11.04.12	JW	DR
STEELER & BOLT NOTES ADDED ISSUED FOR CONSTRUCTION			
DATE	05.04.12	JW	DR
BASEPLATE DETAILS ALTERED ISSUED FOR CONSTRUCTION			
DATE	14.03.12	JW	DR
ISSUED FOR CLIENT APPROVAL			
DATE	07.03.12	JW	DR
TOP OF TALLER SCREEN RAISED TO 4870 PAINT COLOUR TO BE FAL 7038 ISSUED FOR CONSTRUCTION			
DATE	14.02.12	JW	DR
DRAWING UPDATED TO SUIT DESIGN TEAM COMMENTS ISSUED FOR APPROVAL			
DATE	02.12.11	DNE	DR
DRAWING UPDATED TO SUIT LATEST DESIGN CALCULATIONS			
DATE	25.11.11	DNE	DR
FIRST ISSUE FOR APPROVAL			
REV/NO.	DATE	DWG BY	CHK BY
Novum Structures UK Ltd			
14 Hopperway			
Diss Business Park			
Diss, Norfolk, IP22 4GT			
T +44 1379 640 040			
www.novumstructures.com			
NOVUM			
SPEC/NO.			
AS BUILT			
PROJECTS			
RCGP			
EUSTON ROAD			
LONDON, UK			
DRAWING DESCRIPTION			
EXTERNAL BALUSTRADES			
LEVEL 5			
SECTIONS			
DATE	DNE		
NOV '11	NOV '11		
CHECKED BY	DR		
NL	NL		
SCALE	1:40 @ A1		
PROJECT NUMBER	S05		
PROJECT TENDER	11-6002		
TENDER NUMBER	262		
NO.	AB1		