

Platanus x hispanica in front of Bespoke Artwork Entrance Gates - Final gate design to be confirmed

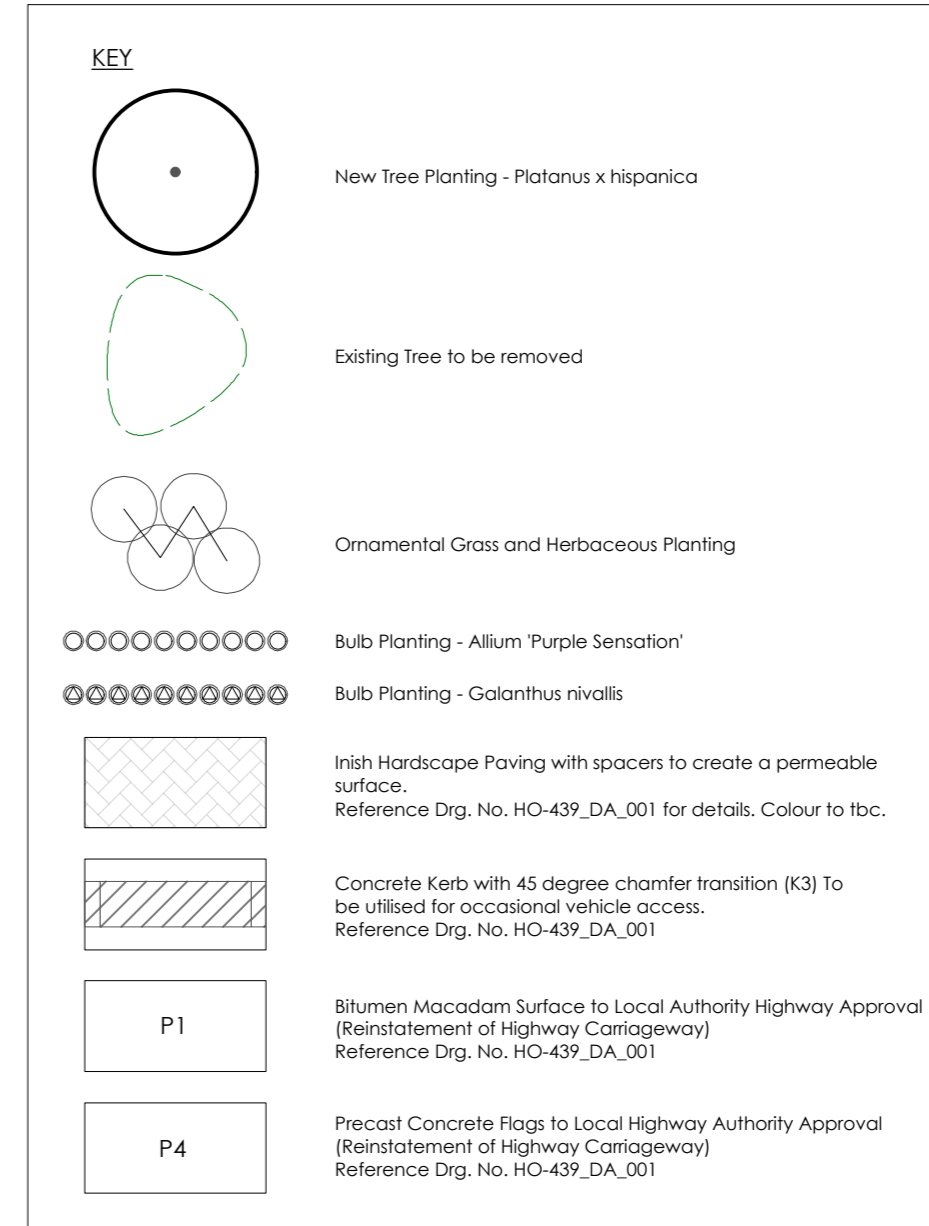

Under planting includes low maintenance evergreen ornamental grasses and herbaceous plants with Allium bulb planting for interest as groundcover becomes established

PLANT SCHEDULE					
Latin Name	Common Name	Scheduled Size	Density	Comment	Quantity
TREE PLANTING					
<i>Platanus x hispanica</i>	London plane	20/25cm girth 5.0-5.5m height	As shown on plan	Root-balled semi-mature tree	4
PERENNIAL AND ORNAMENTAL GRASS PLANTING					
<i>Anemone hybrida</i>	Honourine Jobert	9cm	7	Full pot, fully rooted, healthy crown	56
<i>Campanula persicifolia</i>	Peachleaf Bellflower	2L	5	Full pot, fully rooted, healthy crown	26
<i>Hakonechloa macro 'All Gold'</i>	All Gold Japanese Forest Grass	2L	7	Full pot, fully rooted pot system, healthy clump	30
<i>Luzula sylvatica</i>	Snowy Wood Rush	2L	5	Full pot, fully rooted pot system, healthy clump	41
BULB PLANTING					
<i>Allium 'Purple Sensation'</i>	Purple Allium	12/+	10-15cm sp	Plant 10-15cm deep, 10-15cm apart	70
<i>Galanthus nivalis</i>	Common Snowdrop	04/+	15cm sp	Plant 10-15cm deep, 15cm apart	180



PLANTING NOTES

- All planting to adhere to all the relevant British Standards and Codes of Practice including: BS 3882 Recommendations for topsoil; BS 3938 Part 1 Nursery stock Specification for trees and shrubs; BS 3998 Recommendations for tree work; BS 4043 Recommendations for transplanting root balled trees; BS 4428 Code of Practice for general landscape operations (excluding hard surfaces); BS 5837:2012 Guide for trees in relation to construction; BS 7270 Recommendations for maintenance of soft landscaping; BS 8545: From nursery to independence in the landscape.
- All planting to be carried out with reference to the issued NBS specification 03/03/14.
- The minimum topsoil depth for ornamental grass and herbaceous areas should be 400mm. The minimum topsoil depth for trees should be 600mm.
- Positions of plants shall be ascertained by placing plants at equal distances apart, as located on the planting plan.
- Trees shall be planted in tree pits as detailed in Drg. No. HO-439-200-144.
- On site checks should be made by the engineer to ensure that tree roots will not cause any future damage to any structures or underground services.
- Plants should be supplied exactly true to name, in the event that this is not possible an alternative should be found following consultation with the landscape consultant (Tel: 07990 576 900, email: info@hannahoakden.co.uk)

N.B. To be read in conjunction with Hard Landscape Drg. No. HO-439_DA_001 for hard landscape detail.

Architectural Metalwork Artist to produce fabrication drawings for approval by the Employer.

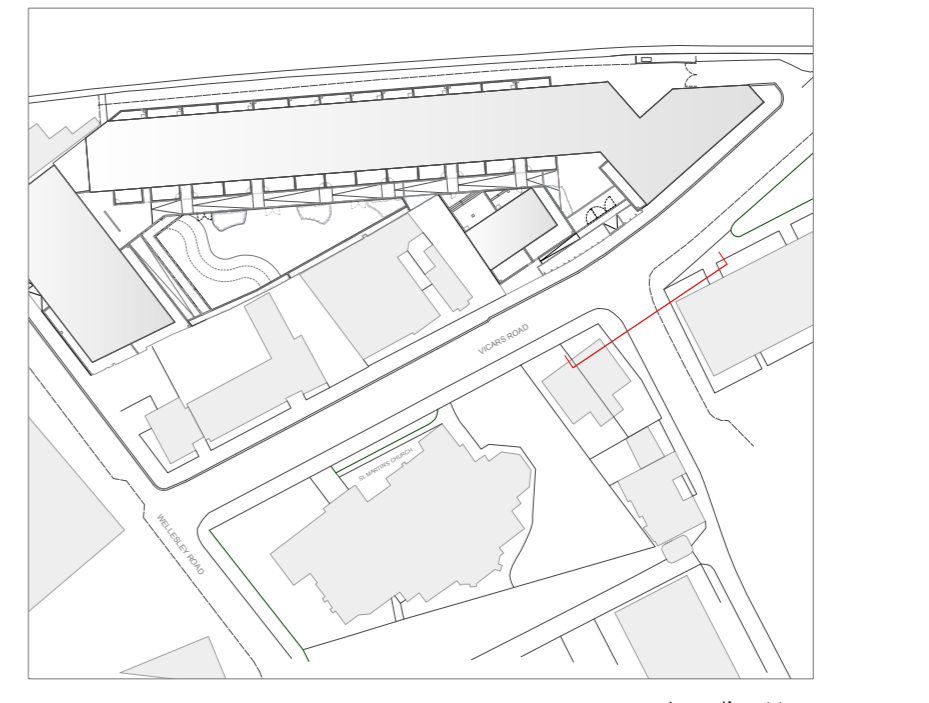

Hannah Oakden Landscape Design
 Hannah Oakden BA (Hons)
 4 Byelow Cottages, Spithurst Road,
 Barcombe, BN8 5EF
 Tel. 07990 576 900
 Email: info@hannahoakden.co.uk

Client: Rydon Construction Ltd

Project: Bacton Low Rise

Title: DHO Gateway Replacement Tree Planting Plan-With Crossover

Drawing no. HO-439-200-115-Op11 Date: 14/01/2014

Scale: 1:50 @A1 Drawn by: HO Rev: 02

Rev 01 28/11/2014
 1. Plant substitution
 Rev 02 14/01/2015
 1. Tree species changed to *Platanus x hispanica* as requested by Tree Officer