

PLEASE NOTE:
 FOR CONSTRUCTION PURPOSES USE FIGURED DIMENSIONS ONLY. THIS DRAWING IS TO BE READ IN CONJUNCTION WITH ALL RELEVANT PROJECT INFORMATION. ALL DIMENSIONS MUST BE CHECKED ON SITE PRIOR TO THE COMMENCEMENT OF WORKS. PLEASE REPORT ANY DISCREPANCY TO THE ARCHITECT OR CONTRACT ADMINISTRATOR.



350 wide, 6.4mm thick laminated opaque glass panels fixed to the facing side of cantilevered 30degree splayed steel fin plates at head and base to screen frame. Glass to be fixed to plate using 2 no. rivet fixings to top and bottom of glass sheet. Frame 150 x 100mm RHS subject to SE Details supported on 150x100 RHS set and resin bolted to foundations. Column to be encased in concrete up to ground level with at least 50mm minimum cover. Colour of screen frame and posts powder coated grey to RAL number as per specification.

Frame additional restrained to building with Ancon restrains to inner leaf of masonry blockwork.

Restrained back to building subject to SE details - refer to S.E. drawing.

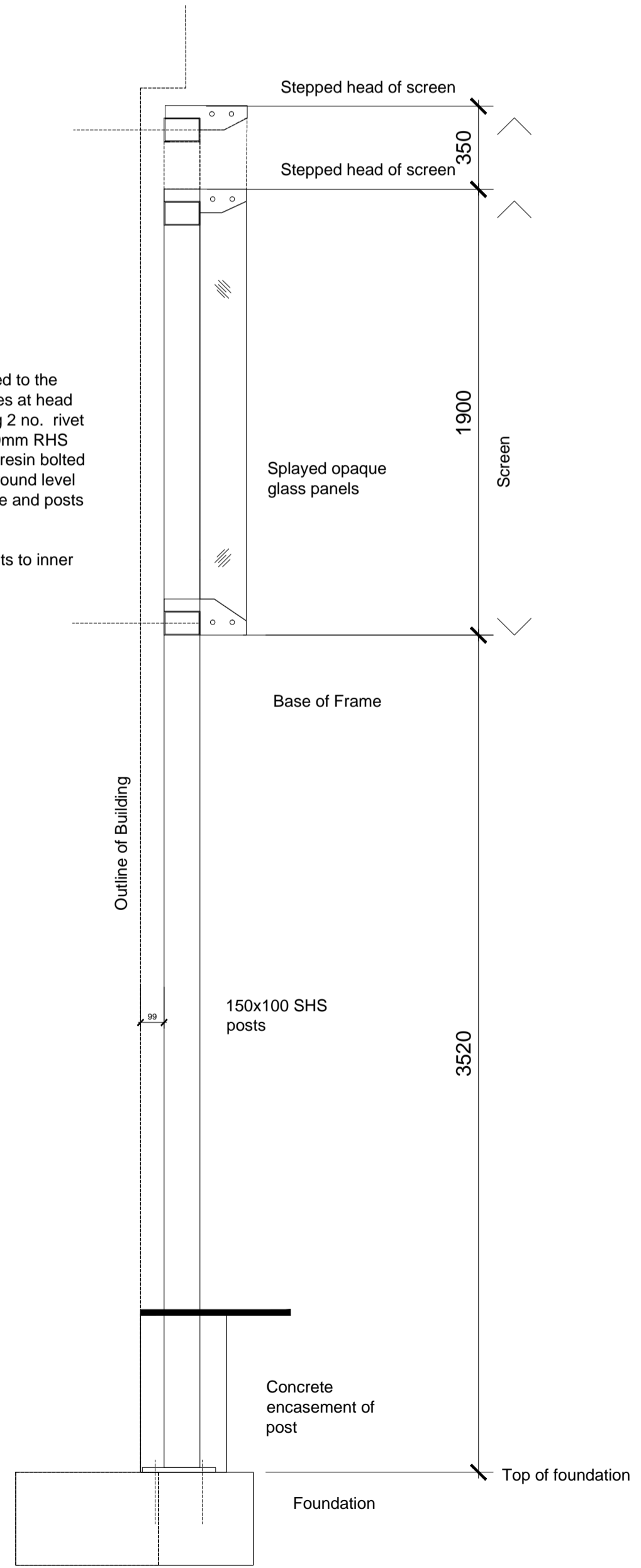

SECTION A-A

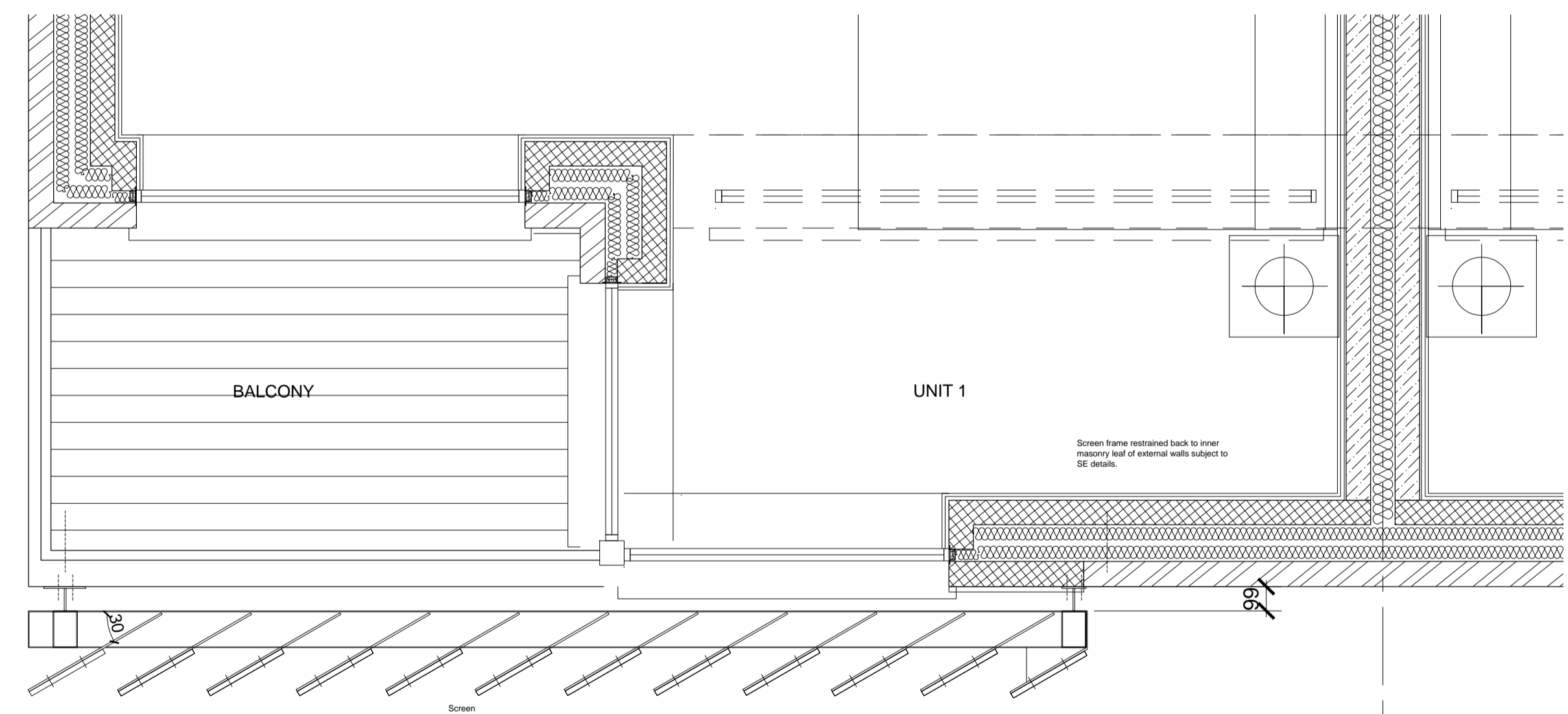

PLAN SECTION B-B

T3	15/12/2014	Screen design amended	JK
T2	31/03/2014	Screen design amended	JK
T1	02/12/2013	Tender Issue	ANC
Rev:	Date:	Revision note:	By:

prime BUILDING CONSULTANTS LTD
 Prime House T 01622 692249
 1A Queen Anne Road F 01622 692296
 Maidstone E pbc@primebc.co.uk
 ME14 1HU W www.primegrouppld.co.uk

SURVEYORS ARCHITECTS PLANNERS

Project:
7-8 Gottfried Mews, London, NW5

Client:
Bromley Park Garden Estates Ltd

Title:
Screen Details

Purpose of issue:
TENDER - NOT FOR CONSTRUCTION

Drawing number: 014.1555-225 Revision: T3

Scale: 1:20 & 1:50 Paper Size: A1 Date: 12/2013 Drawn By: ANC

Copyright © Prime Building Consultants Limited. Do not reproduce without written permission.