

T:\30000\_projects\30740 Russell Square House - Construction Access\ACAD\001 - 008.dwg

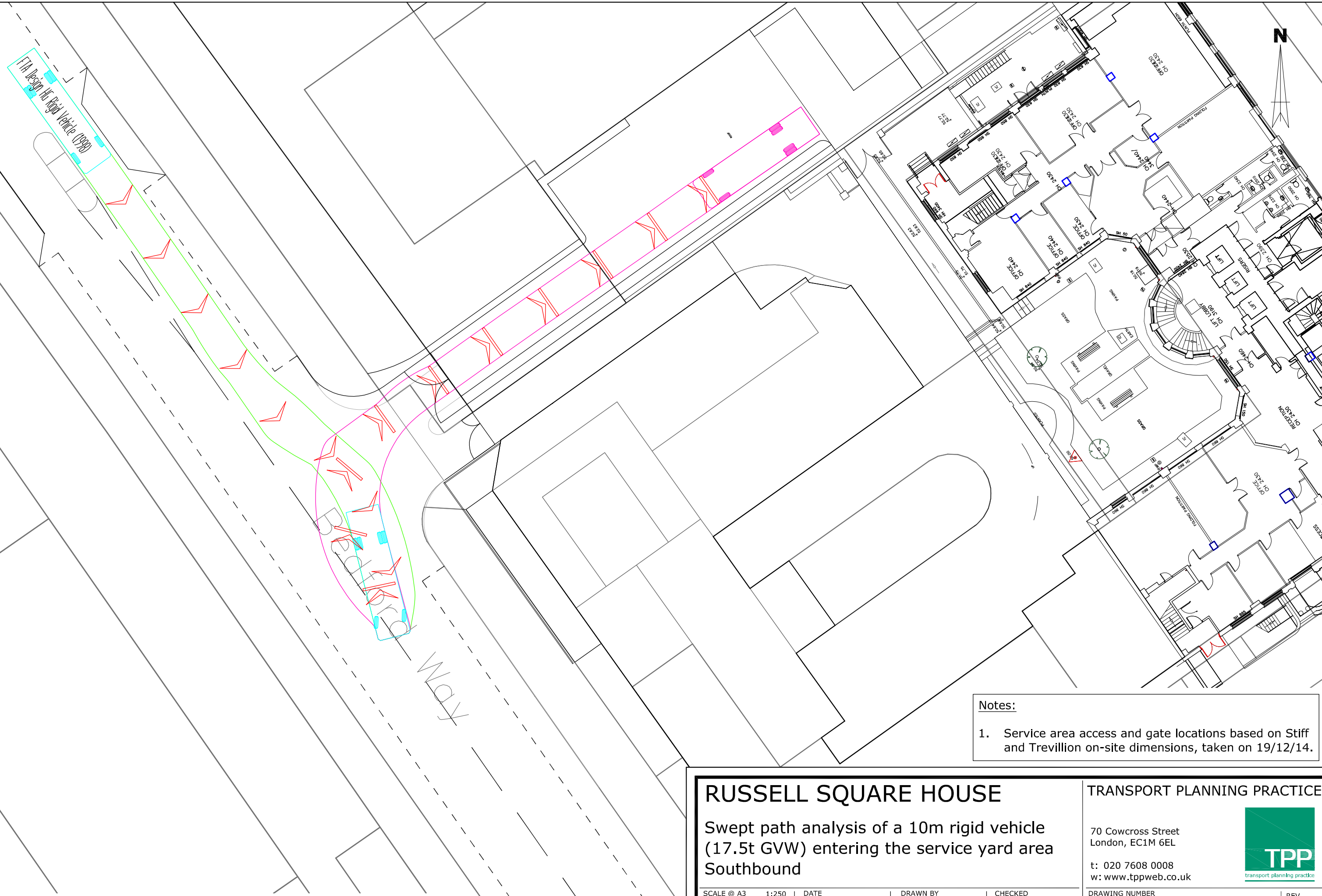

**Notes:**

1. Service area access and gate locations based on Stiff and Trevillion on-site dimensions, taken on 19/12/14.

This drawing has been prepared for planning purposes and should not be used for construction. It should be read in conjunction with TPP e-mail of 16/01/15.

Based on Stiff + Trevillion Architects layout, drawing number 3396-001. TPP REF - IN\_01

# RUSSELL SQUARE HOUSE

Swept path analysis of a 10m rigid vehicle (17.5t GVW) entering the service yard area Southbound

SCALE @ A3	1:250	DATE	15/01/15	DRAWN BY	TC	CHECKED	CW
0 2.5 5m							

## TRANSPORT PLANNING PRACTICE

70 Cowcross Street  
London, EC1M 6EL  
t: 020 7608 0008  
w: www.tppweb.co.uk



DRAWING NUMBER	30740/AC/003	REV	-
----------------	--------------	-----	---