

NOTES
 CONTRACTORS MUST VERIFY ALL DIMENSIONS ON SITE BEFORE COMMENCING ANY WORK OR SHOP DRAWINGS. FIGURED DIMENSIONS ARE TO BE USED IN PREFERENCE TO SCALED DIMENSIONS. IF THIS DRAWING EXCEEDS THE QUANTITIES TAKEN IN ANY WAY, THE ARCHITECTS ARE TO BE INFORMED BEFORE THE WORK IS INITIATED.
 SEIFERT COPYRIGHT

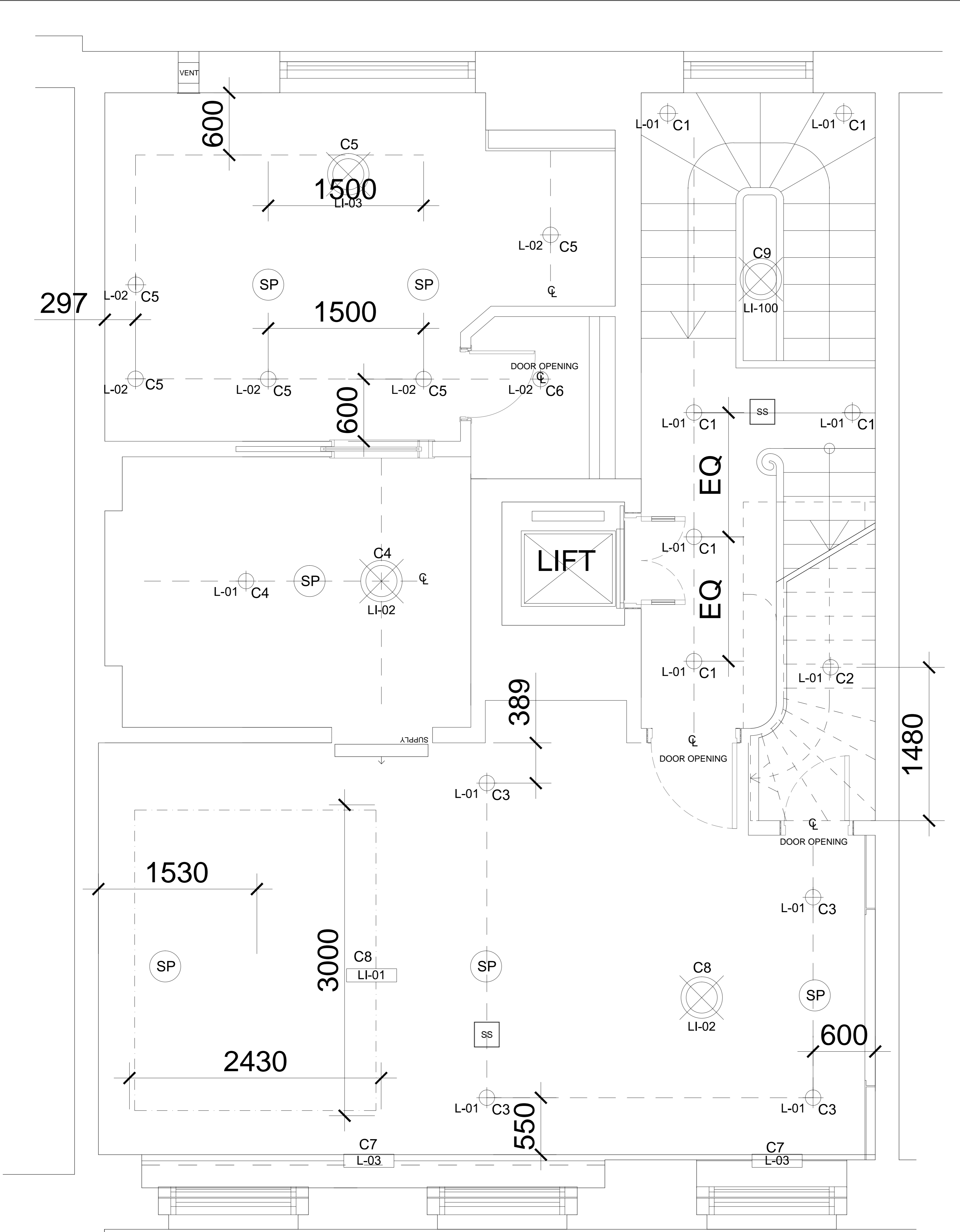

**BALCONY BELOW
 (AT 1ST FLOOR)**

REV.	DESCRIPTION	DATE	INIT.

© SIGMA SEIFERT INTERIORS 2014

NOTES

1. THE DRAWING SHOW DESIGN INTENT ONLY. ALL DIMENSIONS TO BE CHECKED ON SITE PRIOR TO CONSTRUCTION OR PRODUCTION. CONSTRUCTION DETAILS TO BE CONFIRMED BY CONTRACTOR/ MANUFACTURER BY SUBMITTING SHOP DRAWINGS FOR DESIGNER'S APPROVAL.
2. DESIGN / DRAWING IS NOT TO BE SCALED FOR PRODUCTION AND CONSTRUCTION PURPOSES
3. ALL DISCREPANCIES AND OMISSIONS ON SITE MUST BE REPORTED TO DESIGNER FOR THEIR COMMENTS OR APPROVAL PRIOR TO COMMENCING WORK.
4. ALL ELECTRICAL, LIGHTING, HVAC AND PLUMBING ISSUES TO BE REFERRED TO ENGINEER'S DRAWINGS PRIOR TO COMMENCEMENT OF WORKS.
5. THE DESIGNS ARE SUBJECT TO APPROVAL BY STATUTORY AUTHORITIES AND ANY NECESSARY ALTERATIONS SHOULD BE MADE IF REQUIRED TO COMPLY WITH STATUTORY REQUIREMENTS.
6. ALL DESIGN CONCEPTS AND DRAWINGS ARE THE PROPERTY OF SIGMA ARCHITECTURE AND INTERIORS AND COVERED BY COPYRIGHT. NO REPRODUCTIONS, ADAPTATIONS AND/OR COPIES MAY BE MADE WITHOUT WRITTEN PERMISSION BY SIGMA.



4 Duke's Mews
 London
 W1U 3ET
 T: 020 7935 6984
 www.sigma-interiors.co.uk

STATUS **PLANNING**

CLIENT **John Seifert**
 JOB **5 Chester Terrace
 Regents Park, NW1**

TITLE **SECOND FLOOR PLAN
 PROPOSED
 REFLECTIVE
 CEILING PLAN**

SCALE **A1 @ 1:20** DATE **11/11/14**
 DRAWING No. **S17044-204** REVISION No. **-**

- NOTES:**
- Existing spot lights will be used so that fabric of the ceiling will not be altered.
 - New ceilings will have new spot lights
 - Air conditioning will be placed in ceiling voids