

Notes:
 All drawings to be read in conjunction with all other drawings as noted on issue sheet.
 Drawing based on Glanville survey drawings MDS140572/101 & MDS140572/100 dated May 2014. Survey drawing to be used for site setting out and check measurements.
 Survey is based on an arbitrary grid.

 Existing walls to be retained

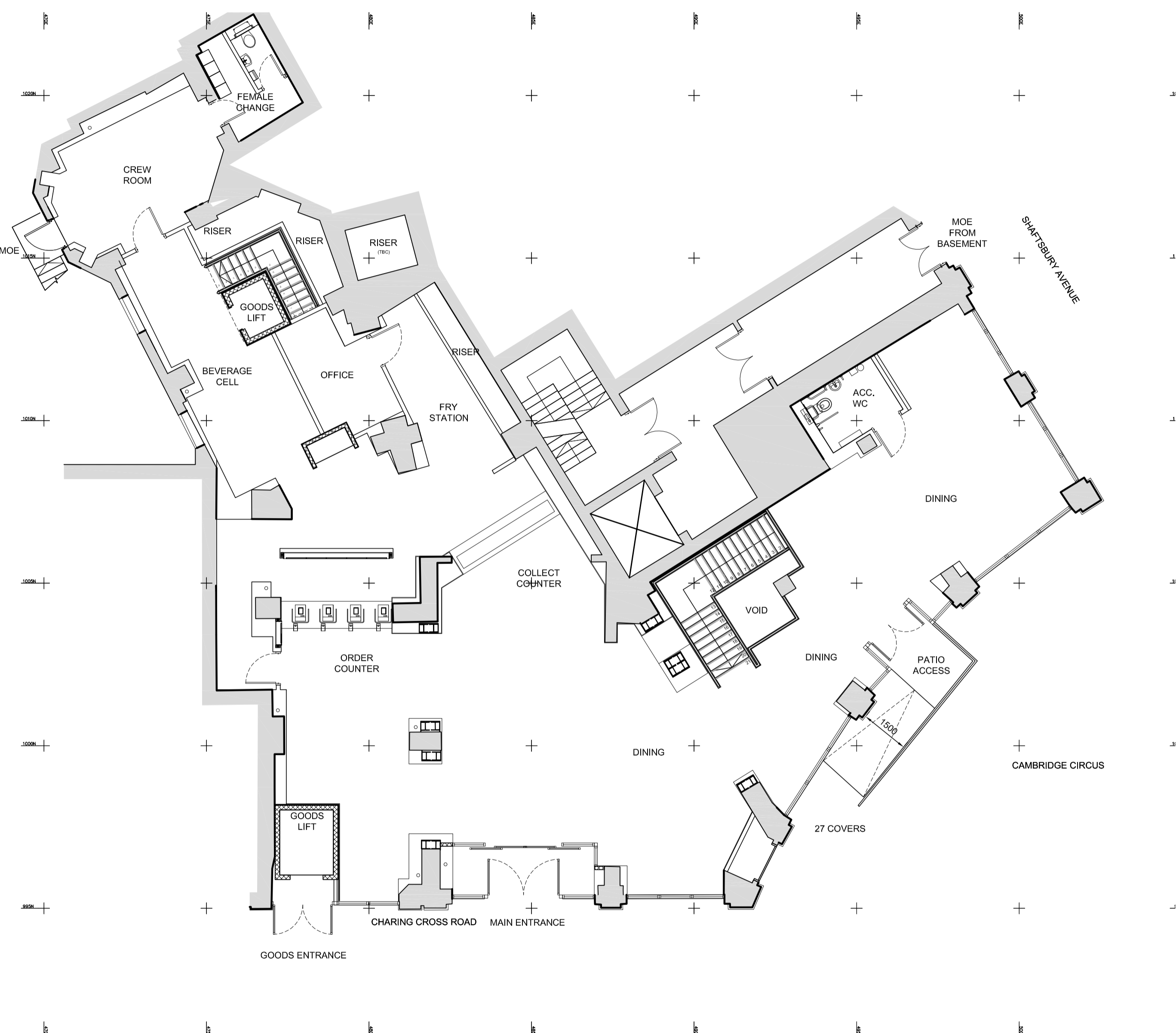

REV.	DATE	DRAWING REVISIONS	BY	CHECKED
C	22.01.15	General re-Bid.	NCC	-
B	15.12.14	General re-Bid.	NCC	-
A	02.12.14	PLANNING ISSUE	NCC	SH

GENERAL NOTES:
 All works are to be undertaken in accordance with the Building Regulations and the latest British Standards.
 All proprietary materials and products are to be used solely in accordance with the manufacturer's recommendations.
 All dimensions to be checked on site prior to construction.
 All risks assessed to comply with the designer's responsibility under the Construction (Design Management) Regulations 2007.

PROPOSED DEVELOPMENT AT
 Leon de Bruxelles
 CAMBRIDGE CIRCUS
 STORE No: 8253

ON BEHALF OF:
 McDonald's Restaurants Ltd
 DRAWING TITLE:
 Proposed
 General Arrangement
 Plans

DRAWN BY: NCC
 CHECKED BY: SH
 SCALE & SIZE: 1:100@A1
 DRAWING No.: 6743-PL-006
 DATE: Nov 2014
 REV. No.: C

