

The contractor is responsible to ensure that no products are to be utilised that do not comply with relevant British and/or European Standards and/or Codes of Practice, COSH Regulations, Construction Regulations, or which are known or suspected at the time of product selection and/or construction to be deleterious to health and safety or to the durability of the work or not in accordance with good building practices.

The contractor is responsible for checking dimensions, tolerances, levels and references. This drawing is to be read in conjunction with all relevant consultants or specialists drawings. Any discrepancy to be notified to Baily Garner LLP and rectified before proceeding with the works on site or shop drawings.

Where an Item is covered by drawings to different scales, the larger scale drawing is to be worked to.

This drawing and the copyrights and patents therein are the property of Baily Garner LLP and may not be used or reproduced without consent or attribution.

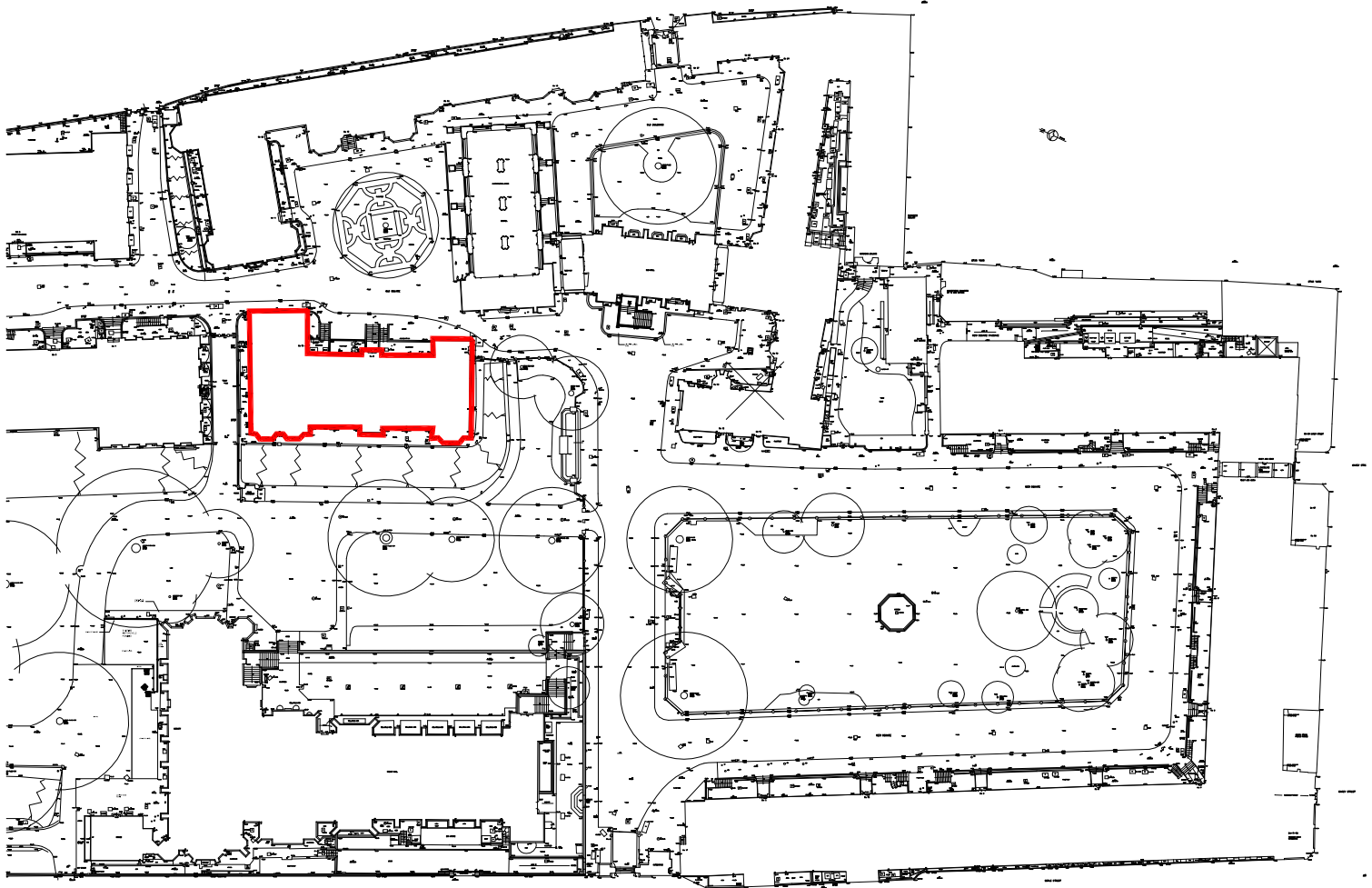

DATE OF ISSUE
19/01/2015



REVISION	D	C	DATE

CLIENT:
The Honourable Society
of Lincoln's Inn
ADDRESS:
8, 9 and 10 Old Square
Lincoln's Inn
London WC2A

SCALE:
1:1250

JOB NO.
27144

PROJECT:
Fall restraint system
installation works
TITLE:
Site Location Plan

PURPOSE OF ISSUE:
Planning / LBC

D C
NSR

DATE
19/01/2015

DRAWING No.
65

REVISION

BAILY · GARNER

146-148 ELTHAM HILL
LONDON SE9 5DY
t. 020 8294 1000
f. 020 8294 1320
e. general@bailygarner.co.uk