

DATED

5 September

2013

(1) KCB GEOTECHNICS SDN BHD

and

**(2) THE MAYOR AND BURGESSES OF
THE LONDON BOROUGH OF CAMDEN**

A G R E E M E N T

relating to land known as

74 Charlotte Street, London W1T 4QH

**pursuant to Section 106 of the Town and Country Planning
Act 1990 (as amended) and**

Section 278 of the Highways Act 1980

Andrew Maughan
Head of Legal Services
London Borough of Camden
Town Hall
Judd Street
London WC1H 9LP

Tel: 020 7974 1918

Fax: 020 7974 2962

G:\case files\culture & env\planning\Imm/s106 Agreements/ (2012/2133/P)
CLS/COM/WB/1685.1516



THIS AGREEMENT is made the *11th* day of *September* 2013

BETWEEN:

- i. **KCB GEOTECHNICS SDN BHD** (incorporated in Malaysia) of Level 3A (Annexe), Menara Milenium, 8 Jalan Damansara, Damansara Heights 50490, Kuala Lumpur, Malaysia (hereinafter called "the Owner") of the first part
- ii. **THE MAYOR AND BURGESSES OF THE LONDON BOROUGH OF CAMDEN** of Town Hall, Judd Street, London WC1H 9LP (hereinafter called "the Council") of the second part

1. WHEREAS

- 1.1 The Owner is registered at the Land Registry as the freehold proprietor with Title absolute of the Property under Title Number 128797.
- 1.2 The Owner is the freehold Owner of and is interested in the Property for the purposes of Section 106 of the Act.
- 1.3 A Planning Application for the development of the Property was submitted to the Council and validated on 4 May 2012. The Council refused to grant planning permission.
- 1.4 An appeal was made by the Owner pursuant to section 78 of the Act to the Planning Inspectorate in respect of the Council's refusal to grant planning permission and the appeal was assigned the reference number APP/X5210/A/13/2198656 (the "Appeal").
- 1.5 The Council is the local planning authority for the purposes of the Act for the area in which the Property is situated and considers it expedient in the interests of the proper planning of its area that the development of the Property should be restricted or regulated in accordance with this Agreement.

1.6 As local highway authority the Council considers the Highways Works to be carried out pursuant to this section 278 Agreement to be in the public benefit.

1.7 For that purpose the Owner is willing to enter into this Agreement pursuant to the provisions of Section 106 of the Act.

2. DEFINITIONS

In this Agreement the following expressions (arranged in alphabetical order) shall unless the context otherwise requires have the following meanings:-

2.1 "the Act" the Town and Country Planning Act 1990 (as amended)

2.2 "the Agreement" this Planning Obligation made pursuant to Section 106 of the Act

2.3 "Construction Management Plan" a plan setting out the measures that the Owner will adopt in undertaking the construction of the Development using good site practices in accordance with the Council's Considerate Contractor Manual to ensure the Construction Phase of the Development can be carried out safely and with minimal possible impact on and disturbance to the surrounding environment and highway network including (but not limited to):-

- (i) a statement to be submitted to Council giving details of the environmental protection highways safety and community liaison measures proposed to be adopted by the Owner in order to mitigate and offset potential or likely effects and impacts arising from the demolition of the Existing Buildings or

structures on the Property and the building out of the Development;

- (ii) incorporation of the provisions set out in the First Schedule annexed hereto
- (iii) incorporation of the provisions set out in the Second Schedule annexed hereto
- (iv) effects on the health and amenity of local residences site construction workers local businesses and adjoining developments undergoing construction;
- (v) amelioration and monitoring measures over construction traffic including procedures for notifying the owners and or occupiers of the residences and businesses in the locality in advance of major operations delivery schedules and amendments to normal traffic arrangements (if any);
- (vi) the inclusion of a waste management strategy for handling and disposing of construction waste; and
- (vii) identifying means of ensuring the provision of information to the Council and provision of a mechanism for monitoring and reviewing as required from time to time

2.4 "the Construction Phase"

the whole period between

- (i) the Demolition Date and

(ii) the date of issue of the Certificate of Practical Completion

2.5 "the Council's Considerate Contractor Manual"

the document produced by the Council from time to time entitled "Guide for Contractors Working in Camden" relating to the good practice for developers engaged in building activities in the London Borough of Camden

2.6 "the Demolition Date"

the date on which demolition of the Existing Buildings and site clearance commences

2.7 "the Development"

demolition of building behind retained four storey front façade and redevelopment for a 5 storey building that includes a new mansard roof level with rear terrace, a rear terrace at second floor level, plus excavation to form a basement level with front lightwell, to accommodate restaurant (Class A3) at basement and ground floors and 4 x residential flats on upper floors to be communally accessed from Charlotte Mews as shown on the Site Location Plan and drawing numbers (PL) 001 002 003A to 006A 007 008 009A to 012A 013B to 015B 016C 017B to 021B 022 023A

2.8 "the Environmental Improvements Contribution"

the sum of £15,000 (fifteen thousand pounds) to be paid by the Owner to the Council in accordance with the terms of this Agreement and to be applied by the Council in the event of receipt for the provision of various pedestrian signage (including the Legible London initiative) and public realm improvements in the vicinity of the Development and for the avoidance of doubt

this contribution is referred to in the Mayor of London's Stage 3 Report as the "pedestrian signage and street improvements contribution"

2.9 "Existing Buildings"

the buildings existing at the Property as at the date of this Agreement

2.10 "the Highways Contribution"

the sum of £21,000 (twenty one thousand pounds) to be paid by the Owner to the Council in accordance with the terms of this Agreement and to be applied by the Council in the event of receipt for the carrying out of the Highway Works

2.11 "the Highways Works"

works to the public highway and associated measures these to include costs associated with the following:-

- a) footway repaving works on Charlotte Street;
- b) carriageway works (cobble) on Charlotte Mews;
- c) Traffic Management Order costs and works associated with the relocation of motorcycle bay; and
- d) any other works the Council acting reasonably requires as a direct result of the Development

all works will be subject to final measure and for the avoidance of doubt the Council in accepting this sum does not undertake any responsibility in connection with any required statutory undertakers works and excludes any statutory undertakers costs

2.12 "the Implementation Date"

the date of implementation of the Development by the carrying out of a material operation as defined in Section 56 of the Act and references to "Implementation" and "Implement" shall be construed accordingly

2.13 "the Level Plans"

plans demonstrating the levels at the interface of the Development the boundary of the Property and the Public Highway

2.14 "Occupation Date"

the first date when any part of the Development is occupied and the phrases "Occupy", "Occupied" and "Occupation" shall be construed accordingly

2.15 "the Parties"

mean the Council and the Owner

2.16 "the Planning Application"

a planning application in respect of the development of the Property submitted to the Council and validated on 4 May 2012 under reference number 2012/2133/P

2.17 "Planning Obligations Monitoring Officer"

a planning officer of the Council from time to time allocated to deal with all planning obligations pursuant to S106 of the Act to whom all notices, correspondence, approvals etc must be sent in the manner prescribed at clause 6.1 hereof

2.18 "the Planning Permission"

a planning permission granted for the Development pursuant to the Appeal

2.19 "the Property"

the land known as 74 Charlotte Street the same as shown outlined red on the plan annexed hereto

2.20 "Residents Parking Bay"

a parking place designated by the Council by an order under the Road Traffic Regulation Act 1984 or other relevant legislation for use by residents of the locality in which the Development is situated

2.21 "Residents Parking Permit"

a parking permit issued by the Council under section 45(2) of the Road Traffic Regulation Act 1984 allowing a vehicle to park in Residents Parking Bays

2.22 "the Sustainability Plan"

a plan securing the incorporation of sustainability measures in the carrying out of the Development in its fabric and in its subsequent management and occupation based which shall include:-

- (a) an assessment under the Code for Sustainable Homes achieving at least Level 3 and attaining at least 50% of the credits in each of the Energy Water and Materials categories;
- (b) include a pre-Implementation review by an appropriately qualified and recognised independent verification body in respect of the Property certifying that the measures incorporated in the Sustainability Plan are achievable in the Development

and satisfy the aims and objectives of the Council's strategic policies on sustainability contained within its Development Plan; and

- (c) measures to secure a post construction review of the Development by an appropriately qualified and recognised independent verification body in respect of the Property certifying that the measures incorporated in the Sustainability Plan have been achieved in the Development and will be maintainable in the Development's future management and occupation

3. **NOW THIS DEED WITNESSETH** as follows:-

- 3.1 This Agreement is made in pursuance of Section 106 of the Act, and is a planning obligation for the purposes of Section 106 as aforesaid, and shall be enforceable by the Council against the Owner as provided herein and against any person deriving title to any part of the Property from the Owner and insofar as it is not a planning obligation its provisions may be enforceable by the Council under any relevant statutory powers.
- 3.2 Words importing the singular shall include the plural and vice versa and any words denoting actual persons shall include companies corporations and other artificial persons.
- 3.3 Any reference to a specific statute or statutes include any statutory extension or modification amendment or re-enactment of such statute and any regulation or orders made under such statute.

- 3.4 The clause and paragraph headings do not form part of this Agreement and shall not be taken into account in its construction or interpretation.
- 3.5 It is hereby agreed between the Parties that save for the provisions of clauses 1, 2, 3, 5, 6 and 7 hereof all of which shall come into effect on the date hereof the covenants, undertakings and obligations contained within this Agreement shall become binding upon the Owner upon the Implementation Date.
- 3.6 The Council hereby agrees to grant the Planning Permission on the date hereof.
- 3.7 The Parties save where the context states otherwise shall include their successors in title.
- 3.8 The Parties acknowledge that the Development shall be treated as being permanently designated as "car free" in accordance with Clause 4.12 for all relevant purposes.

4. **OBLIGATIONS OF THE OWNER**

The Owner hereby covenants with the Council as follows:-

CONSTRUCTION MANAGEMENT PLAN

- 4.1 On or prior to the Demolition Date to provide the Council for approval a draft Construction Management Plan.
- 4.2 Not to allow demolition or works of site clearance until such time as the Council has approved the Construction Management Plan as demonstrated by written notice to that effect.
- 4.3 The Owner acknowledges and agrees that the Council will not approve the Construction Management Plan unless it demonstrates to the Council's reasonable satisfaction that the Construction Phase of the Development can be carried out safely and with minimal possible impact on and disturbance to the surrounding environment and highway network.

- 4.4 To ensure that throughout the Construction Phase the Development shall not be carried out otherwise than in strict accordance with the requirements of the Construction Management Plan and not to permit the carrying out of any works comprised in demolition or building out the Development at any time when the requirements of the Construction Management Plan are not being complied with and in the event of non compliance with this sub-clause the Owner shall forthwith take any steps required to remedy such non-compliance.

HIGHWAYS CONTRIBUTION

- 4.5 On or prior to the Implementation Date to:-
- (i) pay to the Council the Highways Contribution in full; and
 - (ii) submit to the Council the Level Plans for approval.
- 4.6 Not to Implement or to allow Implementation until such time as the Council has:-
- (i) received the Highways Contribution in full; and
 - (ii) approved the Level Plans as demonstrated by written notice to that effect.
- 4.7 For the avoidance of doubt the Owner acknowledges that the Council has the right reserved to it to construct the Public Highway to levels it considers appropriate and does not undertake any responsibility in connection with any required statutory undertakers works and that the Highways Contribution excludes any statutory undertakers costs.
- 4.8 On completion of the Highway Works the Council may provide to the Owner a certificate specifying the sum ("the Certified Sum") expended by the Council in carrying out the Highway Works.
- 4.9 If the Certified Sum exceeds the Highway Contribution then the Owner shall within fourteen days of the issuing of the said certificate pay to the Council the amount of the excess.

ENVIRONMENTAL IMPROVEMENTS CONTRIBUTION

- 4.10 On or prior to the Implementation Date to pay to the Council the Environmental Improvements Contribution in full and not to Implement or to allow Implementation until such time as the Council has received the Environmental Improvements Contribution in full as demonstrated by written notice to that effect.

DEVELOPMENT TO BE “CAR FREE”

- 4.11 To ensure that prior to occupying any residential unit forming part of the Development each new resident of the Development is informed by the Owners of the Council's policy that they shall not be entitled (unless they are the holder of a disabled persons badge issued pursuant to Section 21 of the Chronically Sick and Disabled Persons Act 1970) to be granted a Residents Parking Permit to park a vehicle in a Residents Parking Bay and will not be able to buy a contract to park within any car park owned, controlled or licensed by the Council.
- 4.12 The Owner for itself and its successors in title to the Property hereby acknowledge that the provision in Clause 4.11 above will bind the Property permanently.
- 4.13 On or prior to the Occupation Date to inform the Council's Planning Obligations Monitoring Officer of the official unit numbers of the residential units forming part of the Development (as issued and agreed by the Council's Street Name and Numbering Department), identifying those residential units that in the Owner's opinion are affected by the Owner's obligation in Clause 4.11 of this Agreement.

SUSTAINABILITY PLAN

- 4.14 On or prior to the Implementation Date to submit to the Council for approval the Sustainability Plan.
- 4.15 Not to Implement nor permit Implementation until the Sustainability Plan has been approved by the Council as demonstrated by written notice to that effect
- 4.16 Not to Occupy or permit Occupation of the Property until a satisfactory post-completion review has been submitted to and approved by the Council in writing confirming that the measures incorporated in the Sustainability Plan as approved by the Council have been incorporated into the Property.

4.17 Following the Occupation Date the Owner shall not occupy or permit occupation of any part of the Development at any time when the Development is not being managed in strict accordance with the Sustainability Plan as approved by the Council and shall not Occupy or permit Occupation of the Development otherwise than in strict accordance with the requirements of the Sustainability Plan.

5. **NOTICE TO THE COUNCIL/OTHER MATTERS**

5.1 The Owner shall give written notice to the Council on or prior to the Implementation Date specifying that Implementation of the Development has taken or is about to take place.

5.2 Within seven days following completion of the Development the Owner shall certify in writing to the Planning Obligations Monitoring Officer in the manner outlined at clause 6.1 hereof quoting planning reference 2012/2133/P the date upon which the Development is ready for Occupation.

5.3 The Owner shall act in good faith and shall co-operate with the Council to facilitate the discharge and performance of all obligations contained herein and the Owner shall comply with any reasonable requests of the Council to have access to any part of the Property or any requests to provide documentation within the Owner's possession (at the Owner's expense) for the purposes of monitoring compliance with the obligations contained herein.

5.4 The Owner agrees declares and covenants with the Council that it shall observe and perform the conditions restrictions and other matters mentioned herein and shall not make any claim for compensation in respect of any condition restriction or provision imposed by this Agreement and further shall indemnify the Council for any expenses or liability arising to the Council in respect of breach by the Owner of any obligations contained herein save to the extent that any act or omission of the Council its employees or agents has caused or contributed to such expenses or liability.

5.5 If satisfied as to the compliance of the Owner in respect of any obligation in this Agreement the Council shall (if requested to do so in writing and subject to payment of a fee of £1,000 in respect of each such obligation) provide through its Head of

Legal Services a formal written certification of compliance, partial compliance or ongoing compliance (as and if appropriate) with the provisions of any such obligation.

- 5.6 Submission of any plan for approval by the Council under the terms of this Agreement shall be made by the Owner to the Council sending the full document and any appendices in electronic format to the Planning Obligations Monitoring Officer referring to the names dates and Parties to this Agreement and citing the specific clause of this Agreement to which such plan relates quoting the planning reference 2012/2133/P.
- 5.7 Payment of the financial contribution pursuant to Clause 4.5, 4.10 and 4.11 of this Agreement shall be made by the Owner to the Council sending the full amount in the form of a Banker's Draft to the Planning Obligations Monitoring Officer referring to the names dates and Parties to this Agreement and citing the specific clause of this Agreement to which such Contribution relates quoting the Income Code 2012/2133/P or by Electronic Transfer directly to the Co-Operative Bank plc of 1 Islington High Street London N1 9TR quoting Sort Code 08-90-33 and London Borough of Camden General Account No. 61030019 and to inform the Planning Obligations Monitoring Officer of such payment quoting the above details as if the payment had been made by Banker's Draft.
- 5.7 All consideration given in accordance with the terms of this Agreement shall be exclusive of any value added tax properly payable in respect thereof and all parties other than the Council shall pay and indemnify the Council against any such value added tax properly payable on any sums paid to the Council under this Agreement upon presentation of an appropriate value added tax invoice addressed to the Owner.
- 5.8 Any sums referred to in this Agreement as payable or to be applied by any party other than the Council under this Agreement shall be paid or applied TOGETHER WITH if such payment or application is made more than three months from the date of this Agreement a further sum ("A") being equal to the original sum payable ("B") multiplied by a figure being a fraction of which the All Items of Retail Prices ("the AIIRP") figure last published by the Central Statistical Office at the date hereof is the denominator ("X") and the last AIIRP figure published before the date such payment

or application is made ("Y") less the last published AllRP figure at the date hereof ("X") is the numerator so that

$$A = B \times \frac{(Y-X)}{X}$$

5.9 All costs and expenses payable to the Council under this Agreement shall bear interest at the rate of 4% above the Base Rate of the National Westminster Bank plc from time to time being charged from the date such payment is due until payment is made.

6. **IT IS HEREBY AGREED AND DECLARED** by the Parties hereto that:-

6.1 The provisions of Section 196 of the Law of Property Act 1925 (as amended) shall apply to any notice or approval or agreement to be served under or in connection with this Agreement and any such notice or approval shall be in writing and shall specifically refer to the name, date and Parties to the Agreement and shall cite the clause of the Agreement to which it relates and in the case of notice to the Council shall be addressed to the London Borough of Camden, Planning Obligations Officer, Urban Design and Renewal, Planning and Public Protection, Culture and Environment Directorate, Town Hall Annex, Argyle Street, London WC1H 9LP quoting the planning reference number 2012/2133/P and in the case of any notice or approval or agreement from the Council this shall be signed by a representative of the Council's Environment Department.

6.2 This Agreement shall be registered as a Local Land Charge.

6.3 The Owner agrees to pay the Council its proper and reasonable legal costs incurred in preparing this Agreement on or prior to the date of completion of the Agreement.

6.4 The Owner hereby covenants with the Council that it will within 28 days from the date hereof apply to the Chief Land Registrar of the Land Registry to register this Agreement in the Charges Register of the title to the Property and will furnish the Council forthwith on written demand with official copies of such title to show the entry of this Agreement in the Charges Register of the title to the Property.

6.5 Nothing contained or implied in this Agreement shall prejudice or affect the Council's powers to enforce any specific obligation term or condition nor shall anything contained or implied herein prejudice or affect any provisions, rights, powers, duties and obligations of the Council in the exercise of its functions as Local Planning Authority for the purposes of the Act or as a local authority generally and its rights, powers, duties and obligations under all public and private statutes, bye laws and regulations may be as fully and effectually exercised as if the Council were not a party to this Agreement.

6.6 Neither the Owner nor its successors in title nor any person deriving title from them shall be bound by the obligations in this Agreement in respect of any period during which it no longer has an interest in the Property but without prejudice to liability for any breach committed prior to the time it disposed of its interest.

6.7 For the avoidance of doubt the provisions of this Agreement (other than those contained in this sub-clause) shall not have any effect until this Agreement has been dated.

6.8 If the Planning Permission is quashed or revoked or otherwise withdrawn or expires before effluxion of time for the commencement of development or is modified (other than by agreement with or at the request of the Owner) this Agreement shall forthwith determine and cease to have effect.

7. **RIGHTS OF THIRD PARTIES**

7.1 The Contracts (Rights of Third Parties) Act 1999 shall not apply to this Agreement

IN WITNESS whereof the Council has caused its Common Seal to be hereunto affixed and the Owner has executed this instrument as a Deed the day and year first before written

**EXECUTED AS A DEED BY
KCB GEOTECHNICS SDN BHD
acting by a Director and its Secretary
or by two Directors**

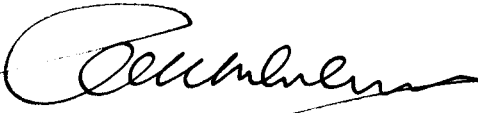
)
)
) 
)

.....
Director

Paula Harris

Director/Secretary

THE COMMON SEAL OF THE MAYOR)
AND BURGESSES OF THE LONDON)
BOROUGH OF CAMDEN was hereunto)
Affixed by Order:-)

[Signature]

Authorised Signatory

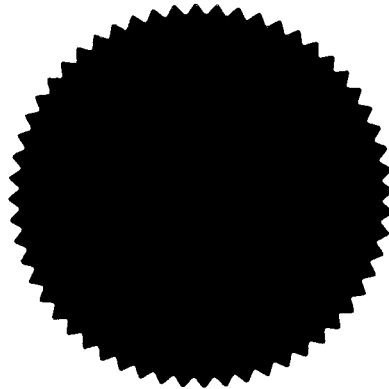

THE FIRST SCHEDULE
Construction Management Plan
Air Quality and Carbon Reduction

Requirements to control and minimise NO_x, PM₁₀, CO₂ emissions from construction sites and avoid nuisance and dust complaints.

A method statement shall be prepared and adopted as part of the Construction Management Plan to minimise gaseous and particulate matter emissions generated during the Construction Phase. The method statement shall identify the specific measures which will be implemented to control air pollution emissions during each of the following stages of the Construction Phase: (a) demolition; (b) ground breaking; and (c) construction/build.

The Construction Phase shall be carried out in accordance with the Best Practise Guidance Note "Control of dust and emissions from construction and demolition" published by London Councils, 2006. The risk rating of the site shall be defined in the method statement and determined using the risk assessment methodology in the Best Practise Guidance. Techniques to control dust from construction activities and emissions from vehicles and plant, and undertake air quality monitoring, shall conform to the 'medium' or 'high' risk categories outlined in the Best Practice Guidance.

The following best practise measures shall be included as a minimum in the method statement:-

A - Techniques to control PM₁₀ and NO_x emissions from vehicles and plant

- a) Low emission plant fitted with catalysts, diesel particulate filters or similar devices shall be used;
- b) Plant shall be well maintained, with routine servicing of plant and non-road mobile machinery (NRMM) to be completed in accordance with the manufacturers recommendations;
- c) Avoid the use of diesel or petrol powered generators and use mains electricity or battery powered equipment;
- d) Non-road mobile machinery (NRMM) shall use ultra low sulphur tax-exempt diesel and be fitted with appropriate exhaust after-treatment such as catalysts, diesel particulate

filters as stated on the approved list managed by the Energy Saving Trust. Details of the plant and control equipment shall be included in the method statement.

- e) All construction vehicles shall comply with the Euro 4 emissions standard and where possible use low emission fuels and alternative technology.
- f) Plant and vehicles shall be located way from the closest receptors or house in closed environments where possible.

B - Techniques to control dust emissions from construction and demolition

- a) Keep site fencing, barriers and scaffolding clean using wet methods;
- b) Buildings to be demolished shall be wrapped
- c) Provide easily cleaned hard standing for vehicles and clean using wet sweeping methods;
- d) Provide the use of wheel-wash facilities near the site exit. Fit wheel-washes with rumble grids to dislodge accumulated dust and mud prior to leaving the site to avoid carrying dust or mud off the site;
- e) Inspect internal haul routes for integrity and instigate necessary repairs to the surface as soon as reasonably practicable;
- f) Routinely clean the Public Highways and accesses using wet sweeping methods especially during dry periods;
- g) Impose and signpost maximum speed limits of 10 mph on surfaced haul routes and work areas within the Site;
- h) Ensure all vehicles carrying loose or potentially dusty material to or from the site are fully sheeted;
- i) Store materials with the potential to produce dust away from site boundaries;
- j) Sheet, seal or damp down stockpiles of excavated material held on site;
- k) Any loose materials brought onto the site shall be protected by appropriate covering
- l) The site shall be dampened down during the working day and again at the end of the day to reduce the amount that is re-suspended dust.
- m) Ensure water suppression is used during demolition operations;
- n) Ensure mobile crushing and screening plant and cement batching plant which are regulated under the Local Air Pollution Prevention and Control regime operate in compliance with a Part B Permit. This shall be submitted to the local authority prior to operation.
- o) Site personnel shall be trained in dust mitigation and a manager shall be present for managing dust on site.

C - Air Quality Monitoring

- a) Throughout the Construction Phase continuous particulate matter (PM10) monitoring shall be undertaken. Two instruments will be deployed at the site boundary in a transect orientated to the prevailing wind direction, with a third monitor located at the nearest sensitive receptor. One monitor shall be co-located with an anemometer.
- b) Adequate quality assurance/quality control procedures shall be in place including monitor maintenance and calibration as well and data checking. PM10 data shall be collected automatically on an hour basis.
- c) A trigger action level for PM10 concentrations of $200\mu\text{g.m}^{-3}$ (15 minute average) shall be used to identify incidences of elevated dust emissions at the site boundary. The development site shall comply with the trigger action throughout the demolition and construction phases.
- d) An on-site alert system (email or SMS) shall be in place to notify appropriate staff that the trigger action level has been reached. Immediate and appropriate measures can be put in place to rectify abnormal particulate emissions. A procedure shall be established to deal with abnormal dust emissions. All incidences of abnormal particulate emissions leading to breaches of the trigger action level, shall be documented in the site log book (date and time), with details of the action take to remediate dust emissions.
- e) An e-mail specifying details of any alert to be sent out to the Council's air quality officer as soon as practicable following any breach of the site trigger action level.
- f) An electronic report shall be submitted to the Council's air quality officer every three months summarising the following information from each monitoring site – 24 hour average PM10 concentration, date and time of any breach of the trigger action level with the 15 minute mean concentration, prevailing wind direction and details of the cause of elevated dust emissions and mitigation measures.
- g) The Council shall be notified of any changes to the location and operation of dust PM10 monitoring instrumentation.

- h) A 24-hour phone hotline shall be set up so that residents can complain about high dust or PM10 levels directly to the developer.

The following items shall be included in the method statement:

- a) A specific timetable identifying the start and finish dates of each phase, including dust generating activities and PM10 monitoring.
- b) An inventory of stationary and fugitive dust, PM10 and NOx emission sources with an explanation of how these will be mitigated in accordance with the London Council's Best Practise Guidance.
- c) A map identifying the location of dust generating activities, plant equipment associated with emissions to air and PM10 monitors.
- d) An air quality monitoring protocol prepared in accordance with the requirements of section C.

D - Techniques to reduce CO₂ emissions from construction vehicles

A commitment from the Owner that contractors' vehicles involved in construction and demolition work will adopt 'green fleet management practices' that will result in a 10% reduction in tail-pipe CO₂ emissions over the duration of the construction phase. A green fleet management plan included in the method statement identifying measures to improve vehicle efficiency and reduce CO₂ emissions from construction vehicles. This could include the use of fuel monitoring equipment in vehicles, eco-driver training, accreditation with FORS (Freight Operator Recognition Scheme run by TfL) or SAFED (Safe and Fuel Efficient Driving run by the DfT) and use of low carbon vehicles such as hybrid electric, electric and bio-methane.

THE SECOND SCHEDULE Construction Management Plan Highway Measures

A Construction Management Plan outlines how construction work will be carried out and how this work will be serviced (e.g. delivery of materials, set down and collection of skips), with the objective of minimising traffic disruption and avoiding dangerous situations and minimising the impact on local amenity. A Construction Management Plan should cover both demolition and construction phases of development. Details of the Construction Management Plan will relate to the scale and kind and location of the development and they should assess the impact on transport and on local amenity including road user amenity. Should any one of these criteria be considered not to be relevant, then specific justification, as to why that particular criterion is not relevant, will need to be provided. The Construction Management Plan should demonstrate that the following has been considered and where necessary the impacts mitigated:

(Note the term 'vehicles' used here refers to all vehicles associated with the implementation of the development, e.g. demolition, site clearing, delivering of plant, material and construction, staff parking etc)

- i. A brief description of the site, surrounding area and development proposals for which the Construction Management Plan applies.
- ii. Proposed start and end dates for each phase of construction.
- iii. The proposed working hours within which vehicles will arrive and depart.
- iv. The access arrangements for vehicles.
- v. Proposed routes for vehicles between the site and the Transport for London Road Network (TLRN). Consideration should also be given to weight restrictions, low bridges and cumulative affects of construction on the highway. A map of the TLRN can be downloaded from the following site:-
http://www.tfl.gov.uk/assets/downloads/TFL_Base_Map_Master.pdf
- vi. Typical sizes of all vehicles and the approximate frequency and times of day when they will need access to the site, for each phase of construction.
- vii. Swept path drawings for any tight manoeuvres on vehicle routes to the site.
- viii. Details (including accurate scaled drawings) of any highway works necessary to enable construction to take place.
- ix. Parking and loading arrangement of vehicles and delivery of materials and plant to the site.

- x. Details of proposed parking bays suspensions and temporary traffic management orders.
- xi. Proposed overhang (if any) of the public highway (scaffolding, cranes etc.).
- xii. Details of hoarding required or any other occupation of the public highway.
- xiii. Details of how pedestrian and cyclist safety will be maintained, including any proposed alternative routes (if necessary), and any Banksman arrangements.
- xiv. Details of how traffic associated with the Development will be managed in order to reduce congestion.
- xv. Details of any other measures designed to reduce the impact of associated traffic (such as the use of construction material consolidation centres).
- xvi. Details of how any significant amounts of dirt or dust that may be spread onto the public highway will be cleaned or prevented.
- xvii. Details of consultation on a draft Construction Management Plan with local residents, business, local groups (e.g. residents/tenants and business associations) and Ward Councillors. Details should include who was consulted, how the consultation was conducted and the comments received in response to the consultation. In response to the comments received, the Construction Management Plan should then be amended where appropriate and where not appropriate a reason should be given why not. The revised Construction Management Plan should also include a list of all the comments received. You are advised to check your proposed approach to consultation with the Council before carrying it out.
- xviii. Details of any Construction Working Group that will be set up, addressing the concerns of surrounding residents, as well as contact details for the person responsible for community liaison on behalf of the developer, and how these contact details will be advertised to the community.
- xix. Details of any schemes such as the "Considerate Contractors Scheme" that the project will be signed up to should form part of the consultation and be notified to the Council. Contractors will also be required to follow the "Guide for Contractors Working in Camden" also referred to as "Camden's Considerate Contractor's Manual"
- xx. Details of other construction sites in the local area and how your Construction Management Plan takes into consideration the cumulative effects of construction local to your site.
- xxi. Any other relevant information with regard to traffic and transport.
- xxii. The Construction Management Plan should also include the following statement:

"The agreed contents of the Construction Management Plan must be complied with unless otherwise agreed with the Council. The project manager shall work with the Council to review this Construction Management Plan if problems arise in relation to the construction of the Development. Any future revised plan must be approved by the Council and complied with thereafter."

It should be noted that any agreed Construction Management Plan does not prejudice further agreement that may be required for things such as road closures or hoarding licences





PLANNING

darling
associates

1000 1st Street, Suite 200
Charleston, SC 29401
Tel: 803.733.1111
Fax: 803.733.1112
www.darlingassociates.com

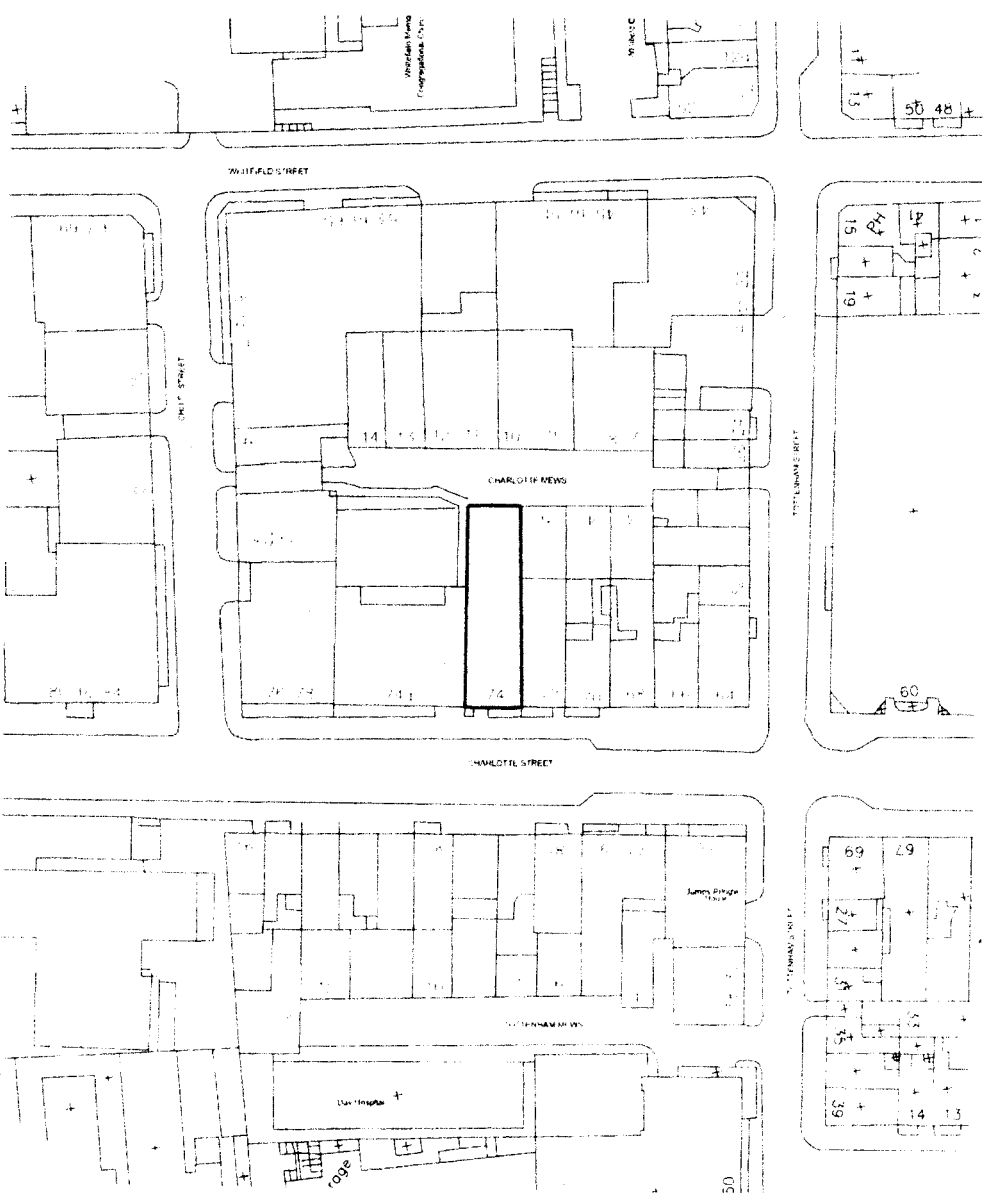

○

○

○

●

○

●

●

○

○

○

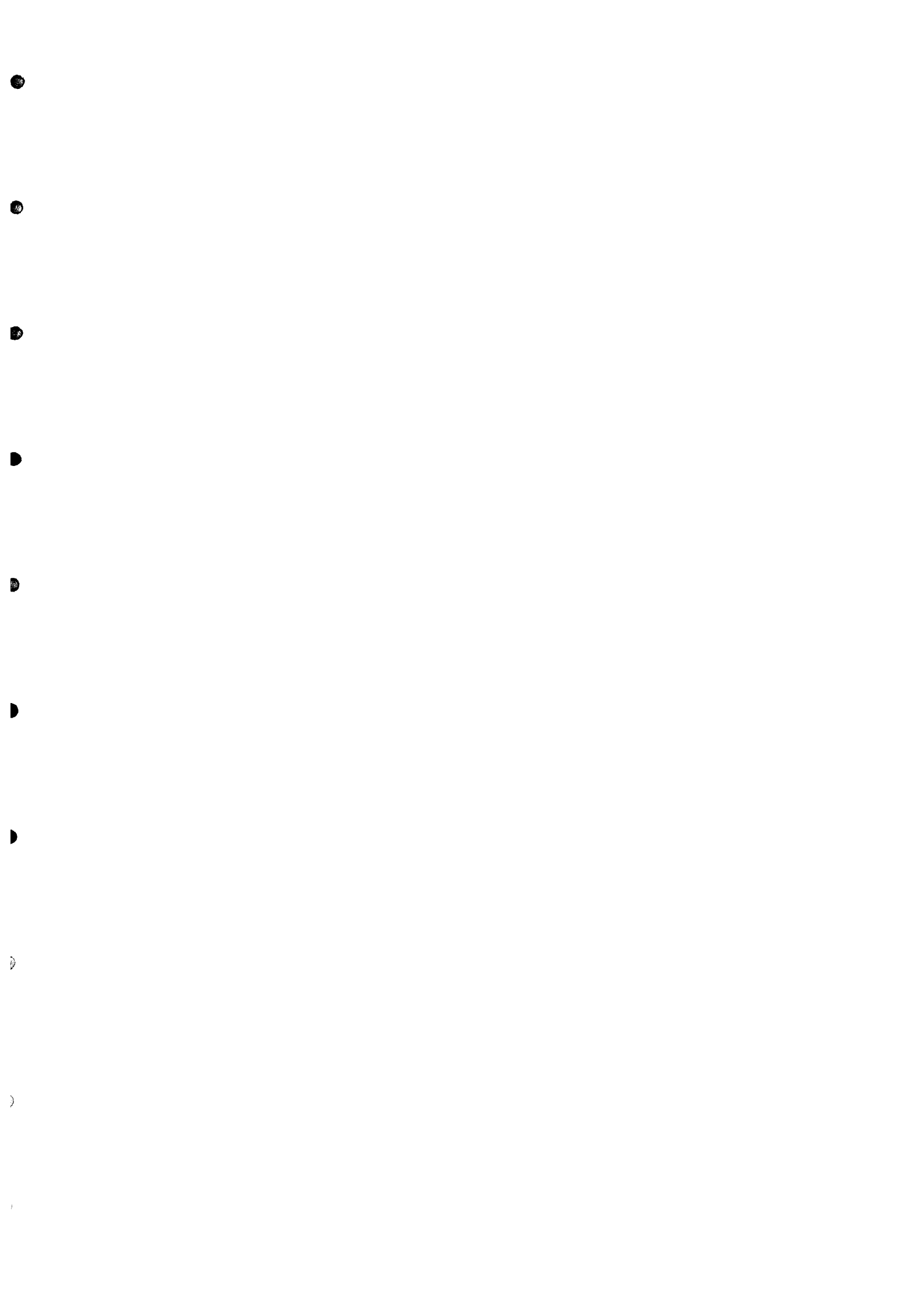

DATED

2013

(1) KCB GEOTECHNICS SDN BHD
and
(2) THE MAYOR AND BURGESSES OF
THE LONDON BOROUGH OF CAMDEN

A G R E E M E N T
relating to land known as
74 Charlotte Street, London W1T 4QH
pursuant to Section 106 of the Town and Country Planning
Act 1990 (as amended) and
Section 278 of the Highways Act 1980

Andrew Maughan
Head of Legal Services
London Borough of Camden
Town Hall
Judd Street
London WC1H 9LP

Tel: 020 7974 1918
Fax: 020 7974 2962

G:\case files\culture & env\planning\Imm\s106 Agreements/ (2012/2133/P)
CLS/COM/WB/1685.1516