

NOTE : WINDOWS ADJACENT TO REAR OF PARK SQUARE EAST, UPPER GROUND TO SECOND FLOOR, TO HAVE REMOVABLE INTERNAL SCREENS LOCATED BEHIND FOR PRIVACY REASONS. REFER TO DESIGN AND ACCESS STATEMENT, PRIVACY AND OVERLOOKING STRATEGY.

NOTE : EXISTING WINDOWS TO THE POLYGONAL BUILDING TO BE REPLACED WITH DOUBLE GLAZED UNITS ,TO MATCH EXISTING DESIGN, IN ORDER TO ACHIEVE THE REQUIRED THERMAL PROPERTIES

NOTE : REFER TO DESIGN AND ACCESS STATEMENT 'MATERIALS AND APPEARANCE' FOR DESCRIPTION OF MATERIALS TO THE THIRD FLOOR ROOF EXTENSION.

NOTE : ANY REPAIR AND RENOVATION TO THE EXISTING FABRIC TO INVOLVE MATCHING MATERIALS AND TECHNIQUES.

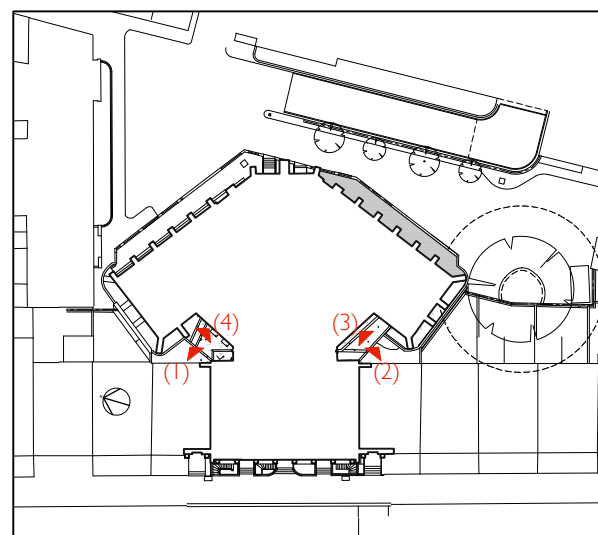

REV:	DATE:	DESCRIPTION:	INITIALS:
G	07/03/14	NOTE ADDED REGARDING PROPOSED AND EXISTING FINISHED FLOOR LEVELS	NC
F	18/06/13	SOUTH-WEST AND NORTH-WEST ELEVATION REVISED	NC
E	13/06/13	NORTH WEST ELEVATION, THIRD FLOOR ELEVATION REVISED	JH
D	29/04/13	REPLACEMENT WINDOWS NOTE REVISED	JH

PROJECT:	The Diorama, London, NW1 4LH		
CLIENT:	The Crown Estate		
DRAWING:	Proposed Elevations 3		
SCALE:	1:100@A1	DRAWN:	JH
DATE:	Apr-13	CHECKED:	SW
CAD FILE:	1126-PL-10		
DRAWING NO:	1126-PL-10	REV:	G