

EXISTING

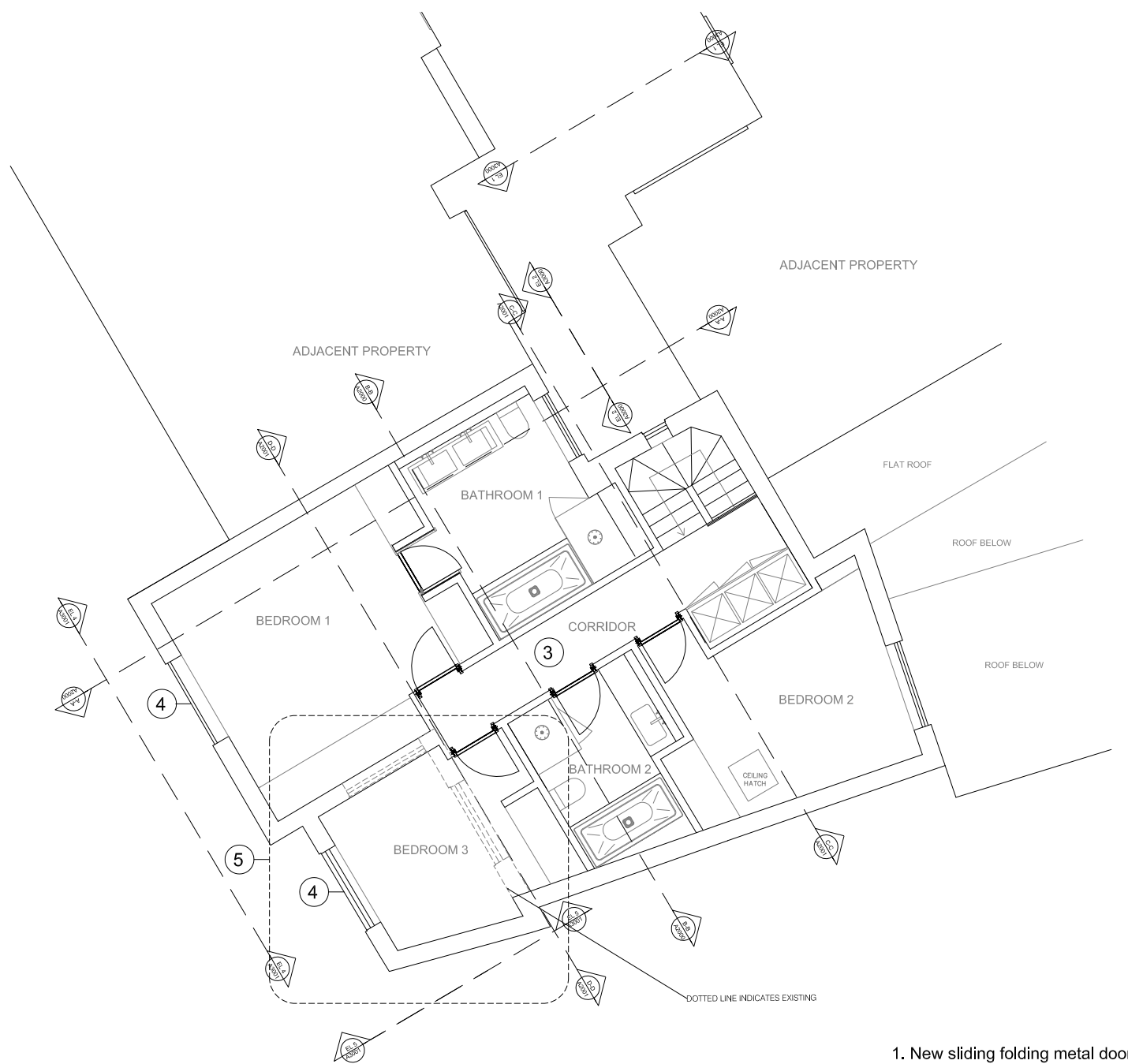

PROPOSED

1. New sliding folding metal doors
2. New timber glazed screen
- detail to match existing
3. Internal layout amended
4. Additional window
5. Extension at rear of building

date rev revisions

key plan

notes

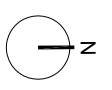

DMFK Architects Ltd take no responsibility for dimensions obtained by scaling from this drawing. If no dimension is shown the recipient must ascertain the dimension specifically from the architect or by site measurement and may not rely on the drawing. Supply of the drawing in digital form is solely for convenience and no reliance may be placed on any data in digital form. All data must be checked against hard copy. This drawing is issued for design intent only and should not be used for construction unless stated.

copyright
This drawing is the property of dMFK Architects Ltd. No disclosure or copy of it may be made without the written permission of dMFK Architects Ltd.



DE METZ FORBES KNIGHT ARCHITECTS

the old library 119 cholmley gardens london nw6 1aa t 020 7435 1144 f 020 7435 0884 mail info@dmfk.co.uk

project drawing title

Maryon Mews First Floor Existing and Proposed Plan

client	scale at A1	scale at A3	drawn	date
-	1:50	1:100	IC	DEC 14
	project no.	drawing no.	revision	

1979	A1001	-		
------	-------	---	--	--