

The contractor is responsible to ensure that no products are to be installed that do not comply with relevant British and/or European Standards (British Council of Fire, Civil Protection, and/or industry codes) or the manufacturer's instructions, and to ensure that the work is carried out in accordance with the relevant standards, specifications, health and safety, and any other applicable regulations. The drawings to be issued by the contractor shall be reviewed, corrected or approved by the architect. Any work not shown on the drawings shall be carried out in accordance with the relevant standards, specifications, health and safety, and any other applicable regulations. Where an item is covered by drawings to different scales, the larger scale drawing is to be worked to.

Do not scale drawings. Figure dimensions to be worked to in all cases.

This drawing and the copyright and patents therein are the property of Baily Garner LLP and may not be used or reproduced without consent or permission.

A1

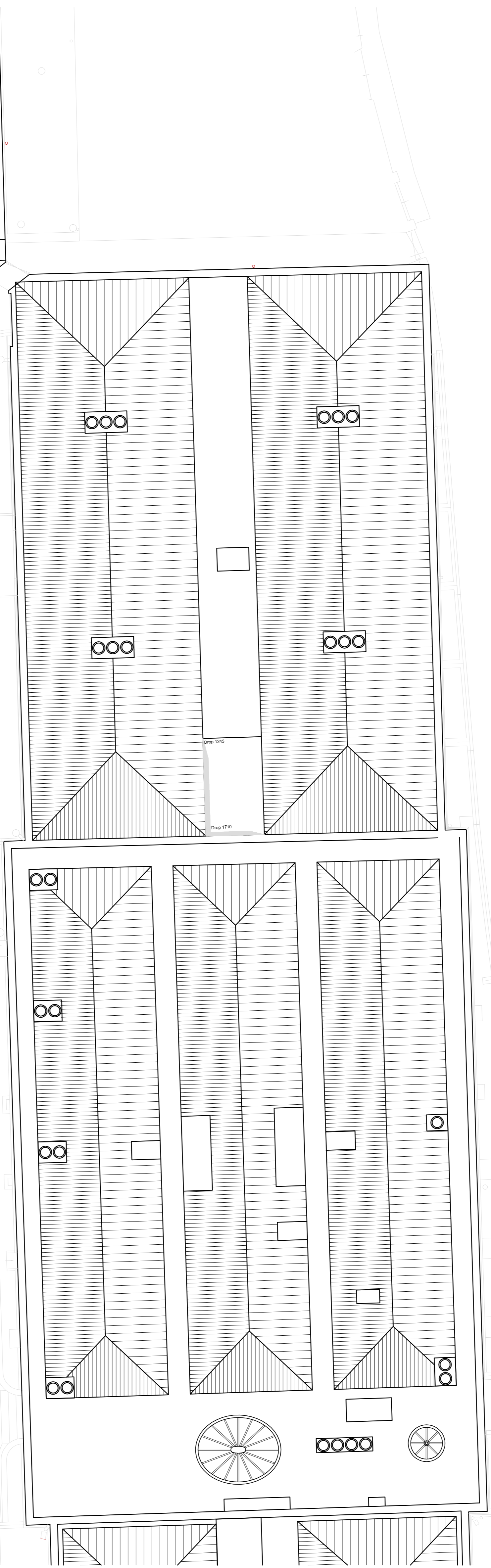
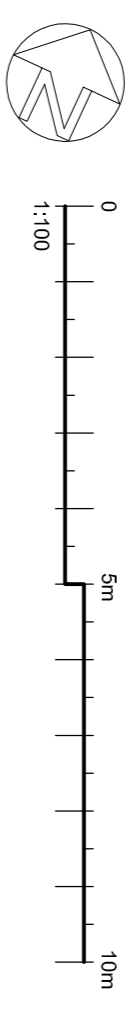
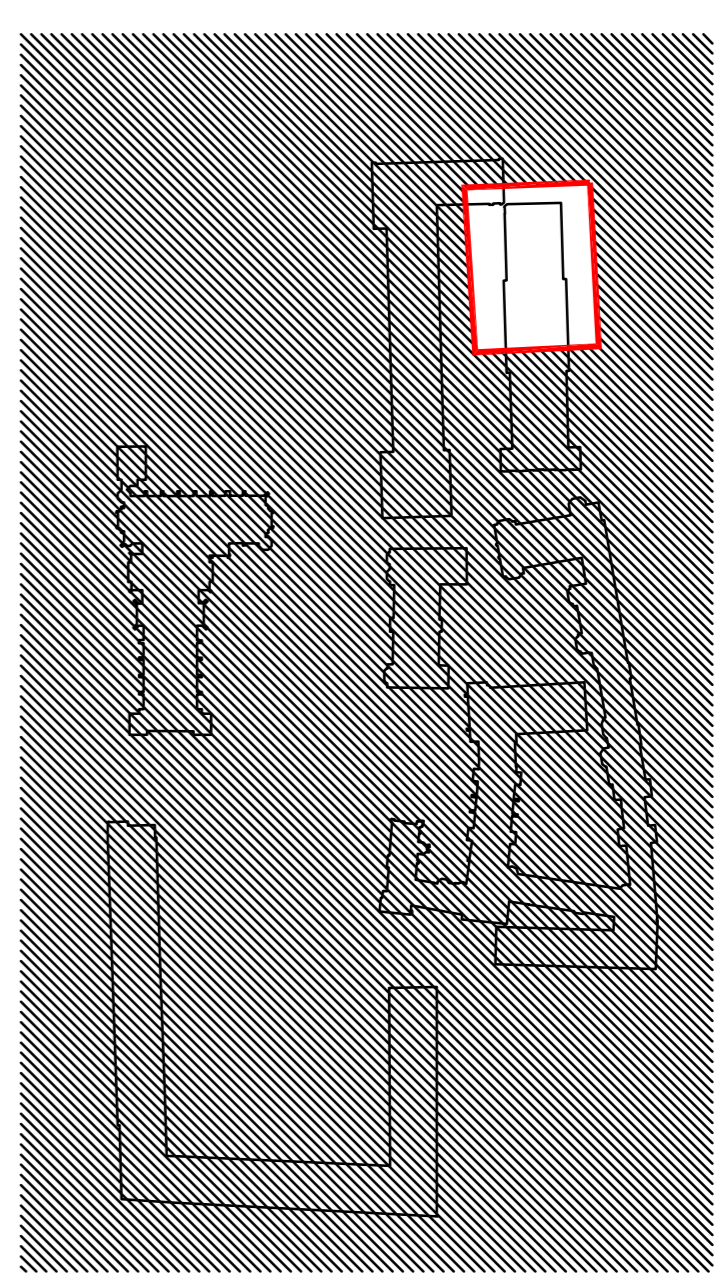

REVISION	DATE
0	C

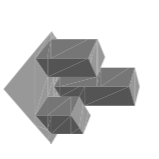

BAILY · GARNER
 46-48 ELTHAM HILL
 LONDON SE9 2DY
 T: 020 8264 1200
 E: info@bailygarner.co.uk

CLIENT:
 The Honourable Society of Lincolns Inn

ADDRESS:
 Lincolns Inn
 London
 WC2A 3TL

PROJECT:
 High Level Access Works

TITLE:
 Roof Plan Part 7
 Stone Buildings
 Planning

SCALE	DATE
1:100	13.10.14

JOB NO.	DRAWING NO.	REVISION
27145	17	