

DO NOT SCALE FROM THIS DRAWING  
 DRAWING TO BE READ IN CONJUNCTION WITH ALL OTHER ARCHITECTS  
 AND ENGINEER'S CONTRACT DRAWING & SPECIFICATIONS.  
 ANY DISCREPANCIES MUST BE BROUGHT TO THE ATTENTION OF THE  
 ARCHITECT IMMEDIATELY.  
 THE CONTRACTOR MUST VERIFY ALL DIMENSIONS BY SITE  
 MEASUREMENT BEFORE ORDERING MATERIALS OR MANUFACTURING  
 COMPONENTS.  
 SUBSTITUTE MATERIALS & PRODUCTS TO THOSE NAMED WILL BE  
 ACCEPTABLE IF PROVEN TO BE OF EQUAL OR HIGHER PERFORMANCE  
 AND NOT IN CONFLICT WITH OTHER ELEMENTS.

NOTES

All drawings are based on a scaled PDF not a survey. All  
 dimensions to be checked on site and confirmed with  
 Conservation Architect.

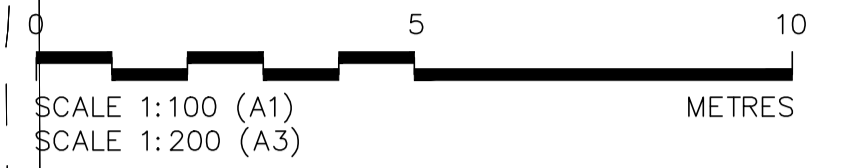

Replace below ground gully drains with access gully.  
 Replace lower portion of rainwater downpipe at joint.  
 Replace with cranked pipe.

Replace below ground gully drains with access gully.  
 Replace lower portion of rainwater downpipe at joint.  
 Replace with cranked pipe.

Replace below ground gully drains with access gully.  
 Replace lower portion of rainwater downpipe at joint.  
 Replace with cranked pipe.

Replace below ground gully drains with access gully.  
 Replace lower portion of rainwater downpipe at joint.  
 Replace with cranked pipe.

General Note:

Due to limited roof access, inspection  
 undertaken from ground level and  
 tower parapet. Carry out a closer roof  
 inspection, by scaffolding, to ascertain  
 any repairs required to slates, battens,  
 underlay, gutters and flashing's.  
 Replace slates and lead flashing to all  
 areas of roof as RGA condition survey  
 and specification and LSA  
 recommendations.

Existing soakaway drain  
 Existing pipe outlet at base of wall through stone.  
 Origin of discharge route unclear

Replace below ground gully drains with access gully.  
 Replace lower portion of rainwater downpipe at joint.  
 Replace with cranked pipe.

Investigate cause of flooding in West Porch. Propose  
 remedial works to below ground drainage if required.

Structural engineer to investigate cause of cracking to buttress's.  
 Remedial works to be recommended following trial pit investigation  
 and underground drain check

Investigate underground drainage route for any blockages or damage.

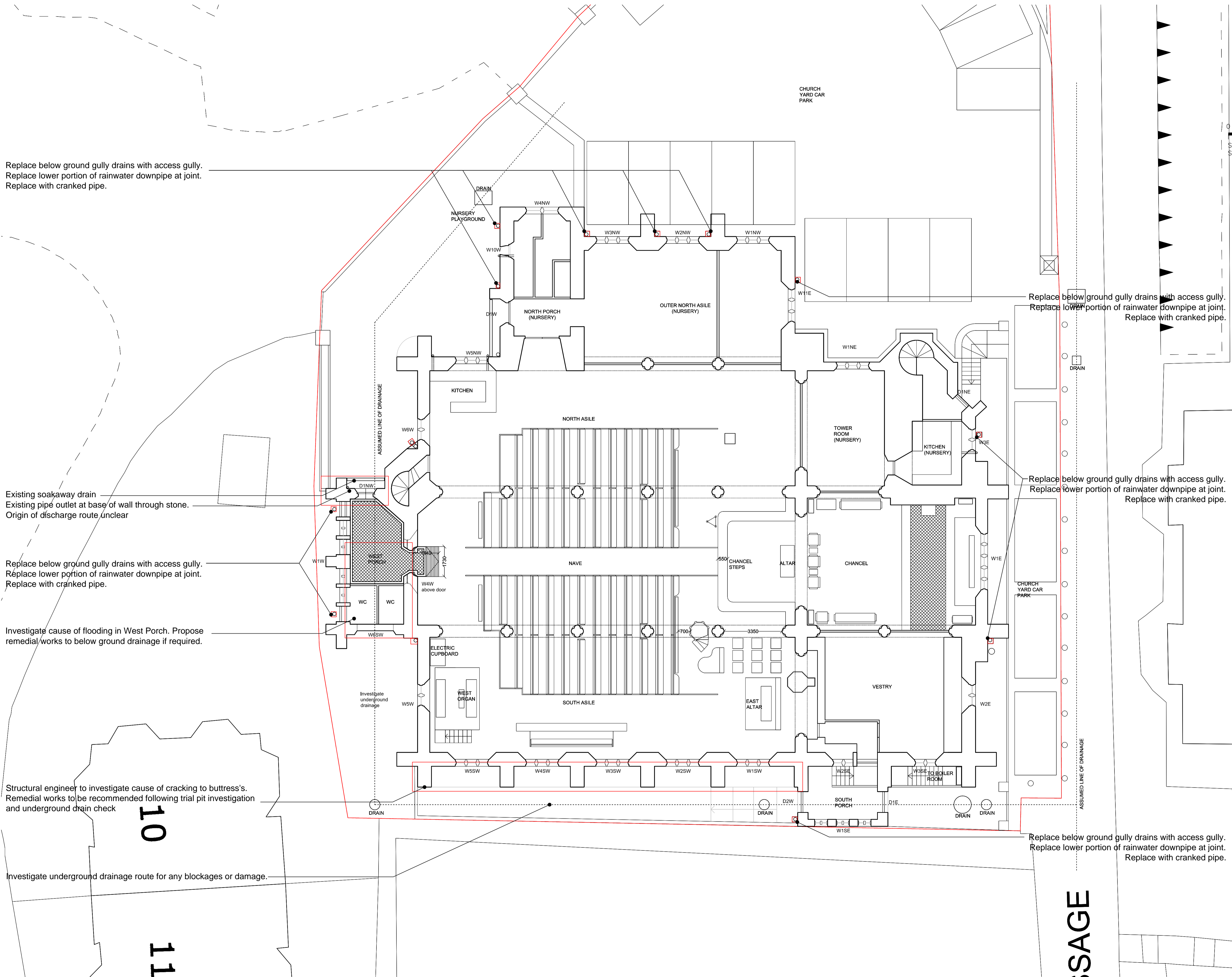

10

11

SAGE

| REV | DATE       | DESCRIPTION |
|-----|------------|-------------|
| -   | 19/12/2014 | For DAC     |

FOR DAC

|                             |                  |       |
|-----------------------------|------------------|-------|
| JOB TITLE                   |                  |       |
| Christ Church               |                  |       |
| Hampstead                   |                  |       |
| DRAWING TITLE               |                  |       |
| Ground Floor Plan           |                  |       |
| External Repairs - Drainage |                  |       |
| JOB No                      | DWG No           | REV   |
| 537B                        | D01              | -     |
| DRAWN BY                    | SCALE (AT A1)    | DATE  |
| JMc                         | 1:100 (1:200@A3) | Dec14 |

**RICHARD GRIFFITHS ARCHITECTS**  
 5 Maidstone Mews, 72-76 Borough High Street, London SE1 1GN  
 T +44(0)20 7357 8788 | F +44(0)20 7403 7887  
 E admin@rgarchitects.com | www.rgarchitects.com