

DO NOT SCALE FROM THIS DRAWING

DRAWING TO BE READ IN CONJUNCTION WITH ALL OTHER ARCHITECTS AND ENGINEER'S CONTRACT DRAWING & SPECIFICATIONS. ANY DISCREPANCIES MUST BE BROUGHT TO THE ATTENTION OF THE ARCHITECT IMMEDIATELY. THE CONTRACTOR MUST VERIFY ALL DIMENSIONS BY SITE MEASUREMENT BEFORE ORDERING MATERIALS OR MANUFACTURING COMPONENTS. SUBSTITUTE MATERIALS & PRODUCTS TO THOSE NAMED WILL BE ACCEPTABLE IF PROVEN TO BE OF EQUAL OR HIGHER PERFORMANCE AND NOT IN CONFLICT WITH OTHER ELEMENTS.

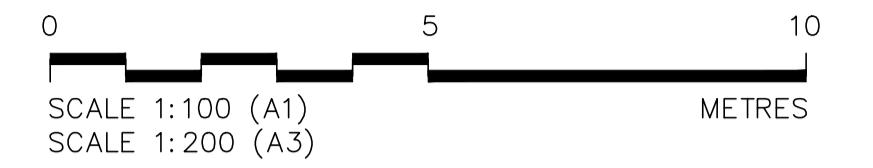

- Existing mosaic tiles
- Pannments
- Plane timber boards

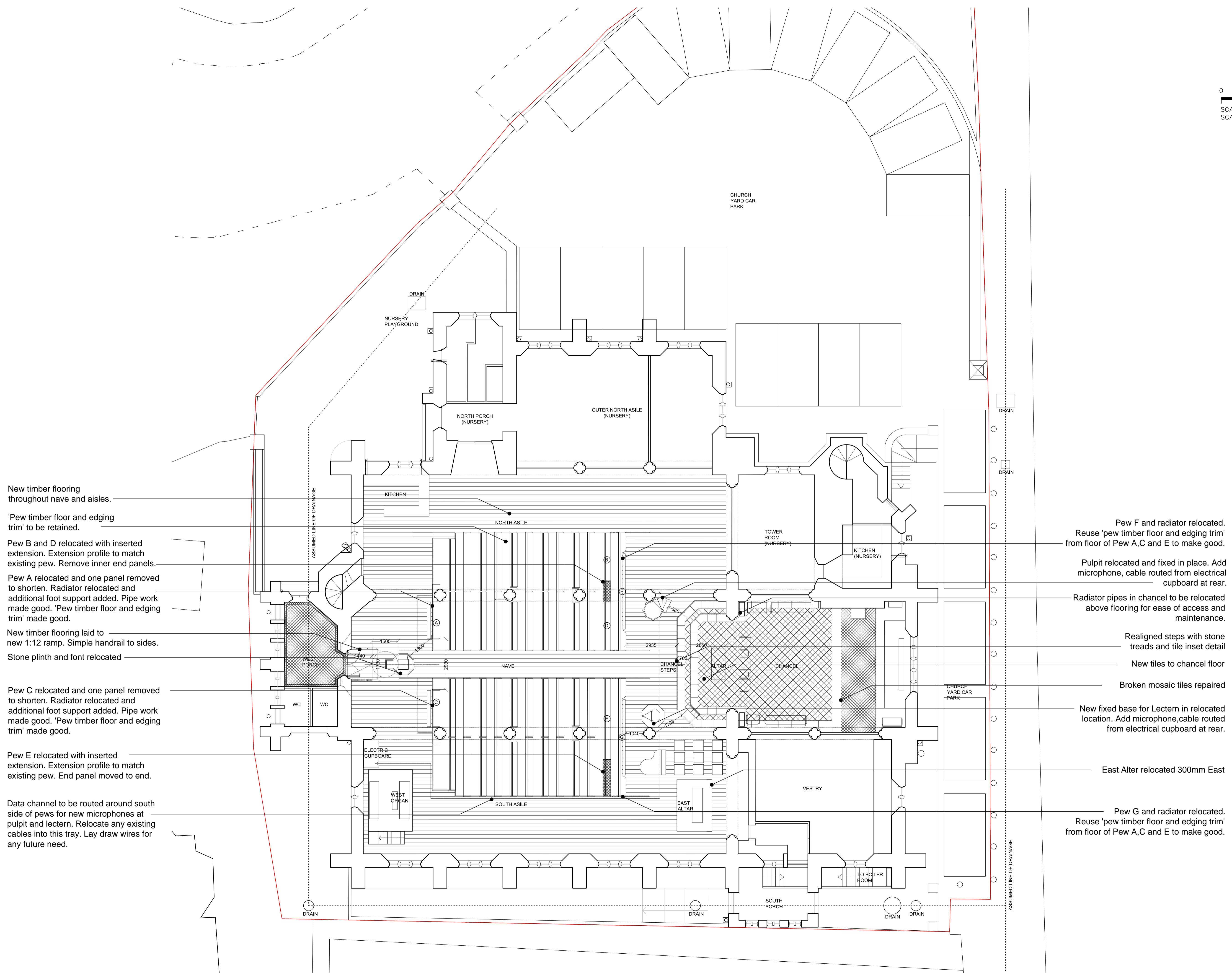

New timber flooring throughout nave and aisles.

'Pew timber floor and edging trim' to be retained.

Pew B and D relocated with inserted extension. Extension profile to match existing pew. Remove inner end panels.

Pew A relocated and one panel removed to shorten. Radiator relocated and additional foot support added. Pipe work made good. 'Pew timber floor and edging trim' made good.

New timber flooring laid to new 1:12 ramp. Simple handrail to sides.

Stone plinth and font relocated

Pew C relocated and one panel removed to shorten. Radiator relocated and additional foot support added. Pipe work made good. 'Pew timber floor and edging trim' made good.

Pew E relocated with inserted extension. Extension profile to match existing pew. End panel moved to end.

Data channel to be routed around south side of pews for new microphones at pulpit and lectern. Relocate any existing cables into this tray. Lay draw wires for any future need.

Pew F and radiator relocated. Reuse 'pew timber floor and edging trim' from floor of Pew A,C and E to make good.

Pulpit relocated and fixed in place. Add microphone, cable routed from electrical cupboard at rear.

Radiator pipes in chancel to be relocated above flooring for ease of access and maintenance.

Realigned steps with stone treads and tile inset detail

New tiles to chancel floor

Broken mosaic tiles repaired

New fixed base for Lectern in relocated location. Add microphone, cable routed from electrical cupboard at rear.

East Alter relocated 300mm East

Pew G and radiator relocated. Reuse 'pew timber floor and edging trim' from floor of Pew A,C and E to make good.

REV	DATE	DESCRIPTION
-	19/12/2014	For DAC

FOR DAC		
JOB TITLE Christ Church Hampstead		
DRAWING TITLE Ground Floor Plan Internal Reordering - Proposed		
JOB No	DWG No	REV
537C	D11	-
DRAWN BY	SCALE (AT A1)	DATE
JMc	1:100 (1:200@A3)	Dec14

RICHARD GRIFFITHS ARCHITECTS
 5 Maidstone Mews, 72-76 Borough High Street, London SE1 1GN
 T +44(0)20 7357 8788 | F +44(0)20 7403 7887
 E admin@rgarchitects.com | www.rgarchitects.com