

DO NOT SCALE FROM THIS DRAWING

DRAWING TO BE READ IN CONJUNCTION WITH ALL OTHER ARCHITECTS AND ENGINEER'S CONTRACT DRAWING & SPECIFICATIONS. ANY DISCREPANCIES MUST BE BROUGHT TO THE ATTENTION OF THE ARCHITECT IMMEDIATELY. THE CONTRACTOR MUST VERIFY ALL DIMENSIONS BY SITE MEASUREMENT BEFORE ORDERING MATERIALS OR MANUFACTURING COMPONENTS. SUBSTITUTE MATERIALS & PRODUCTS TO THOSE NAMED WILL BE ACCEPTABLE IF PROVEN TO BE OF EQUAL OR HIGHER PERFORMANCE AND NOT IN CONFLICT WITH OTHER ELEMENTS.

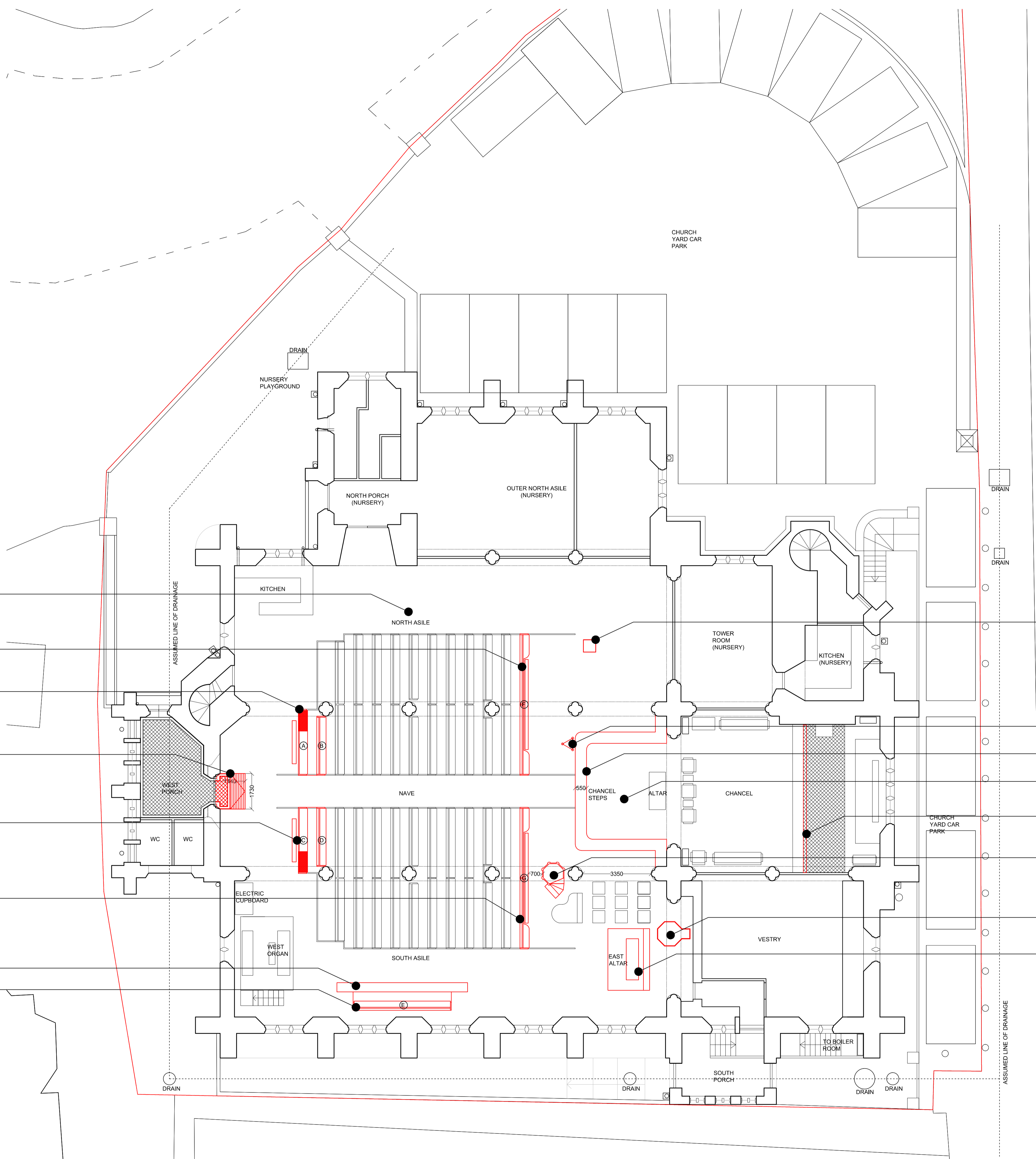
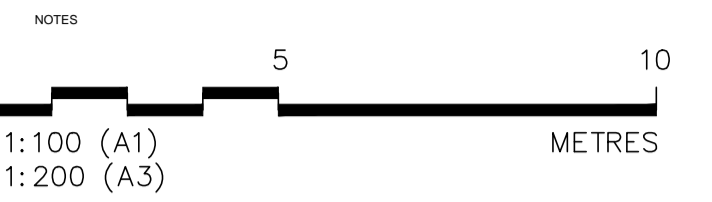

Remove carpet and timber flooring throughout nave and aisles. 'Pew timber floor and edging trim' to be retained.

Relocate Pew F

Relocate and alter Pew A. Relocate Pew B. Relocate radiator. Relocate 'pew timber floor and edging trim' inline with new pew

Remove existing timber ramp. Remove tiles to below closed door line

Relocate and alter Pew C. Relocate Pew D. Relocate radiator.

Relocate Pew G

Relocate book rest. Relocate and alter Pew E. Remove 'pew timber floor and edging trim' for reuse

Relocate and alter Font.

Relocate and alter lectern

Remove steps to chancel

Remove carpet to alter and chancel

Repair broken mosaic tiles

Relocate pulpit

Relocate stone plinth

Relocate East Alter

REV	DATE	DESCRIPTION
-	19/12/2014	For DAC

FOR DAC

JOB TITLE
Christ Church
Hampstead

DRAWING TITLE
Ground Floor Plan
Internal Reordering - Alterations

JOB No	DWG No	REV
537C	SK02	-
DRAWN BY	SCALE (AT A1)	DATE
JMc	1:100 (1:200@A3)	Dec14

RICHARD GRIFFITHS ARCHITECTS

5 Maidstone Mews, 72-76 Borough High Street, London SE1 1GN
 T +44(0)20 7357 8788 | F +44(0)20 7403 7887
 E admin@rgarchitects.com | www.rgarchitects.com