

Notes:  
Drawing based on information prepared by PKS Architects

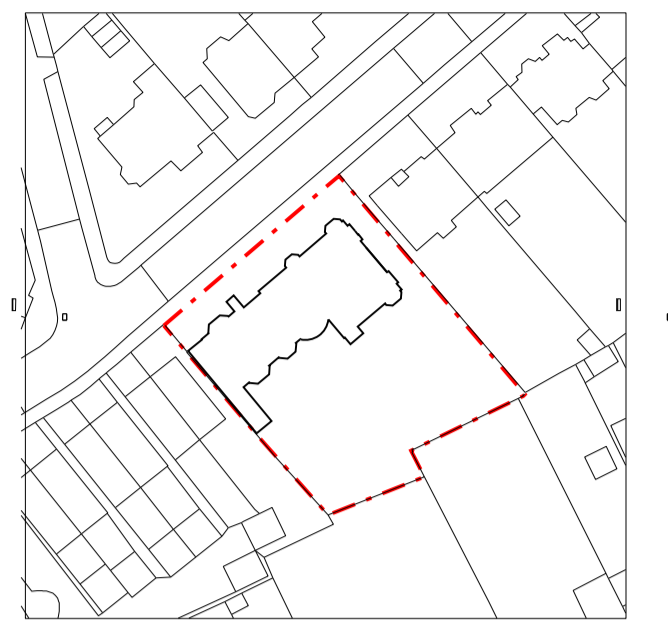

Site Location Plan

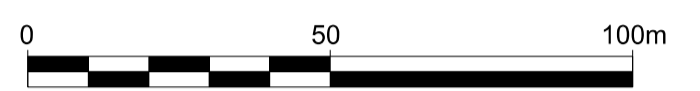

Scale 1:1250

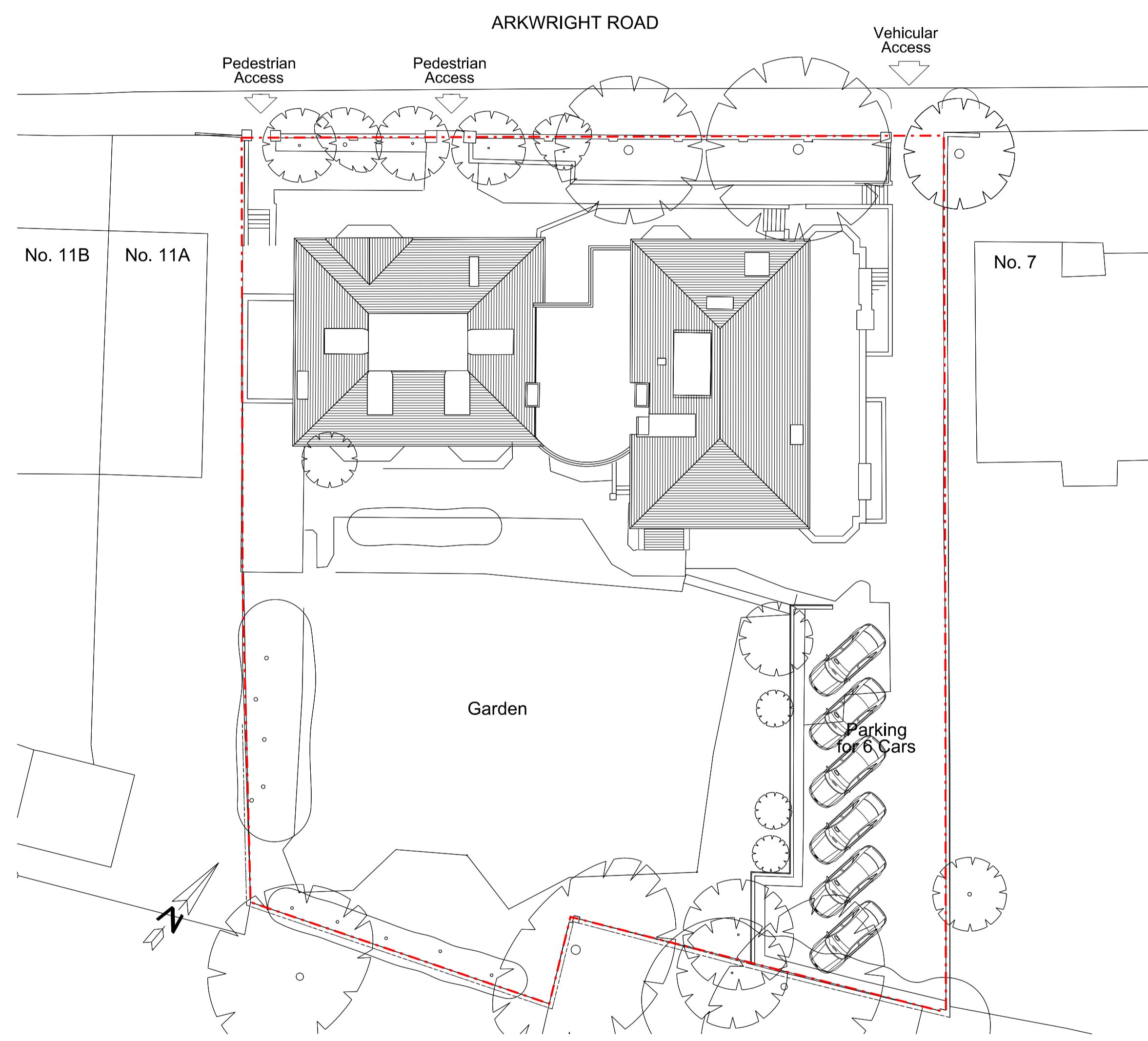
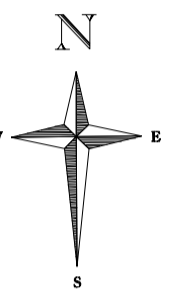

Existing Site/Roof Plan

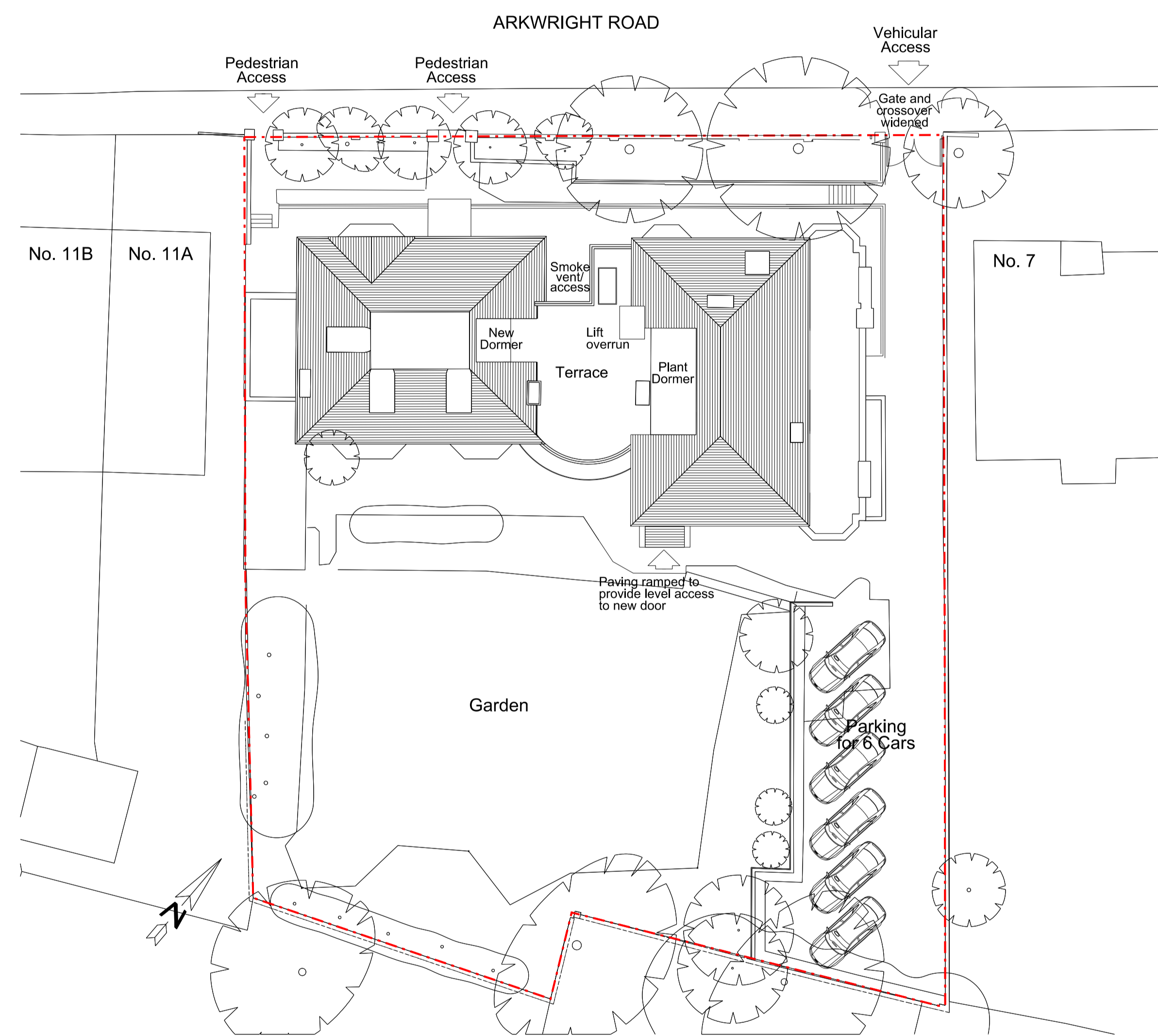

Proposed Site/Roof Plan

Revisions:  
A: (27.10.14) Lightwells and vehicular access amended, Dormer enlarged.  
B: (06.11.14) Roof plan updated.  
C: (19.12.14) Dormers & chimneys amended to Local Authority comments.

Project:  
**Proposed Internal Refurbishment of 9 Arkwright Road, London NW3**

Title: Existing & Proposed Site/Roof Plans & Site Location Plan

Scale: 1:200 & 1:1250 @ A1

Date: March 2014

**Oakley Hough.**

The Barn, Stebbing Farm  
Fishers Green, Stevenage,  
Hertfordshire SG1 2JB

Tel: 01438 745288  
Mobile: 07710 549 270  
e-mail: john@oakleyhough.co.uk

Drawing Number:  
**893/13 C**

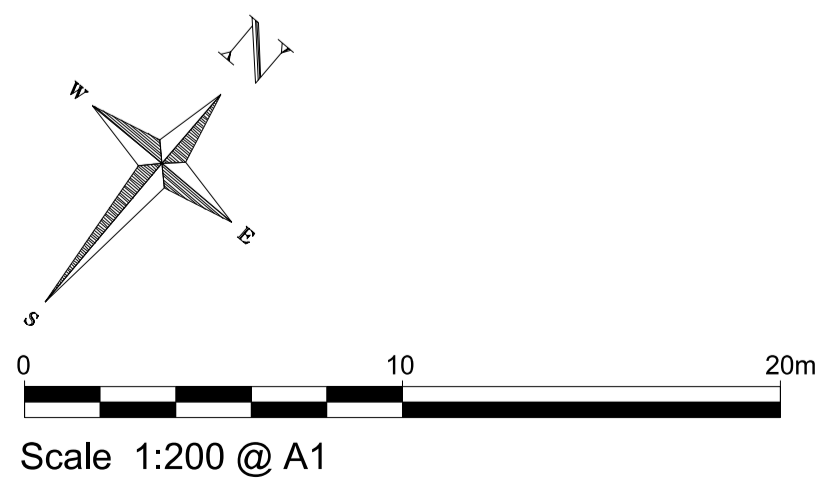

Scale 1:200 @ A1