

Site Boundary

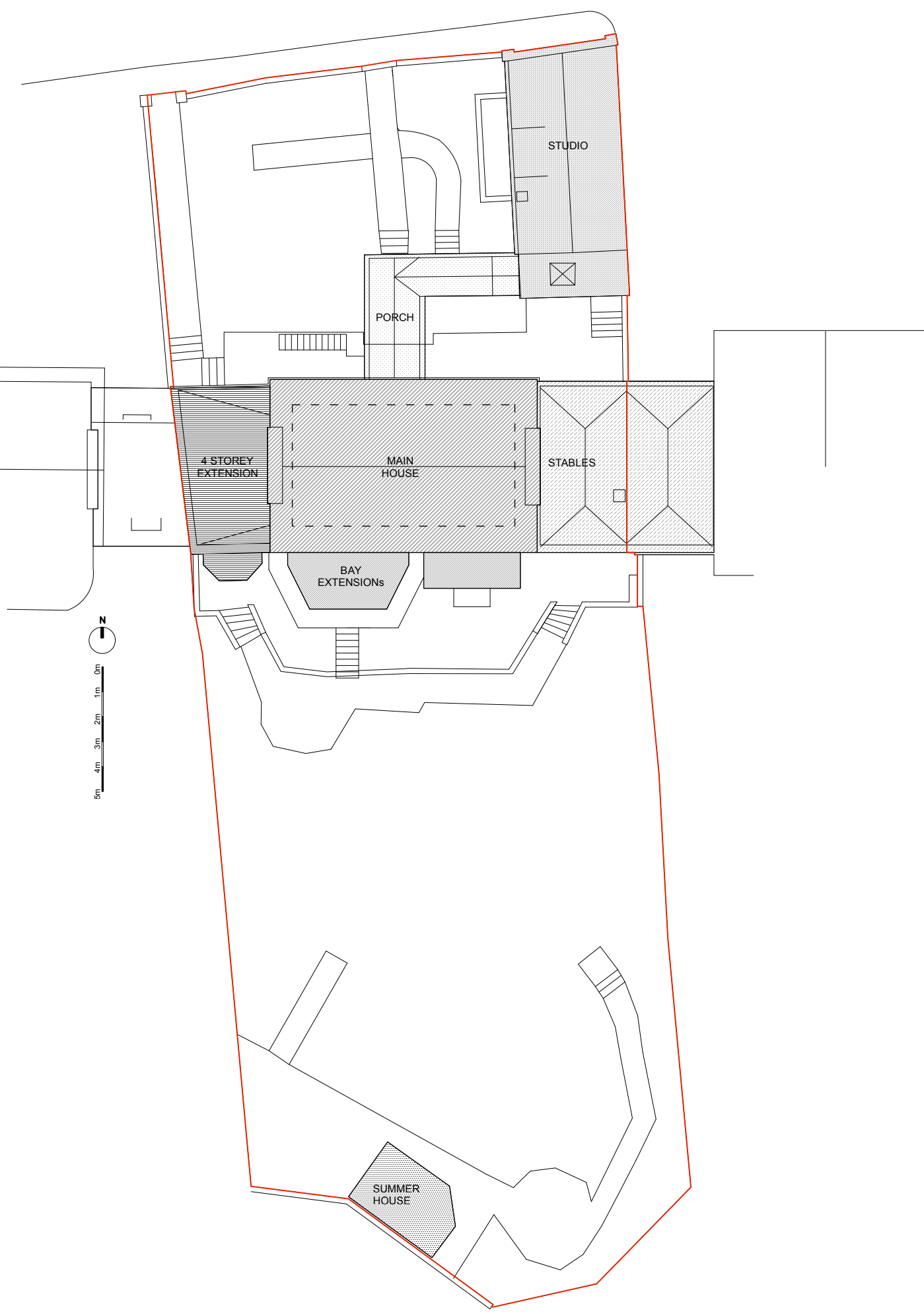

- MAIN HOUSE** **1820s**

The property was first built in the 1820s as a single dwelling with relatively plain front and rear elevations typical of the Regency period.
- BAY EXTENSIONS** **1830s**

Two bay extensions were added to the rear of the property in the 1830s. One rectangular in plan and one comprising of 3 sides and a balcony to the upper ground floor level.
- STABLES** **1800s**

A two storey extension was built concurrently with No.5 Keats Grove to provide stables and storage to the properties.
- 4 STOREY EXTENSION** **Late 1800s**

A four storey extension was added to the west elevation which comprises of basement, ground and two upper floors, with a lean to roof against the gable wall of the original main house.
- STUDIO** **Late 1800s**

Assumed to be originally constructed as a single storey property and of traditional construction with solid brick walls.
- PORCH** **Late 1800s**

This covered walkway was added to connect the studio with the main house. It is formed of timber framing with stained glass panels and a double pitched glass roof.
- SUMMER HOUSE** **2010**

Addition of summer house to rear of property at site boundary.
- MAIN HOUSE ORIGINAL ROOF** **Destroyed 1970s**

A major fire occurred in the 1970s which destroyed the original roof structure. A new timber roof with slate covering was added subsequently.

no.	revision	date
dwg type DIAGRAM		
dwg status PLANNING		
Sacks Maguire Architects 155A Regents Park Road London NW1 8BB Telephone 020 7722 9298 Fax 020 7586 9059		
Project		
4 KEATS GROVE, NW3 2RT		
Title		
Diagram showing Property History and Development		
Client		
Mr. Marcus Piggott		
scale 1:100 @ A1	drawn AD	date Dec 2014
1:200 @ A3		
job number	drawing number	revision
603	700	*