

Copyright of this drawing remains the sole property of the DRAWING ROOM (London & Yorkshire) Ltd unless otherwise agreed in writing. Do not scale from this drawing. Use given dimensions and report any discrepancies prior to commencement of work. This drawing has been prepared based on survey information provided by others and is subject to statutory approvals and design team consultation.

Rev	Date	By
A	20.12.14	KG

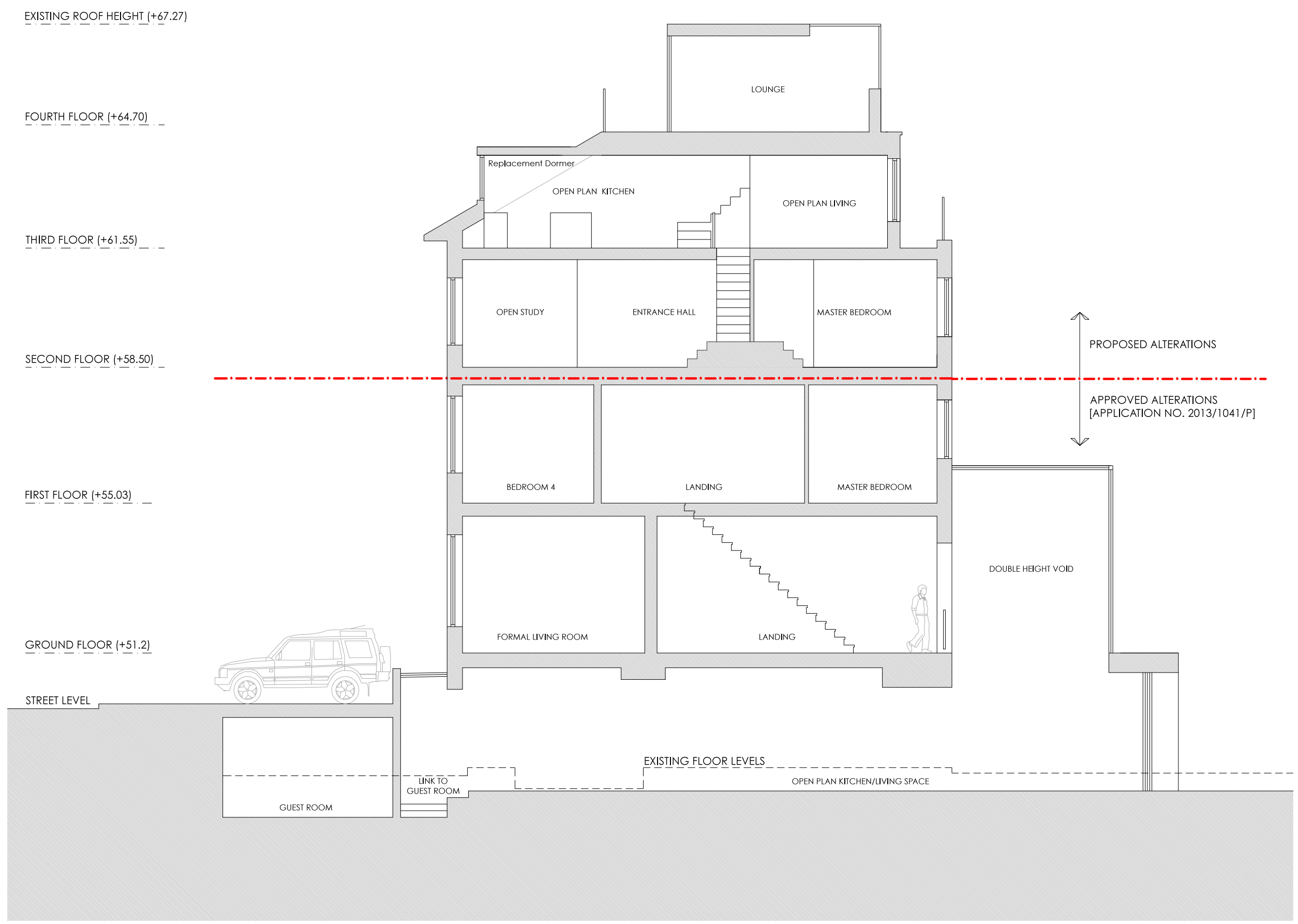

GENERAL ARRANGEMENT - SECTION AA

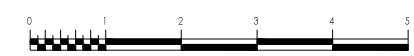

**the DRAWING ROOM**

LONDON...  
67 Clerkenwell Road, London EC1R 5BL  
0208 935 5129

YORKSHIRE...  
The Coach House, West End Road,  
Leeds LS28 5FP

www.thedrawingroom-ltd.com  
info@thedrawingroom-ltd.com

\* architecture, design & GOOD IDEAS

Project: 38 Regents Park Road Primrose Hill, Camden				
Client: Mr S Novick				
Title: <b>PROPOSED SECTION A-A</b>				
Date: 18.12.14	Scale: 1:100	Size: A3	Drawn: KG	Checked: KH
Project No: 2014-003	Dwg No: 111	Rev: A	Status: PLANNING	