

NOTES
DO NOT SCALE FROM THIS DRAWING.
CONTRACTOR TO CHECK ALL DIMENSIONS ON SITE.
ANY DISCREPANCIES TO BE REPORTED TO THE ARCHITECT
IMMEDIATELY.

THE SURVEY INFORMATION CONTAINED IN THIS DRAWING
WAS PROVIDED BY PLOWMAN CRAVEN SURVEY DRAWINGS
DEC 2011 - OCT 2012.

COPYRIGHT RICK MATHER ARCHITECTS LLP ©

AREA KEY	RESIDENTIAL	
	RETAIL	
	PLANT	
	CIRCULATION	
	CAR PARK	
	BACK OF HOUSE	
	OFFICE	
	RESIDENTIAL AMENITY	

KEY	DEMOLITION	
	EXISTING STRUCTURE	
	PARTITION	
	PROPOSED STRUCTURE	

KEY	AFFORDABLE HOUSING USE	
	AFFORDABLE HOUSING CIRCULATION	
	AFFORDABLE 1 BED	
	AFFORDABLE 2 BED	
	AFFORDABLE 3 BED	
	AFFORDABLE 4 BED	

REVISIONS	PL2	15.09.14	NON-MATERIAL AMENDMENTS / LISTED BUILDING
	PL1	01.04.13	PLANNING ISSUE
	REV	DATE	DESCRIPTION

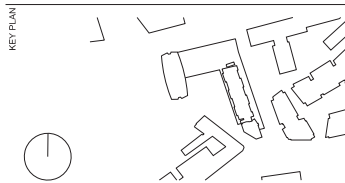

PLANNING

RICK MATHER ARCHITECTS ©			
123 Camden High Street London NW1 7JR T: 020 7284 1727 F: 020 7267 7626 info@rickmather.com www.rickmather.com			
JOB	Centre Point 101-103 New Oxford Street London, WC1A 1DD		APP 1A
TITLE	PROPOSED FLOOR PLAN FIRST FLOOR MEZZANINE AMALGAMATED DRAWINGS		
DRAWN	DMcC	JOB # 552	DRG # 19405-CPA
CHECKED	GM	SCALE 1:250	DATE APR 13
		SIZE A1	REV PL2
		DATE APR 13	REV DATE 15.09.14