



APPENDIX F

A Selection of Historic Maps

Historical Mapping Legends

Ordnance Survey County Series 1:10,560

	Gravel Pit		Sand Pit		Other Pits
	Quarry		Shingle		Orchard
	Osiers		Reeds		Marsh
	Mixed Wood		Deciduous		Brushwood
	Fir		Furze		Rough Pasture
	Arrow denotes flow of water		Trigonometrical Station		
	Site of Antiquities		Bench Mark		
	Pump, Guide Post, Signal Post		Well, Spring, Boundary Post		
	Surface Level				
	Sketched Contour		Instrumental Contour		
	Main Roads		Minor Roads		
	Sunkun Road		Raised Road		
	Road over Railway		Railway over River		
	Railway over Road		Level Crossing		
	Road over River or Canal		Road over Stream		
	Road over Stream				
	County Boundary (Geographical)				
	County & Civil Parish Boundary				
	Administrative County & Civil Parish Boundary				
	County Borough Boundary (England)				
	County Borough Boundary (Scotland)				
	Rural District Boundary				
	Civil Parish Boundary				

Ordnance Survey Plan 1:10,000

	Chalk Pit, Clay Pit or Quarry		Gravel Pit
	Sand Pit		Disused Pit or Quarry
	Refuse or Slag Heap		Lake, Loch or Pond
	Dunes		Boulders
	Coniferous Trees		Non-Coniferous Trees
	Orchard		Scrub
	Coppice		Rough Grassland
	Bracken		Heath
	Marsh		Reeds
	Saltings		
	Building		Glasshouse
	Sloping Masonry		Pylon
	Electricity Transmission Line		Pole
	Cutting		Imbanchment
	Road Under		Road Over
	Level Crossing		Foot Bridge
	Siding, Tramway or Mineral Line		
	Narrow Gauge		
	Geographical County		
	Administrative County, County Borough or County of City		
	Municipal Borough, Urban or Rural District, Borough or District Council		
	Borough, Burgh or County Constituency <small>Shown only when not coincident with other boundaries</small>		
	Civil Parish <small>Shown alternately when coincidence of boundaries occurs</small>		
	Boundary Post or Stone		Police Station
	Church		Post Office
	Club House		Public Convenience
	Fire Engine Station		Public House
	Foot Bridge		Signal Box
	Fountain		Spring
	Guide Post		Telephone Call Box
	Mile Post		Telephone Call Post
	Mile Stone		Well

1:10,000 Raster Mapping

	Gravel Pit		Refuse tip or slag heap
	Rock		Rock (scattered)
	Boulders		Boulders (scattered)
	Shingle		Mud
	Sand		Sand Pit
	Slopes		Top of cliff
	General detail		Underground detail
	Overhead detail		Narrow gauge railway
	Multi-track railway		Single track railway
	County boundary (England only)		Civil, parish or community boundary
	District, Unitary, Metropolitan, London Borough boundary		Constituency boundary
	Area of wooded vegetation		Non-coniferous trees
	Non-coniferous trees (scattered)		Coniferous trees
	Coniferous trees (scattered)		Positioned tree
	Orchard		Coppice or Osiers
	Rough Grassland		Heath
	Scrub		Marsh, Salt Marsh or Reeds
	Water feature		Flow arrows
	Mean high water (springs)		Mean low water (springs)
	Telephone line (where shown)		Electricity transmission line (with poles)
	Bench mark (where shown)		Triangulation station
	Point feature (e.g. Guide Post or Mile Stone)		Pylon, flare stack or lighting tower
	Site of antiquity		Glasshouse
	General Building		Important Building



Historical Mapping & Photography included:

Mapping Type	Scale	Date	Pg
Middlesex	1:10,560	1873 - 1882	3
Middlesex	1:10,560	1879	4
London	1:10,560	1896	5
Essex	1:10,560	1920	6
London	1:10,560	1920	7
Essex	1:10,560	1938	8
London	1:10,560	1938	9
Historical Aerial Photography	1:10,560	1950	10
Ordnance Survey Plan	1:10,000	1951	11
Ordnance Survey Plan	1:10,000	1957 - 1958	12
Ordnance Survey Plan	1:10,000	1968	13
Ordnance Survey Plan	1:10,000	1974 - 1976	14
London	1:25,000	1985	15
Ordnance Survey Plan	1:10,000	1991 - 1996	16
10K Raster Mapping	1:10,000	2006	17
VectorMap Local	1:10,000	2014	18

Historical Map - Slice A

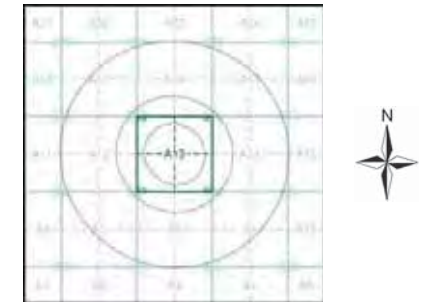

Order Details

Order Number: 59147264_1_1
 Customer Ref: UK14.1639
 National Grid Reference: 527380, 185770
 Slice: A
 Site Area (Ha): 0.05
 Search Buffer (m): 1000

Site Details

15a, Parliament Hill, London, NW3 2SY



Tel: 0844 844 9952
 Fax: 0844 844 9951
 Web: www.envirocheck.co.uk



London

Published 1873 - 1879

Source map scale - 1:2,500

The historical maps shown were reproduced from maps predominantly held at the scale adopted for England, Wales and Scotland in the 1840's. In 1854 the 1:2,500 scale was adopted for mapping urban areas and by 1896 it covered the whole of what were considered to be the cultivated parts of Great Britain. The published date given below is often some years later than the surveyed date. Before 1938, all OS maps were based on the Cassini Projection, with independent surveys of a single county or group of counties, giving rise to significant inaccuracies in outlying areas.

Map Name(s) and Date(s)

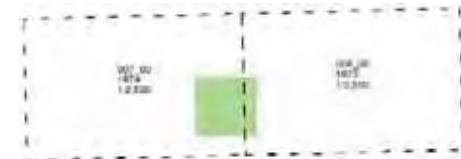

Historical Map - Segment A13

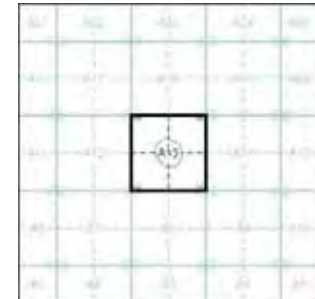

Order Details

Order Number: 59147264_1_1
Customer Ref: UK14.1639
National Grid Reference: 527380, 185770
Slice: A
Site Area (Ha): 0.05
Search Buffer (m): 100

Site Details

15a, Parliament Hill, London, NW3 2SY



Tel: 0844 844 9952
Fax: 0844 844 9951
Web: www.envirocheck.co.uk





Middlesex

Published 1873 - 1882

Source map scale - 1:10,560

The historical maps shown were reproduced from maps predominantly held at the scale adopted for England, Wales and Scotland in the 1840's. In 1854 the 1:2,500 scale was adopted for mapping urban areas; these maps were used to update the 1:10,560 maps. The published date given therefore is often some years later than the surveyed date. Before 1938, all OS maps were based on the Cassini Projection, with independent surveys of a single county or group of counties, giving rise to significant inaccuracies in outlying areas. In the late 1940's, a Provisional Edition was produced, which updated the 1:10,560 mapping from a number of sources. The maps appear unfinished - with all military camps and other strategic sites removed. These maps were initially overprinted with the National Grid. In 1970, the first 1:10,000 maps were produced using the Transverse Mercator Projection. The revision process continued until recently, with new editions appearing every 10 years or so for urban areas.

Map Name(s) and Date(s)

01 100 1873 1:10,560	01 200 1873 1:10,560
01 600 1874 1:10,560	01 700 1882 1:10,560

Historical Map - Slice A

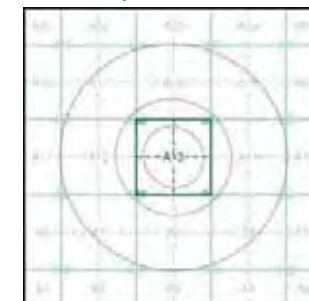

Order Details

Order Number: 59147264_1_1
Customer Ref: UK14.1639
National Grid Reference: 527380, 185770
Slice: A
Site Area (Ha): 0.05
Search Buffer (m): 1000

Site Details

15a, Parliament Hill, London, NW3 2SY



Tel: 0844 844 9952
Fax: 0844 844 9951
Web: www.envirocheck.co.uk



London

Published 1896

Source map scale - 1:10,560

The historical maps shown were reproduced from maps predominantly held at the scale adopted for England, Wales and Scotland in the 1840's. In 1854 the 1:2,500 scale was adopted for mapping urban areas; these maps were used to update the 1:10,560 maps. The published date given therefore is often some years later than the surveyed date. Before 1938, all OS maps were based on the Cassini Projection, with independent surveys of a single county or group of counties, giving rise to significant inaccuracies in outlying areas. In the late 1940's, a Provisional Edition was produced, which updated the 1:10,560 mapping from a number of sources. The maps appear unfinished - with all military camps and other strategic sites removed. These maps were initially overprinted with the National Grid. In 1970, the first 1:10,000 maps were produced using the Transverse Mercator Projection. The revision process continued until recently, with new editions appearing every 10 years or so for urban areas.

Map Name(s) and Date(s)



Historical Map - Slice A



Order Details

Order Number: 59147264_1_1
Customer Ref: UK14.1639
National Grid Reference: 527380, 185770
Slice: A
Site Area (Ha): 0.05
Search Buffer (m): 1000

Site Details

15a, Parliament Hill, London, NW3 2SY



Tel: 0844 844 9952
Fax: 0844 844 9951
Web: www.envirocheck.co.uk



London

Published 1896

Source map scale - 1:2,500

The historical maps shown were reproduced from maps predominantly held at the scale adopted for England, Wales and Scotland in the 1840's. In 1854 the 1:2,500 scale was adopted for mapping urban areas and by 1896 it covered the whole of what were considered to be the cultivated parts of Great Britain. The published date given below is often some years later than the surveyed date. Before 1938, all OS maps were based on the Cassini Projection, with independent surveys of a single county or group of counties, giving rise to significant inaccuracies in outlying areas.

Map Name(s) and Date(s)

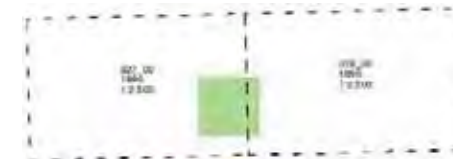

Historical Map - Segment A13

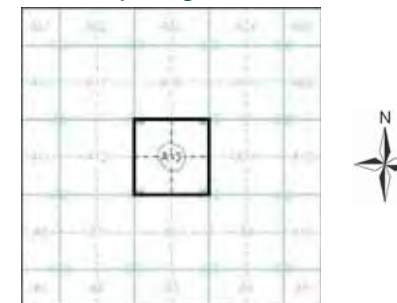

Order Details

Order Number: 59147264_1_1
Customer Ref: UK14.1639
National Grid Reference: 527380, 185770
Slice: A
Site Area (Ha): 0.05
Search Buffer (m): 100

Site Details

15a, Parliament Hill, London, NW3 2SY



Tel: 0844 844 9952
Fax: 0844 844 9951
Web: www.envirocheck.co.uk

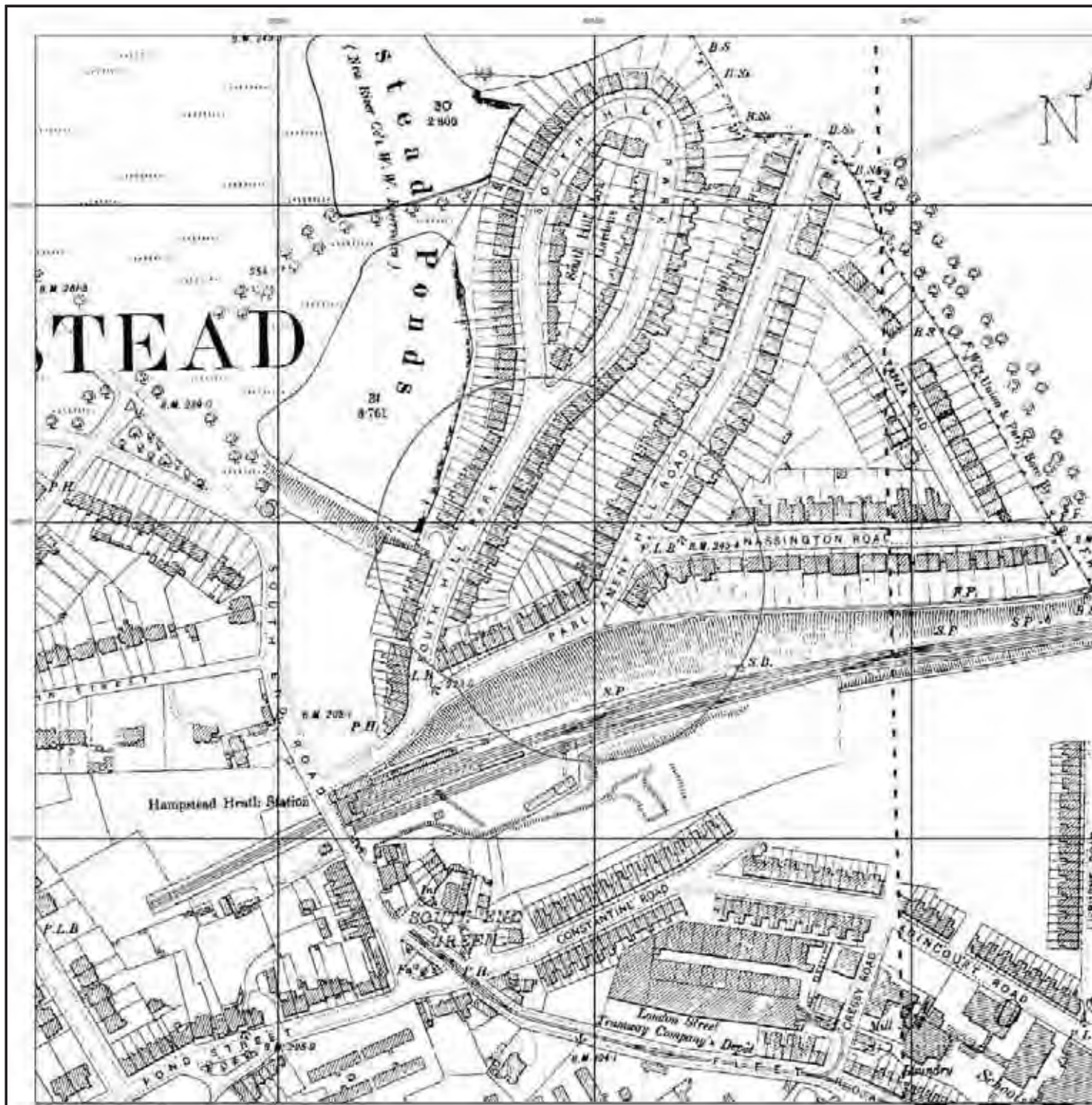



London

Published 1934 - 1936

Source map scale - 1:2,500

The historical maps shown were reproduced from maps predominantly held at the scale adopted for England, Wales and Scotland in the 1840's. In 1854 the 1:2,500 scale was adopted for mapping urban areas and by 1896 it covered the whole of what were considered to be the cultivated parts of Great Britain. The published date given below is often some years later than the surveyed date. Before 1938, all OS maps were based on the Cassini Projection, with independent surveys of a single county or group of counties, giving rise to significant inaccuracies in outlying areas.

Map Name(s) and Date(s)



Historical Map - Segment A13

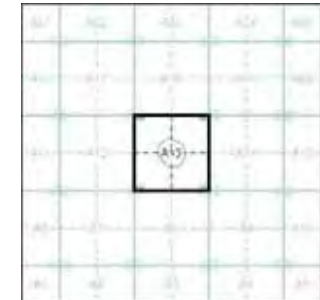

Order Details

Order Number: 59147264_1_1
Customer Ref: UK14.1639
National Grid Reference: 527380, 185770
Slice: A
Site Area (Ha): 0.05
Search Buffer (m): 100

Site Details

15a, Parliament Hill, London, NW3 2SY



Tel: 0844 844 9952
Fax: 0844 844 9951
Web: www.envirocheck.co.uk